

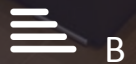

The Nova Building

79 Buckingham Palace Road, Westminster, SW1W 0AJ

£1,550 Per Week



Floor Plan

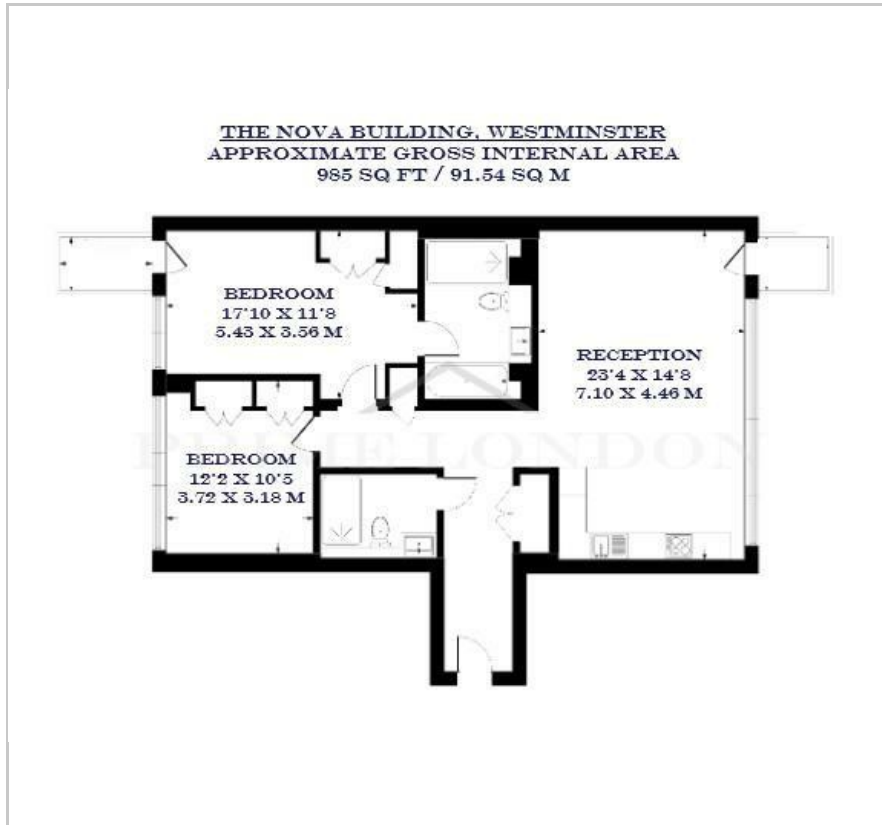

Area Map



Energy Efficiency Graph

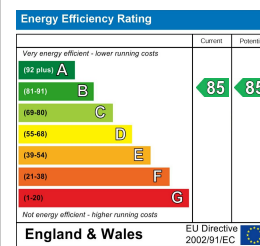

Viewing

By appointment. Contact us on 0207 052 1075 if you wish to arrange a viewing appointment for this property, or require further information.

- Two bedroom apartment in the heart of Westminster
- Two balconies on each side
- Two bathrooms, one en-suite of property
- Residents' gym, meeting room, cinema and rooftop terrace
- 24 hour concierge

This beautiful two bedroom apartment, in the centrally located Nova Building development, is available for lease through Prime London.

Totalling 985 sq ft (91.54 sqm), the property comprises an open plan reception area with a fully fitted kitchen, two double bedrooms with fitted wardrobes, and two bathrooms (one being an en-suite). Additionally, there are two balconies facing either side of the property, one that can be accessed from the living room and one from the master bedroom.

Residents of Nova Building also benefit from various facilities, such as a gym, residents' lounge, roof terrace, cinema room, and meeting rooms. This also includes a 24/7 concierge service.

The Nova Building's prime location is nearby to some of London's most iconic landmarks, including Buckingham Palace, Westminster Cathedral, and the Houses of Parliament. Residents can also enjoy the nearby green spaces, with St James's Park just a short distance away.

Convenient access to transportation is provided by the Circle & District Lines, Victoria Line, and mainline rail services at Victoria station, all within approximately 0.1 miles.

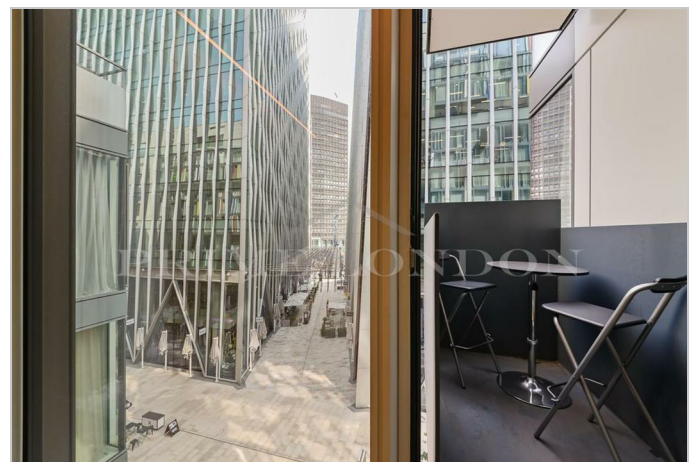

These particulars, whilst believed to be accurate are set out as a general outline only for guidance and do not constitute any part of an offer or contract. Intending purchasers should not rely on them as statements of representation of fact, but must satisfy themselves by inspection or otherwise as to their accuracy. No person in this firm's employment has the authority to make or give any representation or warranty in respect of the property.