



9 Millbank

Millbank Quarter, Westminster, SW1P 3AN

Asking Price £2,400,000



Floor Plan

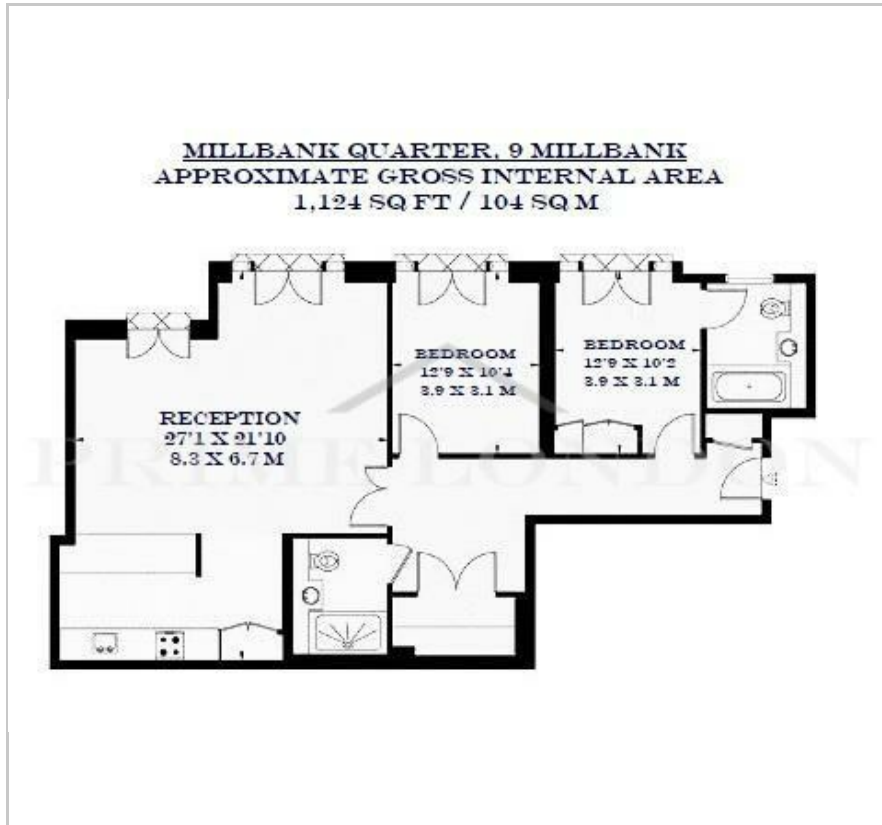

Area Map



Energy Efficiency Graph

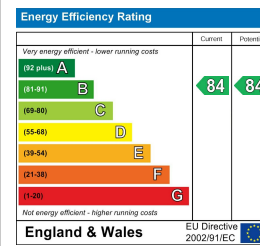

Viewing

By appointment. Contact us on 0207 052 1075 if you wish to arrange a viewing appointment for this property, or require further information.

- Large two bedroom apartment ▪ 1,124 sq. ft (104 sqm)
- Elegant finishes throughout ▪ Private cinema screening room, and meeting rooms
- State-of-the-art gym, ▪ 24-hour concierge
luxurious pool with spa and treatment room



This brand new, 1,124 sq ft / 104 sqm two bedroom apartment, set in the quietest position within the most popular local development, 9 Millbank, is available for a chain free sale through Prime London.

Set facing the tranquil landscaped gardens, this is the ideal two bedroom apartment within the development as you benefit from a very large living space and views of the gardens. The spacious reception room benefits from the heritage of the building, but with the high of modern elegance, and the open plan kitchen with Küppersbusch appliances and expertly crafted finishes complete the space.

The two double bedrooms also enjoy views over the peaceful, private landscaped garden. The main bedroom has an excellent walk in wardrobe, and both bedrooms are finished in a warm neutral palette to create a calm retreat where you can relax and rejuvenate.

The property also benefits from having two bathrooms (one of which is a 5 piece en-suite), and a large utility space. For residents' comfort, all properties in 9 Millbank have underfloor heating throughout, and comfort cooling to all reception rooms and bedrooms.

Leisure facilities exclusive to the residents at 9 Millbank include a 24-hour concierge, a state-of-the-art gym, luxurious swimming pool with spa and treatment room, private cinema screening room, meeting rooms, and landscaped gardens. Standing proudly on the banks of the river Thames, in the beating heart of historic Westminster, 9 Millbank encapsulates British luxury and style. Now a Grade II listed building, Millbank Residences' grandeur still stands tall in Westminster's iconic skyline.



These particulars, whilst believed to be accurate are set out as a general outline only for guidance and do not constitute any part of an offer or contract. Intending purchasers should not rely on them as statements of representation of fact, but must satisfy themselves by inspection or otherwise as to their accuracy. No person in this firm's employment has the authority to make or give any representation or warranty in respect of the property.

21 Grosvenor Gardens, Belgravia, London SW1W 0BP | Palace View, 131 Lambeth Road, London SE1 7BT

Tel: 0207 052 1075 | 0207 928 6663 Email: Office@PrimeLondonResidential.com www.PrimeLondonResidential.com