



Hartley Dene Ashford Road, Harrietsham, Maidstone, ME17 1BL  
£2,500 Per Month



This spacious 4-bedroom property with space for a fifth bedroom is ideal for those seeking plenty of living space and outdoor freedom. With a large garden and ample parking available. The home features a bright and airy layout, with five well-sized bedrooms.

This property is located near the M20 for easy travel to London or the coast.

Key Features:

4/5 Bedrooms

1 Bathroom



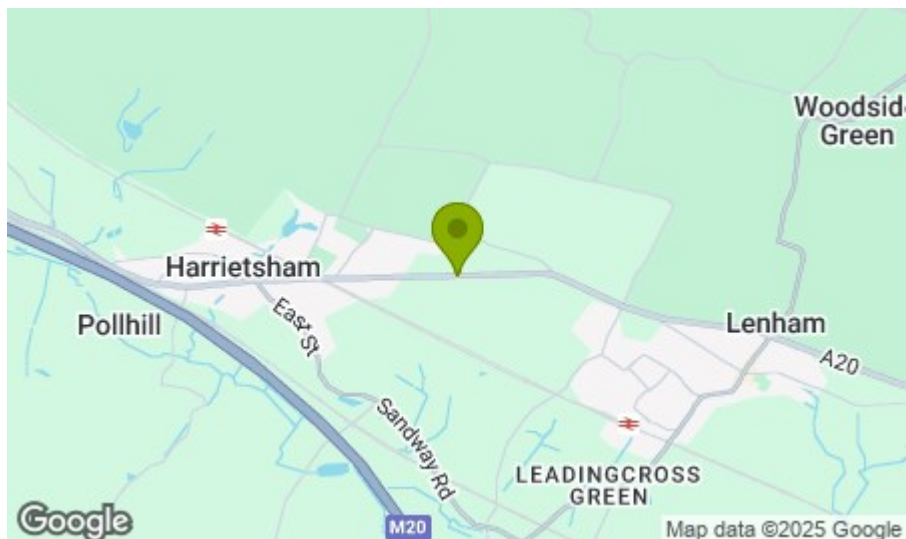
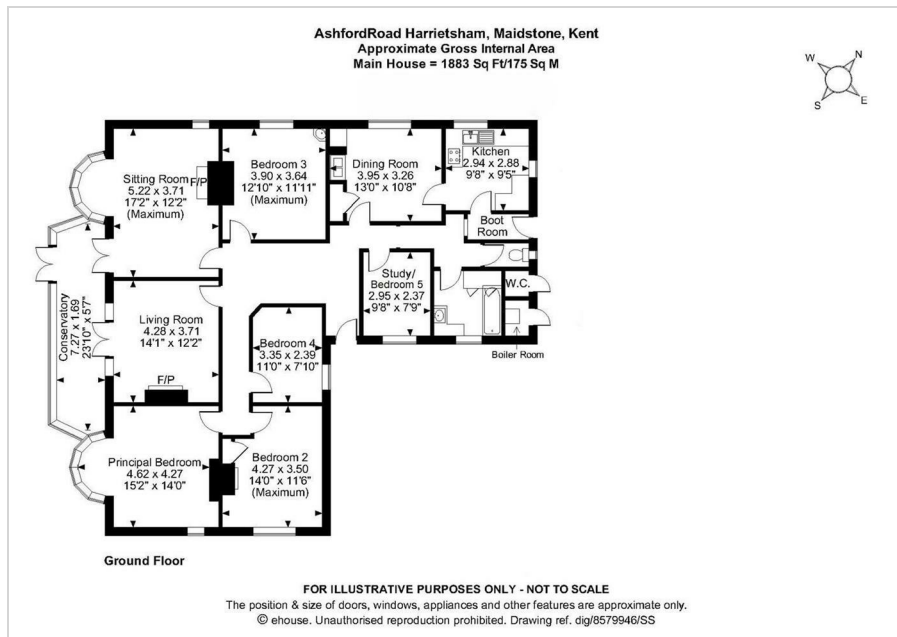

## Viewing

Strictly by arrangement with the Agent's Coxheath Office:  
1 Hamilton House, Heath Road, Maidstone, Kent, ME17 4DF  
T: 01622 620260

Energy Efficiency Rating		
	Current	Potential
Very energy efficient - lower running costs		
(92 plus) A		93
(81-91) B		
(69-80) C		67
(55-68) D		
(39-54) E		
(21-38) F		
(1-20) G		
Not energy efficient - higher running costs		
England & Wales		EU Directive 2002/91/EC

Page & Wells limited for themselves and for the vendors of this property whose agents they are give notice that: 1. These particulars do not constitute any part of, an offer or a contract. 2. All statements contained in these particulars as to this property are made without responsibility on the part of Page & Wells Limited or the Vendor. 3. None of the statements contained in these particulars as to the property is to be relied on as statements or representations of fact. 4. Any intending purchaser must satisfy himself by inspection or otherwise as to the correctness of each of the statements contained in these particulars. 5. The vendor does not make or give, and neither Page & Wells Limited nor any person in their employment has any authority to make or give any representation whatsoever in relation to this property. These particulars are supplied on the understanding that all negotiations are carried out throughout Page & Wells Limited. Properties with a reference prefixes EAA are those which Page & Wells Limited disclose an interest in accordance with the provisions of the Estates Agents Act 1979



Coxheath Office, 1 Hamilton House, Heath Road, Maidstone, Kent, ME17 4DF  
T: 01622 620260  
E: [lettings@page-wells.co.uk](mailto:lettings@page-wells.co.uk)  
[page-wells.co.uk](http://page-wells.co.uk)