



24 Bow Terrace, Watlingbury, Maidstone, ME18 5DW
Per Calendar Month £1,250 Per Calendar Month



Welcome to Bow Terrace in the charming village of Watlington, Maidstone! This delightful two-bedroom end of terrace house is a perfect blend of comfort and style.

As you step inside, you'll be greeted by a warm and inviting atmosphere, ideal for creating lasting memories with your loved ones. The property boasts two cosy bedrooms, offering plenty of space for relaxation and personalisation.

One of the highlights of this lovely home is the good-sized garden, a tranquil oasis where you can unwind after a long day or entertain guests on a sunny afternoon. Imagine enjoying a cup of tea surrounded by beautiful greenery and the sweet sounds of nature.

Located in the picturesque village of Watlington, you'll have the best of both worlds - a peaceful retreat away from the hustle and bustle of the city, yet still within easy reach of all amenities. Whether you fancy a leisurely stroll along the river or a quick trip to the local shops, everything you need is just a stone's throw away.

Don't miss this wonderful opportunity to make Bow Terrace your new home sweet home. Book a viewing today and start envisioning the life you could lead in this charming property.



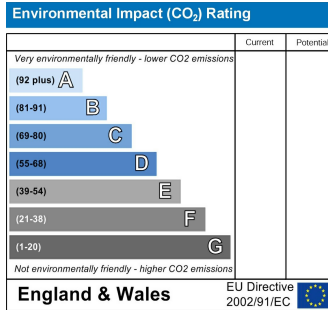
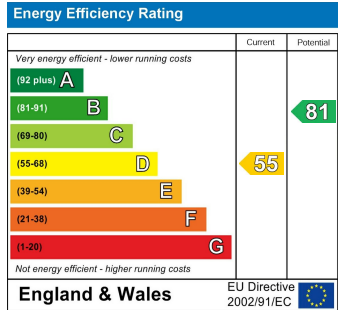

Page & Wells limited for themselves and for the vendors of this property whose agents they are give notice that: 1. These particulars do not constitute any part of, an offer or a contract. 2. All statements contained in these particulars as to this property are made without responsibility on the part of Page & Wells Limited or the Vendor. 3. None of the statements contained in these particulars as to the property is to be relied on as statements or representations of fact. 4. Any intending purchaser must satisfy himself by inspection or otherwise as to the correctness of each of the statements contained in these particulars. 5. The vendor does not make or give, and neither Page & Wells Limited nor any person in their employment has any authority to make or give any representation whatsoever in relation to this property. These particulars are supplied on the understanding that all negotiations are carried out throughout Page & Wells Limited. Properties with a reference prefixes EAA are those which Page & Wells Limited disclose an interest in accordance with the provisions of the Estates Agents Act 1979



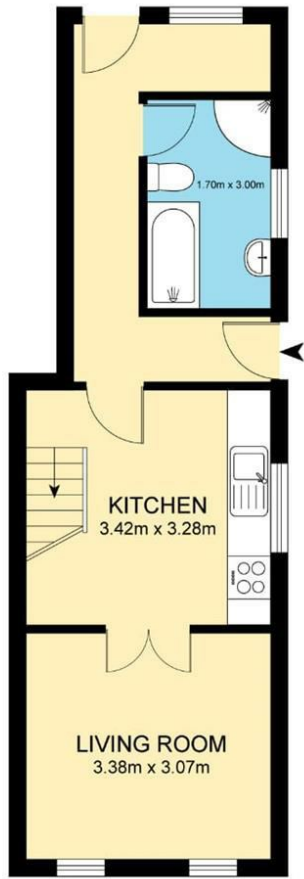

GROUND FLOOR

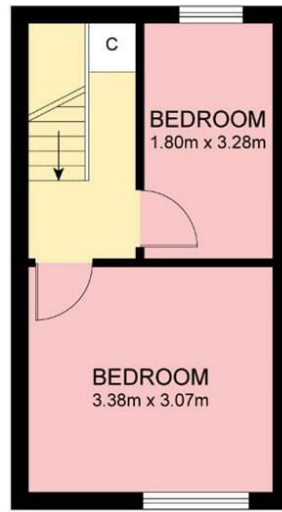

FIRST FLOOR

