

Flat 1, 19 Leicester Street, Melton Mowbray, LE13 0PP
£700 Per month
Council Tax Band: A

H&H
BESPOKE



Nestled in the charming town of Melton Mowbray, this delightful flat on Leicester Street offers a perfect blend of comfort and convenience. With a well-thought-out layout spanning 484 square feet, this ONE-bedroom property is ideal for individuals or couples seeking a cosy home in a vibrant community.

Upon entering, you will find a welcoming atmosphere that invites you to relax and unwind. The flat features a spacious bedrooms, providing ample room for rest and personal space. The bathroom is well-appointed, ensuring that your daily routines are both comfortable and efficient.

The location on Leicester Street places you within easy reach of local amenities, including shops, cafes, and parks, making it a fantastic choice for those who appreciate the convenience of urban living while still enjoying the charm of a market town. Melton Mowbray is renowned for its rich culinary heritage, particularly its famous pork pies, and offers a variety of cultural and recreational activities.

This flat presents an excellent opportunity for first-time buyers or those looking to downsize without compromising on quality of life. With its appealing features and prime location, this property is sure to attract interest. Do not miss the chance to make this lovely flat your new home in Melton Mowbray.



13 Sherrard Street, Melton Mowbray, Leicestershire, LE13 1XH
 0333 242 3760
 Beth@houseandhomebespoke.co.uk

Leicester Street, LE13

Flat 1 Area = 457 sq ft / 42.5 sq m
 Flat 2 Area = 463 sq ft / 43 sq m
 Total = 920 sq ft / 85.5 sq m

For identification only - Not to scale

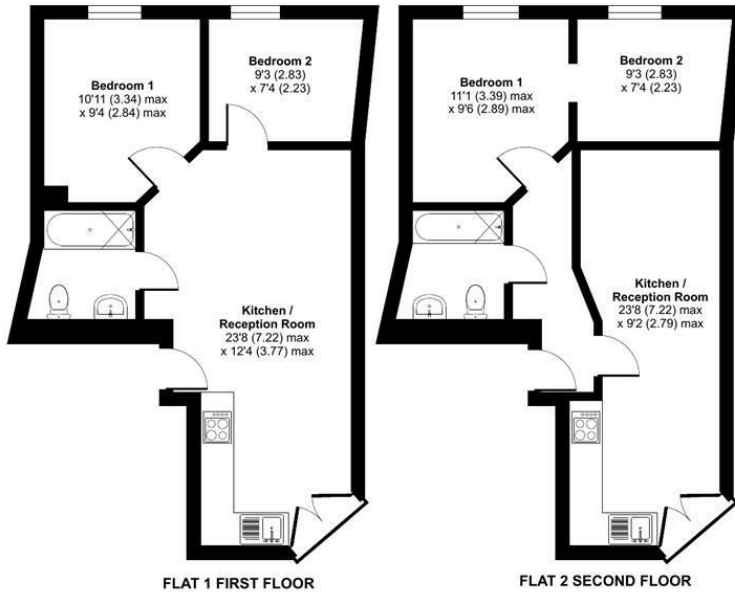

Energy Efficiency Rating		Current	Potential
Very energy efficient - lower running costs			
(92 plus) A			
(81-91) B			
(69-80) C			
(55-68) D			
(39-54) E			
(21-38) F			
(1-20) G			
Not energy efficient - higher running costs			
England & Wales		EU Directive 2002/91/EC	

