



Rowe  
& Co.

79 Brownhill Road, Chandler's Ford

Eastleigh

£675,000



**Rowe  
& Co.**



## 79 Brownhill Road

Chandler's Ford, Eastleigh

Offered With no forward chain is this imposing four-bedroom detached family home set on an established plot of approx. 0.2 of an Acre. The property has been tastefully finished and benefits a large frontage proving ample off-road parking and a garage. The ground floor accommodation comprises an entrance hall, lounge, utility cupboard, cloakroom, 20ft kitchen / dining room and a conservatory. On the first floor are four well-proportioned bedrooms and a modern family bathroom.

Council Tax band: E

Tenure: Freehold

EPC Energy Efficiency Rating: C

EPC Environmental Impact Rating: D

- No Forward Chain
- Approx 0.2 of An Acre
- Large Driveway & Garage
- Four Bedrooms
- 20 Ft kitchen / Dining Room
- Modern Shower Room
- Scope To Further Improve / Extend (Subject To Relevant Planning)

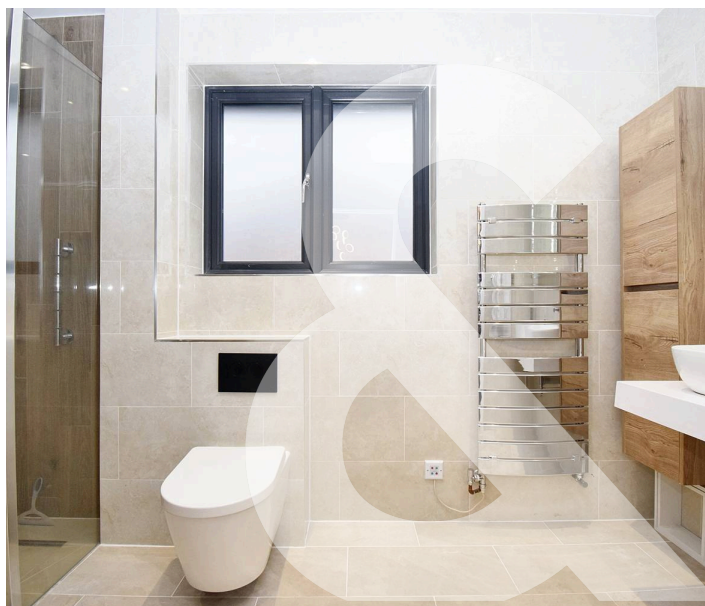



# 79 Brownhill Road

Chandler's Ford, Eastleigh

Offered With no forward chain is this imposing four-bedroom detached family home set on an established plot of approx. 0.2 of an Acre. The property has been tastefully finished and benefits a large frontage proving ample off-road parking and a garage. The ground floor accommodation comprises an entrance hall, lounge, utility cupboard, cloakroom, 20ft kitchen / dining room and a conservatory. On the first floor are four well-proportioned bedrooms and a modern family bathroom. Council Tax band: E

Tenure: Freehold

EPC Energy Efficiency Rating: C

EPC Environmental Impact Rating: D

- No Forward Chain
- Approx 0.2 of An Acre
- Large Driveway & Garage
- Four Bedrooms
- 20 Ft kitchen / Dining Room
- Modern Shower Room
- Scope To Further Improve / Extend (Subject To Relevant Planning)





GROUND FLOOR

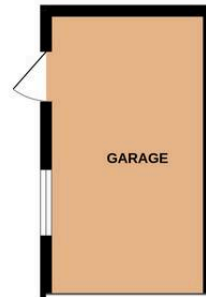

1ST FLOOR

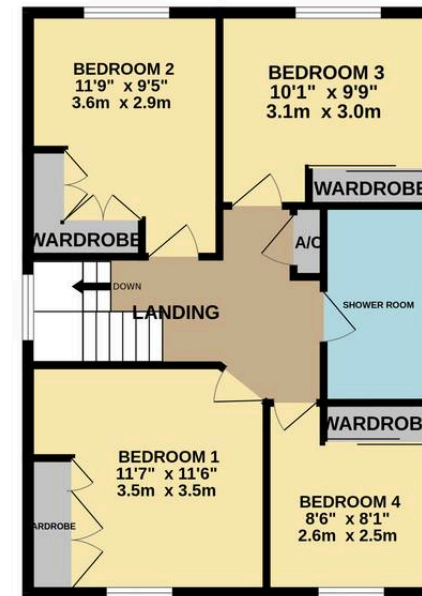

1 Rufus Court, 103 Winchester Road  
Chandlers Ford,  
SO53 2GG



02381 102221



chandlersford@rowehomes.co.uk

**REQUEST  
VIEWING**

(GOTTA BE QUICK!)

Whilst every attempt has been made to ensure the accuracy of the floorplan contained here, measurements of doors, windows, rooms and any other items are approximate and no responsibility is taken for any error, omission or mis-statement. This plan is for illustrative purposes only and should be used as such by any prospective purchaser. The services, systems and appliances shown have not been tested and no guarantee as to their operability or efficiency can be given.  
Made with Metropix ©2025

