



**Rowe
& Co.**

7 Upton Crescent, Nursling

Southampton

In Excess of **£585,000**

Rowe
& Co.



7 Upton Crescent

Nursling, Southampton

This incredible three-bedroom detached bungalow has been thoughtfully extended and fully renovated by the current owners. Sitting on a large plot this property has been finished to an exceptional standard. Accommodation comprises a spacious entrance hall, 32ft kitchen / dining / sitting room, family bathroom and three double bedrooms with en-suite to master. Outside benefits a large driveway accommodating parking for multiple vehicles, fully insulated outbuilding with power and lighting and a secluded mature rear garden. LOCATION Nursling and Rownhams are sought-after residential areas perfectly positioned between the thriving city of Southampton and the market abbey town of Romsey. Comprising some 2,300 properties the traditional houses found in the original villages have been supplemented by a wide range of modern property styles to suit every buyer's needs and a monthly magazine keeps residents informed of neighbourhood news and events. Romsey Golf Club is situated nearby, an oasis of woodlands and beauty on the edge of Southampton, together with Nightingale Wood, a community woodland that supports a large variety of wildlife, especially birds. There are three easy access trails for peaceful outdoor walks.

Council Tax band: D

Tenure: Freehold

EPC Energy Efficiency Rating: D

EPC Environmental Impact Rating: D

- Stunning Detached Bungalow
- Three Double Bedrooms
- En-Suite To Master
- Newly Extended & Renovated
- Incredible 32ft Kitchen / Dining / Sitting Room



7 Upton Crescent

Nursling, Southampton

This incredible three-bedroom detached bungalow has been thoughtfully extended and fully renovated by the current owners. Sitting on a large plot this property has been finished to an exceptional standard. Accommodation comprises a spacious entrance hall, 32ft kitchen / dining / sitting room, family bathroom and three double bedrooms with en-suite to master. Outside benefits a large driveway accommodating parking for multiple vehicles, fully insulated outbuilding with power and lighting and a secluded mature rear garden. LOCATION Nursling and Rownhams are sought-after residential areas perfectly positioned between the thriving city of Southampton and the market abbey town of Romsey. Comprising some 2,300 properties the traditional houses found in the original villages have been supplemented by a wide range of modern property styles to suit every buyer's needs and a monthly magazine keeps residents informed of neighbourhood news and events. Romsey Golf Club is situated nearby, an oasis of woodlands and beauty on the edge of Southampton, together with Nightingale Wood, a community woodland that supports a large variety of wildlife, especially birds. There are three easy access trails for peaceful outdoor walks. Council Tax band: D

Tenure: Freehold

EPC Energy Efficiency Rating: D

EPC Environmental Impact Rating: D

- Stunning Detached Bungalow
- Three Double Bedrooms
- En-Suite To Master
- Newly Extended & Renovated
- Incredible 32ft Kitchen / Dining / Sitting Room
- Secluded Garden With Raised Decking
- Driveway
- High Quality Finishings



GROUND FLOOR

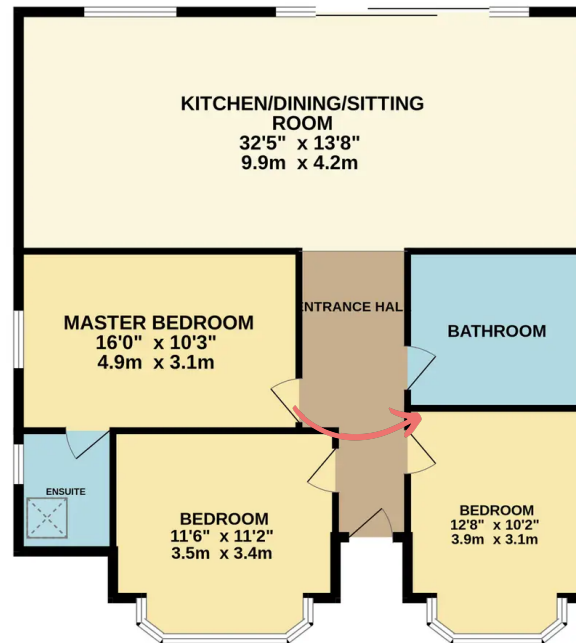
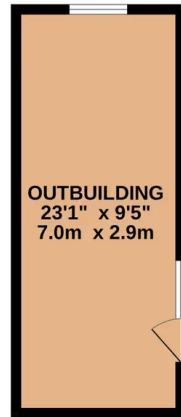

**REQUEST
VIEWING**



Whilst every attempt has been made to ensure the accuracy of the floorplan contained here, measurement of doors, windows, rooms and any other items are approximate and no responsibility is taken for any error, omission or mis-statement. This plan is for illustrative purposes only and should be used as such by any prospective purchaser. The services, systems and appliances shown have not been tested and no guarantee as to their operability or efficiency can be given.
Made with Metropix ©2024

(GOTTA BE QUICK!)