



Pearl & Chance

Bridge Road, London, NW10

£420,000

## Bridge Road, London, NW10

Chain Free! This 2-bedroom ground floor maisonette offers a spacious layout and desirable features in a popular residential Road. The property features two large double bedrooms and ample living space. The highlight of this home is its extensive South East facing garden, complemented by an adaptable outbuilding that can serve multiple purposes, from storage to a personal workspace or home office. The location offers excellent transport links to major roads such as the a406, M1 and is equidistant from Neasden and Harlesden tube stations, streamlining your commute. Nearby sought-after schools and the desirable Roundwood Park, make it a smart pick for young families. Additionally, the benefit of a long lease and low outgoings, makes this an attractive option and represents a solid investment for first-time buyers or property investors.

- Chain Free
- Long Lease
- Two Double Bedrooms
- Private Rear Garden
- Low Outgoings
- Excellent Transport Links
- Close to Popular Schools
- Easy Access to Major Roads
- Multi Purpose Outbuilding





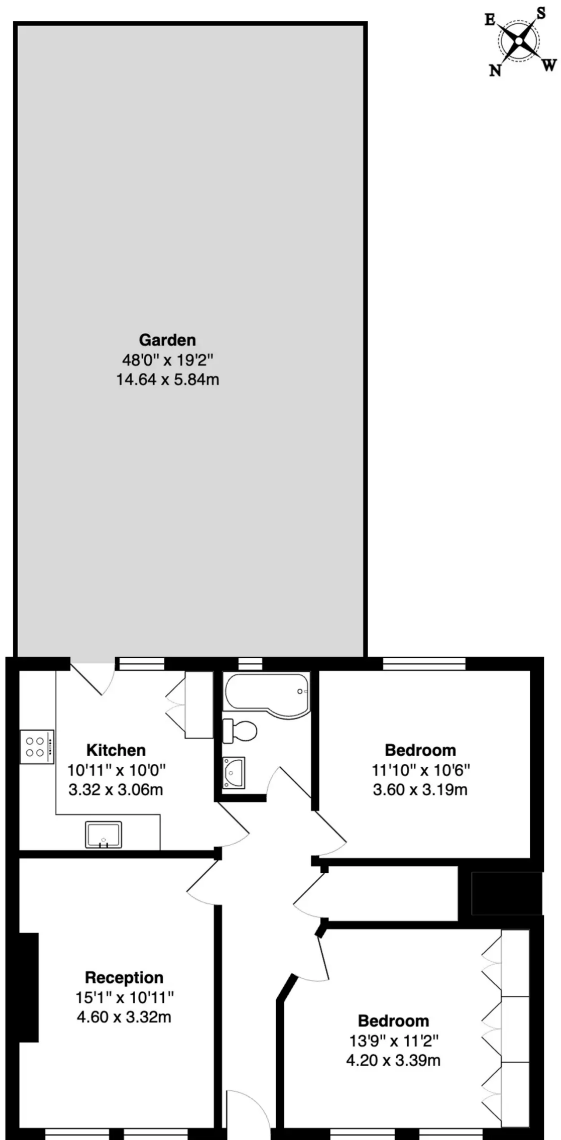

## Energy Efficiency Rating

	Current	Potential
<i>Very energy efficient - lower running costs</i>		
(92+) <b>A</b>		
(81-91) <b>B</b>		
(69-80) <b>C</b>	69	77
(55-68) <b>D</b>		
(39-54) <b>E</b>		
(21-38) <b>F</b>		
(1-20) <b>G</b>		
<i>Not energy efficient - higher running costs</i>		
<b>England, Scotland &amp; Wales</b>	EU Directive 2002/91/EC 	

Bridge Road, London, NW10

Total Gross Area: 716 ft<sup>2</sup> ... 66.5 m<sup>2</sup> (excluding garden)

All measurements are approximate and for identification guideline purposes only, not to scale.  
Compliant with the RICS code of measuring practice



## Pearl & Chance

136-144 Golders Green Road, London - NW11 8HB

0208 059 5559

[info@pearlandchance.co.uk](mailto:info@pearlandchance.co.uk)

<http://pearlandchance.co.uk>

IMPORTANT: These sales particulars have been prepared as a general guide only. A detailed survey has not been carried out, nor the services, appliances and fittings tested. Room sizes should not be relied upon for furnishing purposes and are approximate. If floor plans are included, they are for guidance only and illustration purposes only and may not be to scale. If there are any important matters likely to affect your decision to buy, please contact us before viewing the property.