

STONE



Reigate Road RH2

£325,000

*“At Stone, we’re passionate about
the unique and awe-inspiring
architectural elements that transform
houses into dream homes.”*

The Stone Family



Perched on the second floor of a striking detached Victorian conversion, this beautifully presented two-bedroom apartment on Reigate Road offers a blend of period charm and modern convenience.

Set within an attractive red-brick building with character windows, the apartment maximises its elevated position with breathtaking views of Reigate Hill. The spacious principal bedroom is a true highlight, featuring an expansive picture window that frames the verdant surroundings, complemented by a Velux window that floods the space with natural light. The second bedroom, currently used as a dedicated office, offers flexibility for guests or additional living space. A generous reception room, complete with beautiful wood floors and a feature wall, provides access to eaves storage, ensuring both style and practicality.

The kitchen, designed with a monochrome aesthetic and metro tiles, adjoins a charming dining area, creating a sociable space for entertaining. A bright and neutral bathroom enhances the sense of tranquillity, while ample eaves storage ensures the apartment remains both stylish and functional. Residents also benefit from a delightful communal garden, perfect for enjoying the outdoors. With a share of the freehold, this characterful home is an ideal opportunity for those seeking a refined yet comfortable residence in the heart of Reigate.









Situated on Reigate Road, the apartment is ideally placed for enjoying all the town has to offer. Nestled adjacent to the picturesque St Mary's Church pocket, it provides a tranquil setting just moments from the bustling town centre.

Reigate's historic High Street is within walking distance, offering an array of independent boutiques, restaurants, and cafes, alongside well-known brands. Priory Park, with its stunning landscaped grounds, lake, and café, provides a beautiful green space for recreation and relaxation.

The property is also a short walk to Reigate train station, offering swift connections to London and beyond. With excellent road links, including easy access to the M25, this location seamlessly combines heritage, convenience, and connectivity.







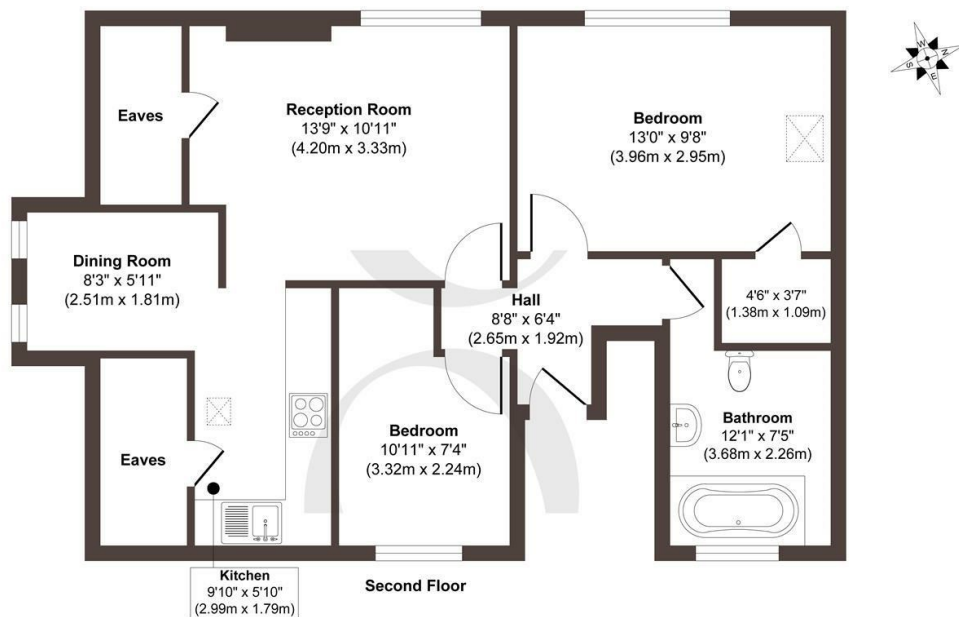

Approx. Gross Internal Floor Area 666 sq. ft / 61.94 sq. m

Illustration for identification purposes only, measurements are approximate, not to scale.

Produced by Elements Property

STONE

The Details

- Spacious two bedroom conversion apartment situated in the heart of Reigate
- Beautiful detached Victorian building
- Views across to Reigate Hill
- Spacious reception room and separate kitchen with adjoining dining area
- Within walking distance of Reigate's historic high street and Reigate train station
- Share of freehold
- Service charge: £100 per month
- Lease details to be confirmed

Size
Approx 666.00 sq ft

Energy Performance Certificate (EPC)
Rating D

Council Tax Band
C



STONE

Let's *Talk*

01737 301 557

hello@stoneestateagents.co.uk

stoneestateagents.co.uk

The particulars above are a guide, not an offer or contract. Descriptions photographs and plans are not statements or representations of fact. Measurements are approximate and not to scale. Prospective purchasers must verify the accuracy of the information within the particulars. Stone does not give any representations or warranties; nor represent the Seller legally. Stone has no liability, for any costs, losses or expenses incurred by the Seller or a prospective buyer relating to the sales and buying transaction. Our Sales Disclaimer, trading names and privacy policy on how your data is processed and used is found in full on our website in our Privacy Statement.

© Stone Estate Agents 2023 All rights Reserved