



15 Kilbride Avenue, Bolton

£320,000 Leasehold

Four double bedroom detached property • Fitted wardrobes in all bedrooms • Large four piece bathroom with separate shower and jacuzzi bath • Modern kitchen with black sparkle granite work surface • Integrated appliances in the kitchen • Orangery • Solid wood flooring throughout the ground floor • Integral garage • Large rear garden with pergola and pond • Large driveway for multiple vehicles





Presenting this exquisite 4-bedroom detached house, a contemporary haven that combines elegance with functionality seamlessly. Boasting four spacious double bedrooms, each adorned with fitted wardrobes for ample storage space, this abode ensures comfort and convenience for its inhabitants. The grandeur of the property extends to the large four-piece bathroom which features a separate shower and a luxurious jacuzzi bath, offering a retreat within the comforts of home. The modern kitchen is a culinary enthusiast's delight, equipped with sleek black sparkle granite work surfaces and integrated appliances that cater to every cooking need.

A highlight of the property is the charming orangery, flooding the interiors with natural light and creating a peaceful oasis within the home. Solid wood flooring throughout the ground floor further adds warmth and sophistication to the living spaces, while an integral garage provides practicality and additional storage solutions. The outdoor space is equally enticing, featuring a large rear garden complete with a pergola and a serene pond, ideal for outdoor gatherings and relaxation. A spacious driveway complements the property, allowing for parking of multiple vehicles with ease.

GROUND FLOOR



1ST FLOOR

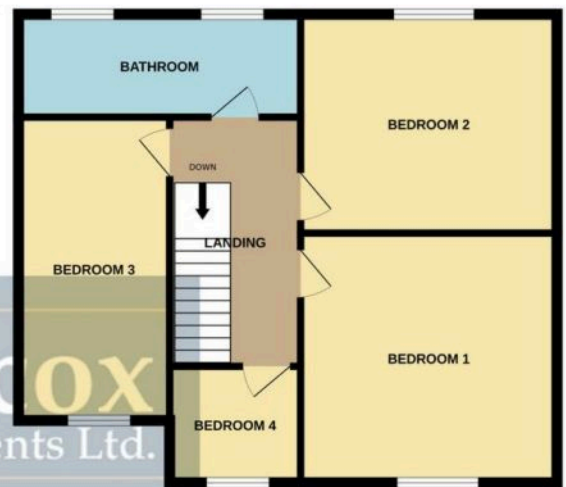

Whilst every attempt has been made to ensure the accuracy of the floorplan contained here, measurements of doors, windows, rooms and any other items are approximate and no responsibility is taken for any error, omission or mis-statement. This plan is for illustrative purposes only and should be used as such by any prospective purchaser. The services, systems and appliances shown have not been tested and no guarantee as to their operability or efficiency can be given.
Made with Metropix ©2025



Outside, the property presents a well-manicured landscape that exudes charm and tranquillity. A low-level brick wall encloses the property, offering a sense of security and privacy. The lawned area provides a green oasis, perfect for outdoor activities and enjoying the fresh air. Bushes, shrubs, and planters adorn the surroundings, adding a touch of natural beauty to the outdoor space. Access to the integral garage from the outside ensures convenience for homeowners, providing easy entry and storage solutions. Designed to cater to the needs of modern living while embracing elements of luxury and comfort, this property presents a rare opportunity to own a home that effortlessly blends style with practicality. With its impeccable interiors, exceptional outdoor space, and a prime location, this 4-bedroom detached house is a truly remarkable find for those seeking a harmonious blend of contemporary living and tranquil surroundings within a sought-after neighbourhood.