



Flat 1 9a Alcester Road

Studley, B80 7AN

£600 PCM



This is a studio apartment in the village of Studley within walking distance of local amenities. With a good sized kitchen diner, living area and shower room. With parking space.

EPC Band C
Council Tax Band A





GROUND FLOOR
316 sq.ft. (29.4 sq.m.) approx.

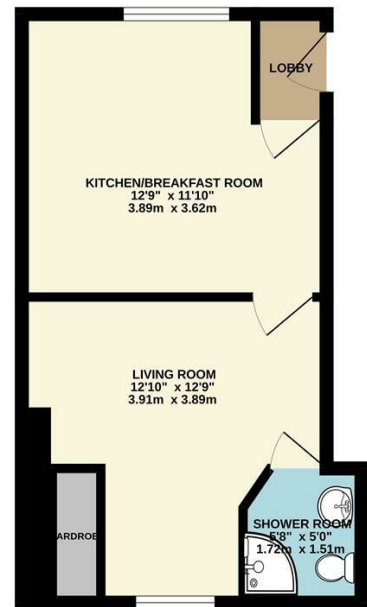

TOTAL FLOOR AREA: 316 sq.ft. (29.4 sq.m.) approx.
The plan is not drawn to scale and is for illustrative purposes only.
Made with Metropix ©2024

Energy Efficiency Rating		Current	Potential
Very energy efficient - lower running costs			
(92 plus) A			
(81-91) B			
(69-80) C		71	71
(55-68) D			
(39-54) E			
(21-38) F			
(1-20) G			
Not energy efficient - higher running costs			
England & Wales		EU Directive 2002/91/EC	

Environmental Impact (CO ₂) Rating		Current	Potential
Very environmentally friendly - lower CO ₂ emissions			
(92 plus) A			
(81-91) B			
(69-80) C		74	74
(55-68) D			
(39-54) E			
(21-38) F			
(1-20) G			
Not environmentally friendly - higher CO ₂ emissions			
England & Wales		EU Directive 2002/91/EC	

These particulars, whilst believed to be accurate are set out as a general outline only for guidance and do not constitute any part of an offer or contract. Intending purchasers should not rely on them as statements of representation of fact, but must satisfy themselves by inspection or otherwise as to their accuracy. No person in this firm's employment has the authority to make or give any representation or warranty in respect of the property.