

oakheart

£775,000

Asking Price

Base Green, Wetherden



This impressive property offers an exceptional opportunity to acquire a 5/6-bedroom residence set within approximately 1.77 acres of land (STS)!

Formerly two bungalows, Wetherden Hall Bungalow has been thoughtfully reconfigured into a large and versatile family home, offering both space and flexibility. Surrounded by peaceful farmland and scenic countryside, it provides the perfect balance of rural tranquility and easy access to local amenities.

This unique residence offers flexibility to suit varying needs and may be perfect for those looking for equestrian space due to the fenced

separate parcel of land adjacent to the main property and its garden grounds. In addition for those with particular interests in vehicle storage, the extensive car port for up to five cars could be put to good use.

Internally the property is offered in a neutral fashion with sympathetic decorative finishing that compliments the accommodation which in itself is naturally bright with plenty of countryside views.

For those seeking a rural retreat without being too far from essential amenities and transport links, this imposing family property offers

the perfect balance of countryside living with convenience.

Situated in the quiet village of Wetherden, this property is surrounded by stunning Suffolk farmland and offers a peaceful rural lifestyle. Wetherden is a charming and well-connected village, just a short distance from the popular town of Stowmarket, where you'll find a range of amenities including shops, schools, and transport links. Stowmarket provides easy access to the A14, making travel to nearby towns such as Bury St Edmunds, Ipswich, and Colchester convenient. The Stowmarket train station also offers direct rail services to London and Norwich, adding further appeal for those commuting or looking to explore the surrounding areas.















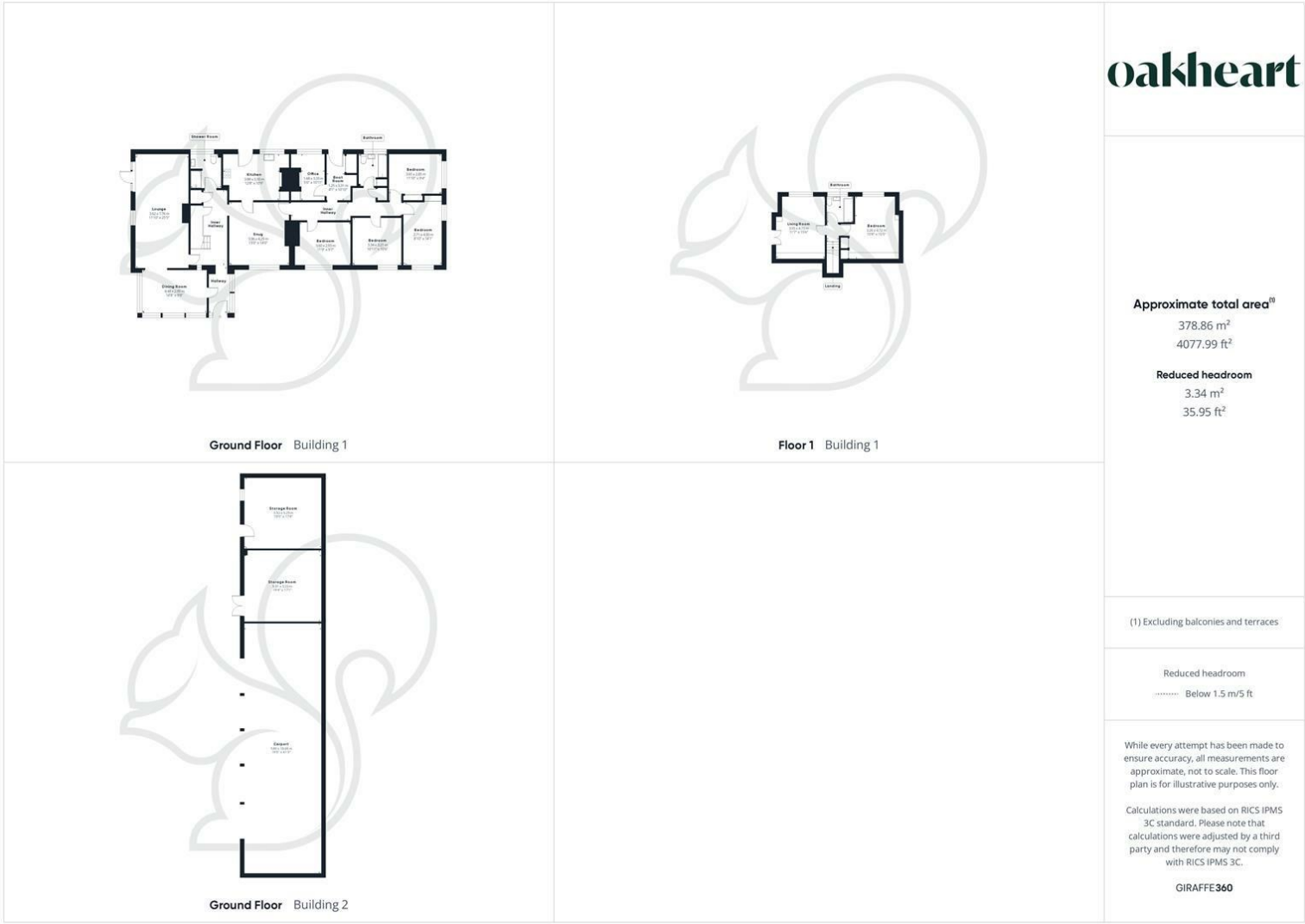

Local Authority:

Tenure:

Freehold

Council Tax Band:

D

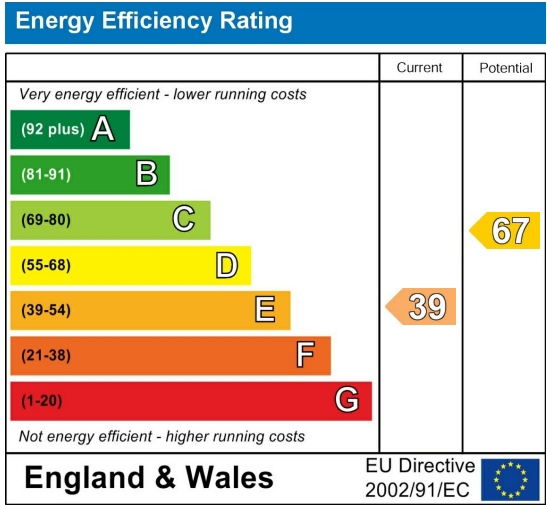

Agents Note: Whilst every care has been taken to prepare these particulars, they are for guidance purposes only. All measurements are approximate and are for general guidance purposes only and whilst every care has been taken to ensure their accuracy, they should not be relied upon.