

oakheart

£500,000

Offers Over
Wickham Road, Finningham



Nestled in the picturesque and tranquil village of Finningham, this detached chalet-style house offers a perfect blend of rural charm and modern comforts. This enviable three/four bedroom house enjoys generous accommodation and spacious outdoors space. Finningham is known for its scenic countryside and peaceful surroundings.

Step inside and be greeted by a bright and airy hallway, leading to the downstairs accommodation. The heart of the home, the living room features a traditional log burner in addition to large windows offering views of the surrounding countryside, bringing in plenty of natural

light and warmth. Leading into the dining area/sun room, this expansive space combines dining and relaxation areas, bathed in sunlight thanks to the large windows and glass doors that open out to the garden. The well-equipped kitchen that reflects the rustic charm of the village. It features modern appliances, ample storage, and an additional dining area, perfect for casual meals and morning coffee. Adjacent is the utility room, with a stable door leading outside.

The third bedroom is a comfortable space with views of the garden. A flexible space, the office/fourth bedroom provides a handy additional reception room. The downstairs bathroom is conveniently

located with modern fixtures, serving the downstairs living areas.

Upstairs, the two principle bedrooms and family bathroom are found. Both bedrooms offer ample storage and uninterrupted field views. The family bathroom is a generous size.

The expansive garden provides a perfect outdoor retreat, with ample space for gardening, outdoor activities, or simply relaxing. The garden offers stunning views of the surrounding countryside, enhancing the sense of peace and tranquility. Offers secure parking and additional storage space, with room for two vehicles and extra storage for bicycles, tools, or hobby equipment.









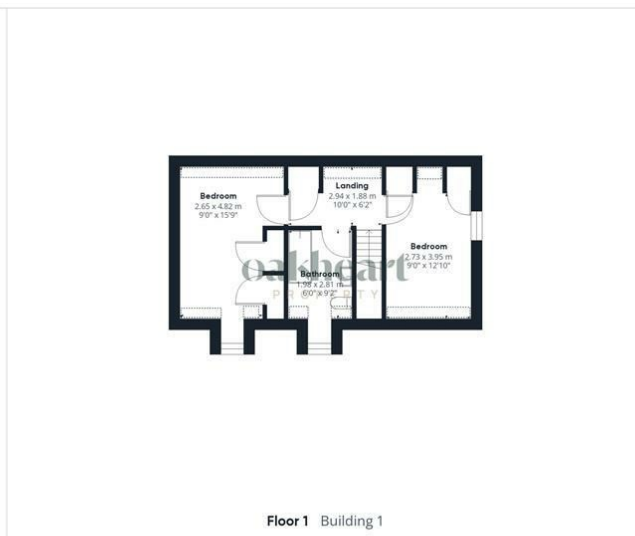

oakheart

Approximate total area⁽¹⁾
168.8 m²
1816.95 ft²

Reduced headroom
3.91 m²
42.09 ft²

(1) Excluding balconies and terraces

Reduced headroom
(below 1.5m/4.92ft)

While every attempt has been made to ensure accuracy, all measurements are approximate, not to scale. This floor plan is for illustrative purposes only.

GIRAFFE360

Local Authority:

Tenure:
Freehold

Council Tax Band:
E

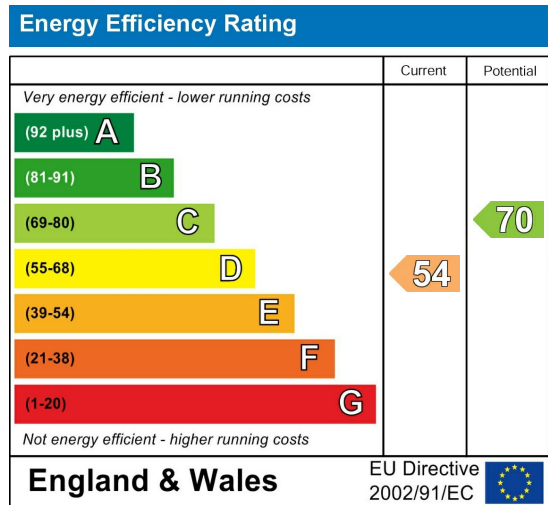

Agents Note: Whilst every care has been taken to prepare these particulars, they are for guidance purposes only. All measurements are approximate and are for general guidance purposes only and whilst every care has been taken to ensure their accuracy, they should not be relied upon.