



Flat 1, 37 Westbourne Terrace, London, W2 3UR  
£5,500



Flat 1, 37 Westbourne Terrace, London, W2 3UR

£5,500

Elevate your living experience with this charming three-bedroom apartment in Westbourne Terrace, right in the heart of Paddington, W2.



## Description

## Situation



Furnished  
Council Tax Band: E  
Available: 20th July 2025

Floor Plans

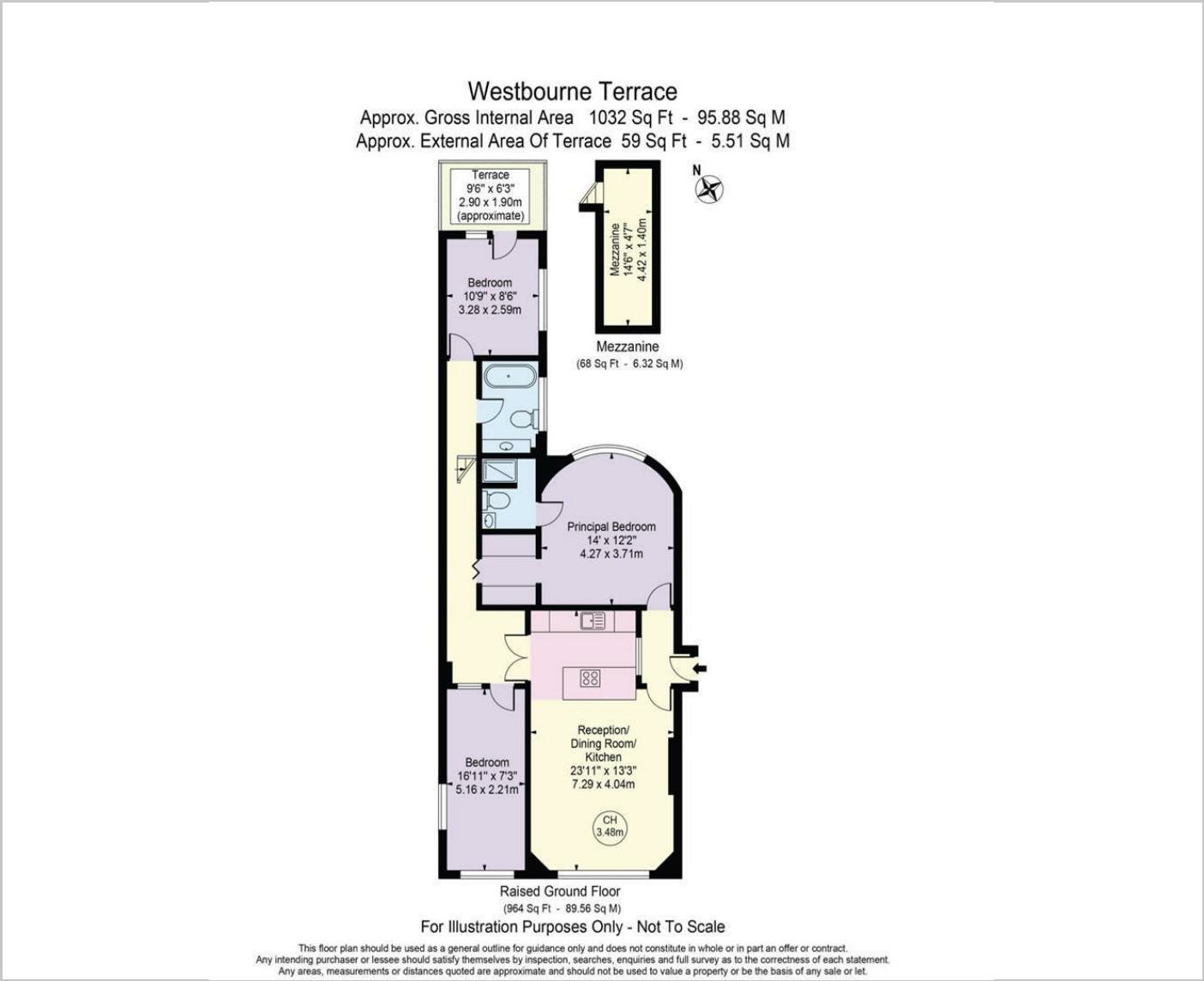

Area Map

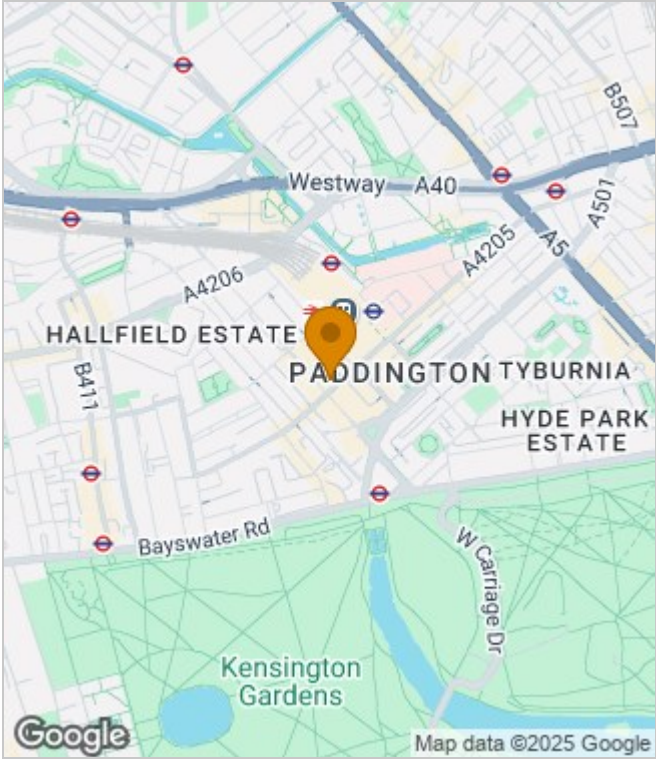

Energy Performance Graph

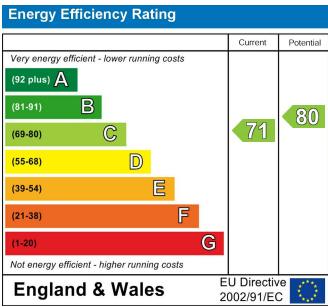

These particulars, whilst believed to be accurate are set out as a general outline only for guidance and do not constitute any part of an offer or contract. Intending purchasers should not rely on them as statements of representation of fact, but must satisfy themselves by inspection or otherwise as to their accuracy. No person in this firms employment has the authority to make or give any representation or warranty in respect of the property.