



## The Dovecote, North Charlton

£465,000 Freehold

Detached • Barn Conversion • Four Double Bedrooms • Underfloor Heating • No Upper Chain • Well Presented  
• Two reception Rooms • Spacious Accommodation



Northumberland  
Properties





The Dovecote is a stunning four-bedroom detached stone-built barn conversion, that combines traditional charm with modern comfort. Located in the peaceful village of North Charlton, lovingly maintained as a second home, it boasts spacious living areas, exposed beams, and stunning countryside views.

The area is close to attractions like Alnwick Castle and the Northumberland Coast, making it a peaceful yet accessible spot for those exploring the region's natural beauty and heritage, perfect for a relaxing retreat or a fantastic opportunity for a holiday let.

The property features four generously sized double bedrooms. The primary bedroom is particularly impressive, with its own private staircase leading to a delightful dressing area or study, as well as a spacious ensuite bathroom.



On the ground floor, there are two beautifully appointed reception rooms, both boasting vaulted ceilings with exposed wooden beams that enhance the cottage's character. These spaces are ideal for relaxing or entertaining, with plenty of room for the whole family to enjoy. The country-style kitchen benefits from integrated appliances, a generous amount of worksurfaces and units, and provide a perfect setting for family meals and gatherings.



Externally, The Dovecote offers lawned private gardens to both the front and rear of the property and benefits from convenient off-road parking in the shared courtyard.

Set in a tranquil location, Dovecote offers the charm of rural living while still being within easy reach of local amenities and transport links. This spacious and characterful home is a true gem, offering a comfortable and stylish lifestyle in a picturesque setting.











First Floor

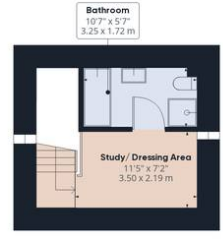

Floor 1

**Approximate total area<sup>(1)</sup>**  
1787.02 ft<sup>2</sup>  
166.02 m<sup>2</sup>

(1) Excluding balconies and terraces

While every attempt has been made to ensure accuracy, all measurements are approximate, not to scale. This floor plan is for illustrative purposes only.

Calculations are based on RICS IPMS 3C standard.

GIRAFFE 360