



2 Bedroom Apartment located in Solihull.

Find us on..



ENCASA
SALES | LETTINGS | FINANCE

**7 Warwick Park
Court, 252
Warwick Road,
Solihull, B92 7AJ**



2



2



1



TAX



EPC

66



FLOORPLAN

FLOOR SPACE
901 sq.ft. (83.7 sq.m.) approx.

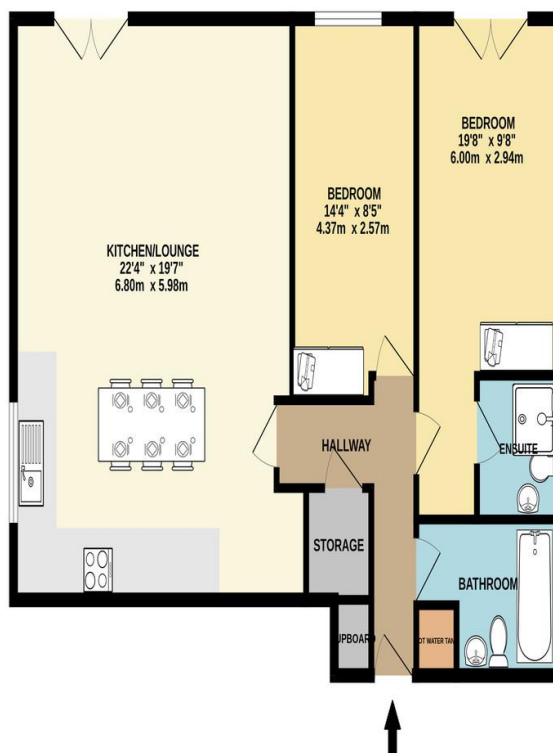

TOTAL FLOOR AREA: 901 sq.ft. (83.7 sq.m.) approx.
While every attempt has been made to ensure the accuracy of the floorplan contained herein, measurements of doors, windows, rooms and any other items are approximate and no responsibility is taken for any error, omission or mis-statement. This plan is for illustrative purposes only and should be used as such by any prospective purchaser. The services, systems and appliances shown have not been tested and no guarantee as to their operability or efficiency can be given.
Made with Metropix ©2024

CONTACT

**57 Warwick Road,
Solihull, West Midlands,
B92 7HS**

EMAIL

info@encasagroup.co.uk

TEL

0121 272 4848

www.encasagroup.co.uk

Asking Price Of £265,000

SUMMARY

Encasa are delighted to offer this immaculate two bedroom apartment in the popular Warwick Park Court, Solihull. This spacious property has plenty of living space with a large lounge/kitchen area, two double bedrooms, bathroom and a further en-suite to the master bedroom.

DIRECTIONS