



Plot 38 | Bramley Fields | Southwell | NG250DX

£460,000

FENTON JONES



Key features

- 3 bedroom home
- 2 bathrooms
- Open-plan kitchen and dining area
- Separate living room with French doors out to the garden
- Master bedroom with ensuite
- Solar PV panels
- Minster school catchment

Description

In partnership with Cameron Homes, we are excited to offer a stunning collection of brand new 2-5 bedroom homes at Bramley Fields, Southwell.

Located on the edge of picturesque Southwell, and set within private, landscaped grounds, Bramley Fields is an exclusive new neighbourhood of 45 2-5 bedroom homes.

The Chapman House: Designed with style and functionality in mind, the Chapman offers versatile space for you to adapt to suit your lifestyle.

Bramley Fields is within walking distance of Southwell, a thriving market town with a Minster and a great collection of independent shops, cafes and restaurants. There are a number of highly regarded infant and junior schools as well as the much sought after Minster secondary school. There is access to many different sports and recreational facilities nearby. Southwell is surrounded by open countryside with plenty of beautiful walks right on your doorstep. Conveniently located for commuters with Newark Northgate Station just 15 minutes away with high-speed access to London Kings Cross in just 1 hour and 15 minutes. Nottingham is 30 minutes by car.

* Incentives available ahead of show home opening *



Additional information

*NB Estimated council tax band

Floor plans

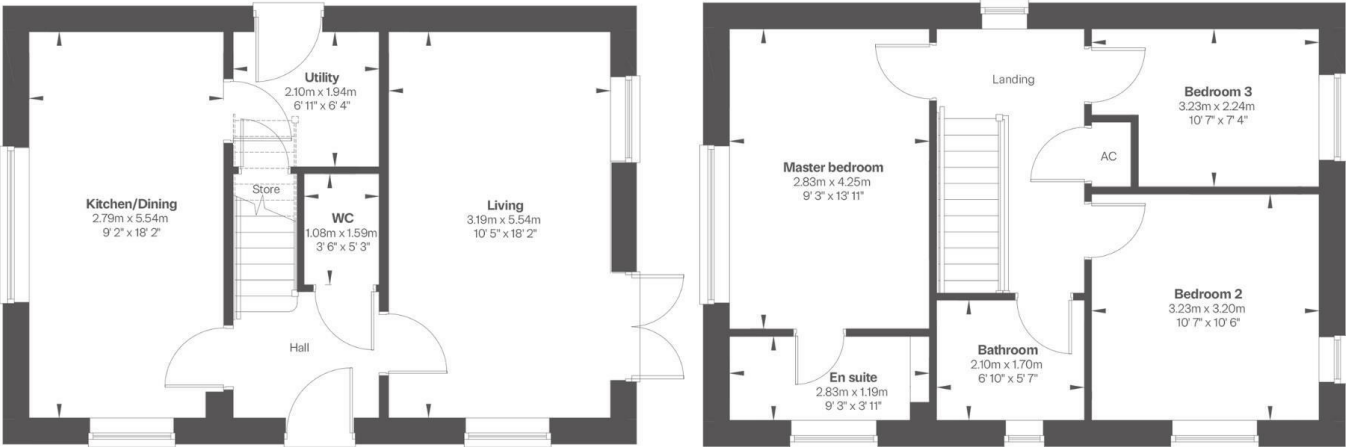

Energy Efficiency Rating		
	Current	Potential
Very energy efficient - lower running costs		
(92 plus) A		
(81-91) B		
(69-80) C		
(55-68) D		
(39-54) E		
(21-38) F		
(1-20) G		
Not energy efficient - higher running costs		
England & Wales		EU Directive 2002/91/EC

FENTON JONES

7 Church Street
Southwell
Nottinghamshire
NG25 0HQ
01636 390000
sales@fentonjones.com
<https://www.fentonjones.com>