



Plot 4 | Bramley Fields | Southwell | NG250DX

£330,000

FENTON JONES

Key features

- 2 bedroom single floor home
- 1 bathroom
- Kitchen door opening onto the rear garden
- Spacious master bedroom
- Solar PV panels
- Perfect for those looking to downsize
- 2 private parking spaces

Description

In partnership with Cameron Homes, we are excited to offer a stunning collection of brand new 2-5 bedroom homes at Bramley Fields, Southwell.

Located on the edge of picturesque Southwell, and set within private, landscaped grounds, Bramley Fields is an exclusive new neighbourhood of 45 2-5 bedroom homes.

The Ash Bungalow: Enjoy the ease of single-storey living with the Ash, designed with versatile spaces for entertaining family and friends.

Bramley Fields is within walking distance of Southwell, a thriving market town with a Minster and a great collection of independent shops, cafes and restaurants. There are a number of highly regarded infant and junior schools as well as the much sought after Minster secondary school. There is access to many different sports and recreational facilities nearby. Southwell is surrounded by open countryside with plenty of beautiful walks right on your doorstep. Conveniently located for commuters with Newark Northgate Station just 15 minutes away with high-speed access to London Kings Cross in just 1 hour and 15 minutes. Nottingham is 30 minutes by car.



Additional information

*NB Estimated council tax band

Floor plans

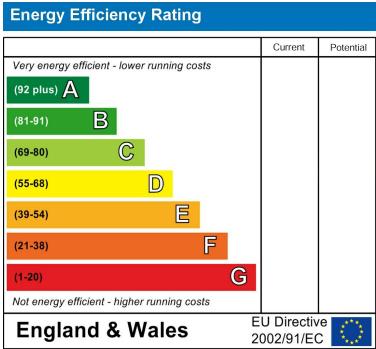
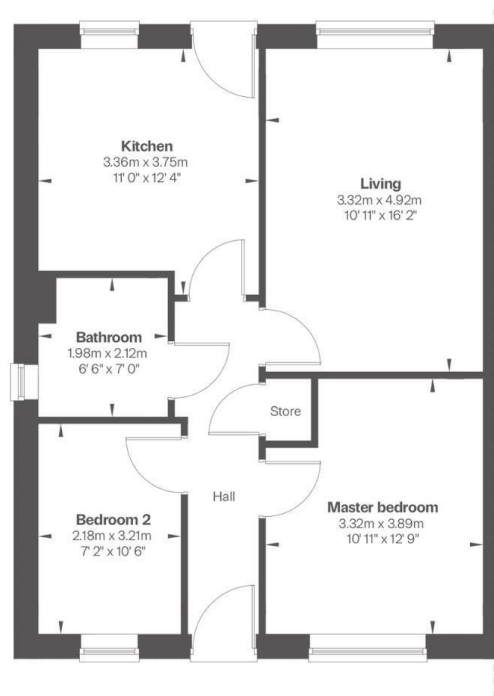

FENTON JONES

7 Church Street
Southwell
Nottinghamshire
NG25 0HQ
01636 390000
sales@fentonjones.com
<https://www.fentonjones.com>