



## Wellington Road, London

Asking price £950,000

- 1,356 sq. ft.
- Parking space
- Courtyard gardens
- Terrace/Balconies
- 4 bedrooms
- Secure gated development
- Dual aspect open plan living
- 2 bathrooms

### Artisan Mews, Warfield Road, London, NW10

Approximate Area = 1323 sq ft / 122.9 sq m  
 Limited Use Area(s) = 33 sq ft / 3 sq m  
 Total = 1356 sq ft / 125.9 sq m  
 For identification only - Not to scale

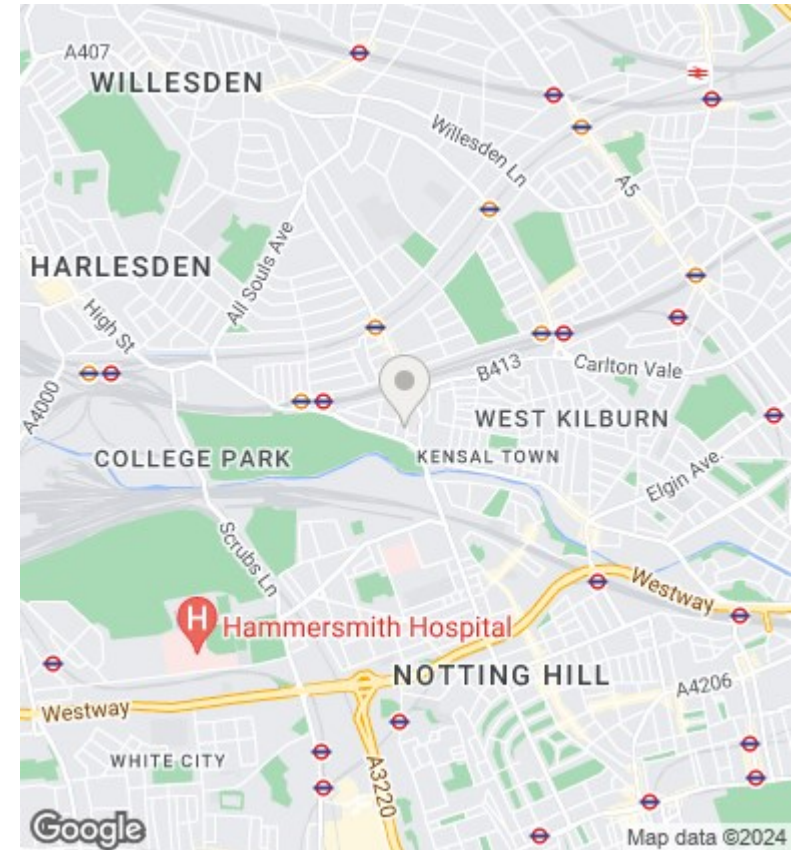
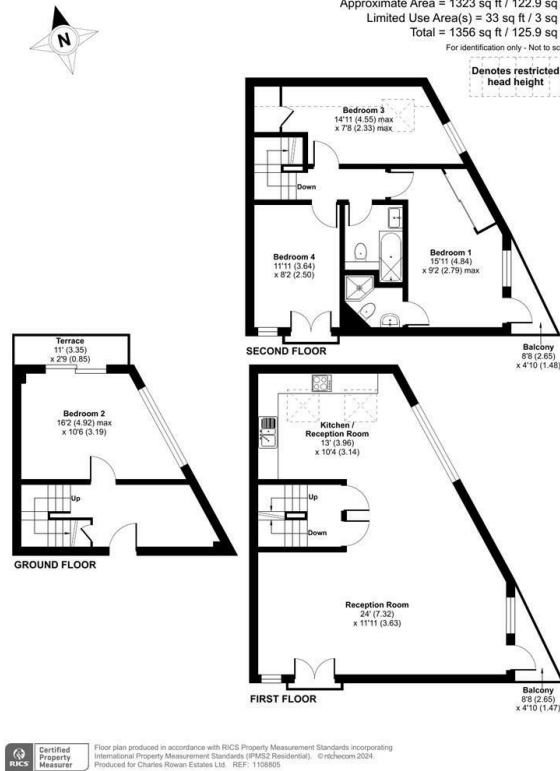

### Directions

Wellington Road is a quiet residential street within walking distance of Kensal Green station (0.3 miles) which services the Bakerloo line and the London Overground, along with Kensal Rise station (0.4 miles) which also services the London Overground. Notting Hill and the Portobello Road area are easily accessible and the vibrant cafes, bars and restaurants on Chamberlayne Road are in walking distance. Ladbroke Grove station is also within 1 mile of the property and services both the Circle line

### Viewings

Viewings by arrangement only. Call +44 20 3300 3550 to make an appointment.

### Council Tax Band

F

### EPC Rating:

C

