



166 Manor Park Road  
Harlesden  
London  
NW10 4JT  
T 020 8965 2250  
E sales@churchillmathesons.com  
www.churchillmathesons.com

**Churchill & Mathesons**

Old Oak Lane, London, NW10 6UB

£576 Per Week



**KEY FEATURES:**

- Spacious 3 bedroom terraced house close to Willesden Junction Station
- 2 Double and 1 good sized single bedroom
- Rear Garden
- FURNISHED ~ AVAILABLE 10th of May
- Ealing Council Tax Band D

Spacious 3 bedroom terraced house close to Willesden Junction Station  
2 Double and 1 good sized single bedroom  
2 Reception rooms  
Separate kitchen with direct access to a low maintenance private garden  
Bright tiled bathroom  
Rear Garden  
Located close to all amenities of Harlesden. Very close to Willesden Junction station and a short walk from North Acton tube station  
FURNISHED  
Available 10th may Ealing Council Tax Band D



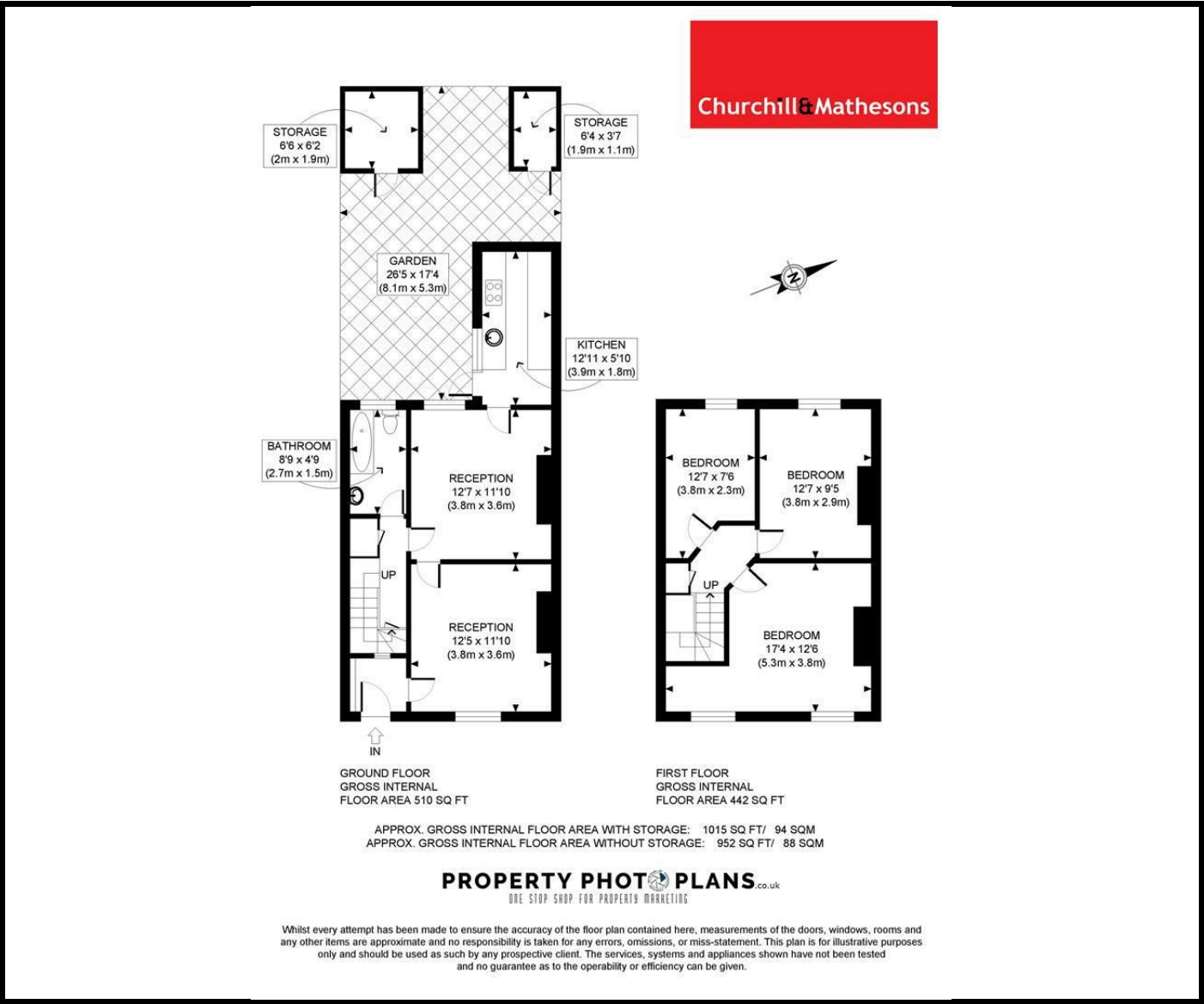

Energy Efficiency Rating		
	Current	Potential
Very energy efficient - lower running costs		
(92 plus) <b>A</b>		
(81-91) <b>B</b>		
(69-80) <b>C</b>		
(55-68) <b>D</b>		
(39-54) <b>E</b>		
(21-38) <b>F</b>		
(1-20) <b>G</b>		
Not energy efficient - higher running costs		
<b>England &amp; Wales</b>	EU Directive 2002/91/EC	

Environmental Impact (CO <sub>2</sub> ) Rating		
	Current	Potential
Very environmentally friendly - lower CO <sub>2</sub> emissions		
(92 plus) <b>A</b>		
(81-91) <b>B</b>		
(69-80) <b>C</b>		
(55-68) <b>D</b>		
(39-54) <b>E</b>		
(21-38) <b>F</b>		
(1-20) <b>G</b>		
Not environmentally friendly - higher CO <sub>2</sub> emissions		
<b>England &amp; Wales</b>	EU Directive 2002/91/EC	

Whilst every effort is made to give a fair description, the accuracy of these particulars is not guaranteed, neither do they constitute an offer or contract.

**CHURCHILL & MATHESONS ESTATE AGENTS** have not tested any apparatus, equipment, fitting or services and so cannot verify that they are in working order. The buyer is advised to obtain verification from their solicitor or surveyor. Measurements are correct to within +/- 6 A sonic tape is used. None of the statements contained in these particulars or any of our properties are to be relied upon as a representation of fact.