

Manor Park Road, London, NW10 4JU

Offers In Excess Of £300,000 Leasehold



KEY FEATURES:

- CHAIN FREE
- PERIOD FLAT
- HIGH CEILINGS
- WEST FACING GARDEN
- LONG LEASE
- NO SERVICE CHARGE

Welcome to this charming 618sqft ground floor period property that boasts original features and high ceilings, perfect for those who appreciate the character of a traditional British property. This delightful flat offers a spacious reception room, a large bedroom, a shower and separate toilet. The kitchen, diner combo leads out into a low maintenance west-facing garden offering a peaceful outdoor space to relax and unwind after a long day.

One of the key highlights of this property is the potential to extend (STPP). and modernize. This opens up exciting possibilities for customising both indoor and outside space to suit your needs and lifestyle, making it a truly unique opportunity for those with a little creative vision.

Located near local amenities, transport links, and Roundwood Park (Aviary, Cafe, Playground), providing the perfect balance between city living and suburban tranquillity.

Book a viewing today and step into a world of classic elegance and modern potential.

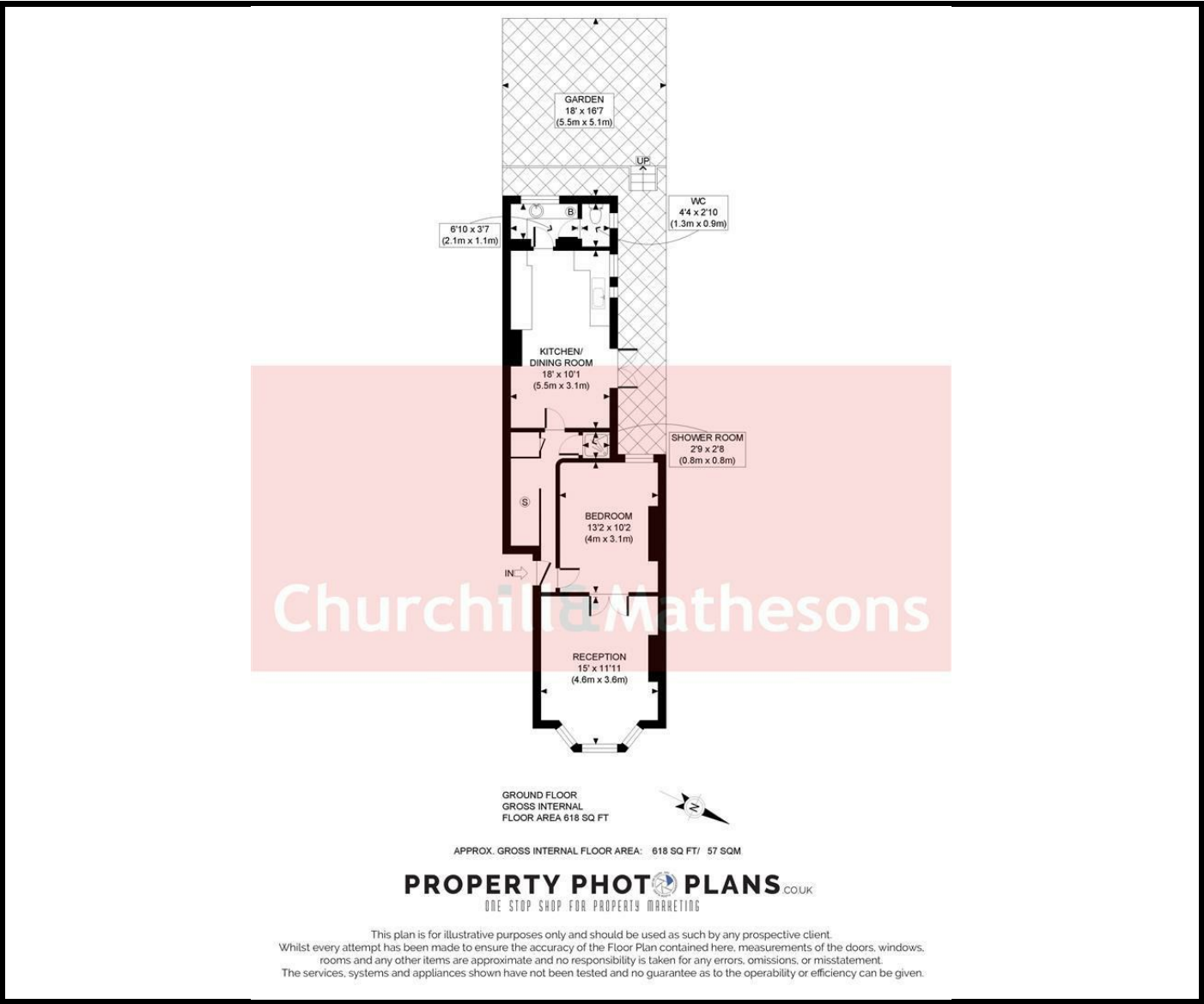

Energy Efficiency Rating		
	Current	Potential
Very energy efficient - lower running costs		
(92 plus) A		
(81-91) B		
(69-80) C		
(55-68) D		
(39-54) E		
(21-38) F		
(1-20) G		
Not energy efficient - higher running costs		
England & Wales	EU Directive 2002/91/EC	

Environmental Impact (CO ₂) Rating		
	Current	Potential
Very environmentally friendly - lower CO ₂ emissions		
(92 plus) A		
(81-91) B		
(69-80) C		
(55-68) D		
(39-54) E		
(21-38) F		
(1-20) G		
Not environmentally friendly - higher CO ₂ emissions		
England & Wales	EU Directive 2002/91/EC	

Whilst every effort is made to give a fair description, the accuracy of these particulars is not guaranteed, neither do they constitute an offer or contract.

CHURCHILL & MATHESONS ESTATE AGENTS have not tested any apparatus, equipment, fitting or services and so cannot verify that they are in working order. The buyer is advised to obtain verification from their solicitor or surveyor. Measurements are correct to within +/-6 A sonic tape is used. None of the statements contained in these particulars or any of our properties are to be relied upon as a representation of fact.