



Inman Road, London, NW10 9JT

Offers In Excess Of £275,000 Leasehold



**KEY FEATURES:**

- GARDEN FLAT
- SOUTH FACING GARDEN
- 2 BEDROOM
- 1 BATHROOM
- 1 RECEPTION
- 0.5 MILES TO HARLESDEN STATION

BLACK FRIDAY SALE, REDUCED TO SELL

Welcome to this 666sqft garden flat located on Inman Road in London, NW10. This delightful period flat that needs modernizing, boasts a cosy reception room with a bay window, two bedrooms and a well-maintained bathroom, ensuring convenience and comfort for its residents. The good size garden is south facing and is perfect for outdoor entertaining.

Whether you are looking for your first home or a rental investment on a tree lined road, this property has much to offer.

Situated in a vibrant area of London, NW10, this property provides easy access to local amenities, Harlesden Station.

Contact us today to arrange a viewing and discover the potential this property holds for you.

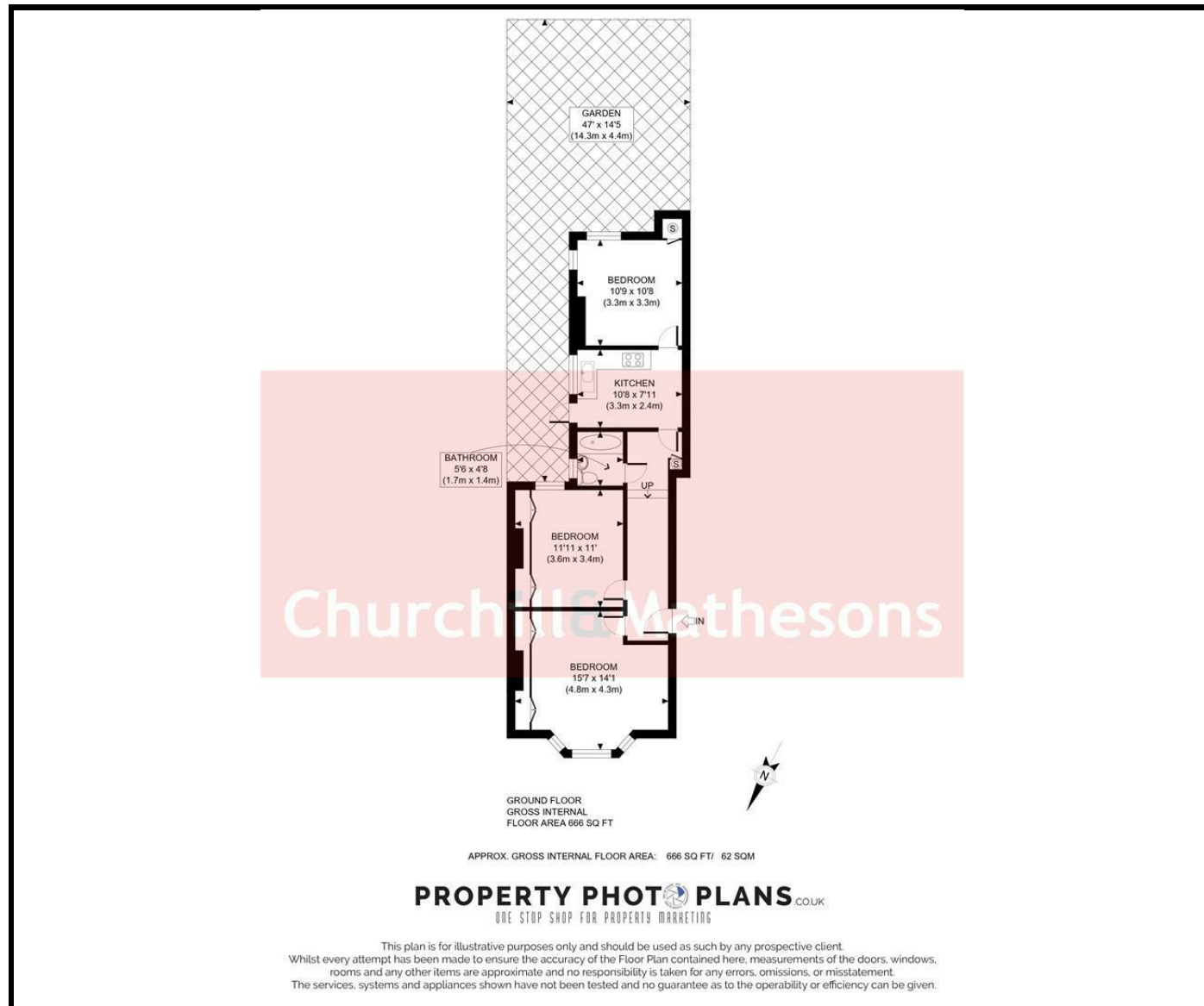

**Energy Efficiency Rating**

	Current	Potential
Very energy efficient - lower running costs		
(92 plus) <b>A</b>		
(81-91) <b>B</b>		
(69-80) <b>C</b>		
(55-68) <b>D</b>	<b>57</b>	<b>72</b>
(39-54) <b>E</b>		
(21-38) <b>F</b>		
(1-20) <b>G</b>		
Not energy efficient - higher running costs		

**England & Wales** EU Directive 2002/91/EC

**Environmental Impact (CO<sub>2</sub>) Rating**

	Current	Potential
Very environmentally friendly - lower CO <sub>2</sub> emissions		
(92 plus) <b>A</b>		
(81-91) <b>B</b>		
(69-80) <b>C</b>		
(55-68) <b>D</b>		
(39-54) <b>E</b>		
(21-38) <b>F</b>		
(1-20) <b>G</b>		
Not environmentally friendly - higher CO <sub>2</sub> emissions		

**England & Wales** EU Directive 2002/91/EC

Whilst every effort is made to give a fair description, the accuracy of these particulars is not guaranteed, neither do they constitute an offer or contract.

**CHURCHILL & MATHESONS ESTATE AGENTS** have not tested any apparatus, equipment, fitting or services and so cannot verify that they are in working order. The buyer is advised to obtain verification from their solicitor or surveyor. Measurements are correct to within +/- 6 A sonic tape is used. None of the statements contained in these particulars or any of our properties are to be relied upon as a representation of fact.