



Nuthatch Apartments, 16 Shearwater Drive, London, NW9 7GD

£380 Per Week



KEY FEATURES:

- Spacious 1 bedroom flat built in wardrobe
- Modern fully fitted kitchen space with integrated appliances
- Stylish fully tiled bathroom
- FURNISHED/UNFURNISHED ~ AVAILABLE NOW

A spectacular and brand new 1 Bedroom flat in this iconic building in Hendon built by Barratt Homes
* Modern fully fitted kitchen space with integrated appliances
* Open plan reception room with direct access to the Balcony
* Stylish fully tiled bathroom
* Well located with excellent access to transport links and amenities within the area
FURNISHED/UNFURNISHED ~ AVAILABLE NOW

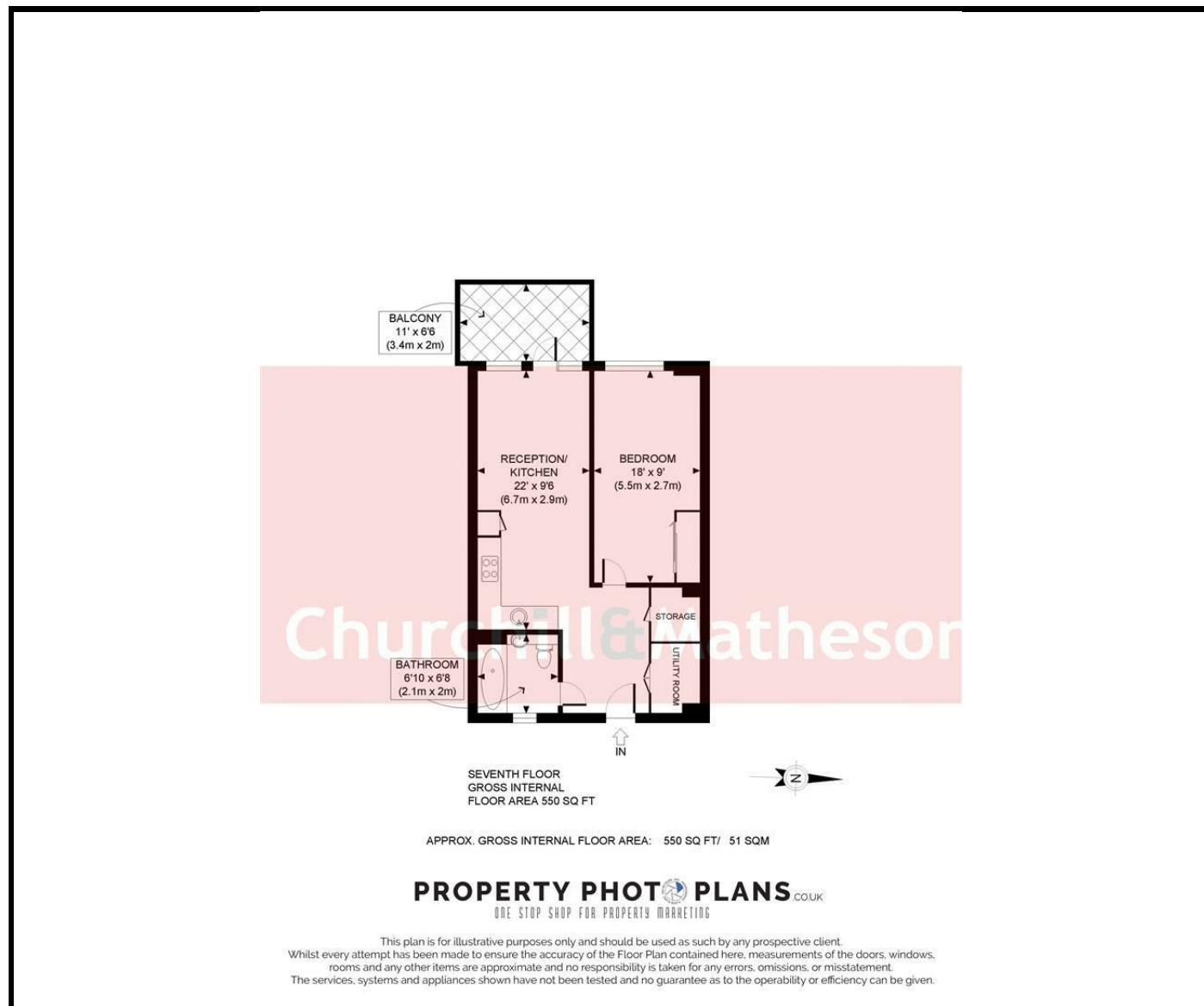

Energy Efficiency Rating

	Current	Potential
Very energy efficient - lower running costs		
(92 plus) A		
(81-91) B		
(69-80) C		
(55-68) D		
(39-54) E		
(21-38) F		
(1-20) G		
Not energy efficient - higher running costs		

England & Wales EU Directive 2002/91/EC

Environmental Impact (CO₂) Rating

	Current	Potential
Very environmentally friendly - lower CO ₂ emissions		
(92 plus) A		
(81-91) B		
(69-80) C		
(55-68) D		
(39-54) E		
(21-38) F		
(1-20) G		
Not environmentally friendly - higher CO ₂ emissions		

England & Wales EU Directive 2002/91/EC

Whilst every effort is made to give a fair description, the accuracy of these particulars is not guaranteed, neither do they constitute an offer or contract.

CHURCHILL & MATHESONS ESTATE AGENTS have not tested any apparatus, equipment, fitting or services and so cannot verify that they are in working order. The buyer is advised to obtain verification from their solicitor or surveyor. Measurements are correct to within +/- 6 A sonic tape is used. None of the statements contained in these particulars or any of our properties are to be relied upon as a representation of fact.