



13 Osborne Drive, Fleet

£650,000 Freehold

SOUGHT AFTER ROAD • CLOSE TO FLEET • GREAT ORDER • GARAGE/DRIVEWAY • DETACHED BUNGALOW • VERY GOOD DECOR • SOLD WITH NO CHAIN



THE PROPERTY EXPLORER Stunning 4-bed bungalow near Fleet town. Impeccably maintained and beautifully presented, this spacious home offers modern elegance, 4 bedrooms (1 with ensuite), open plan kitchen/dining, tastefully decorated living room, garage, driveway, and landscaped garden.

Council Tax band: E

Tenure: Freehold

EPC Energy Efficiency Rating: D

EPC Environmental Impact Rating: D



- › SOUGHT AFTER ROAD
- › CLOSE TO FLEET
- › GREAT ORDER
- › GARAGE/DRIVEWAY
- › DETACHED BUNGALOW
- › VERY GOOD DECOR
- › SOLD WITH NO CHAIN





GROUND FLOOR
1237 sq.ft. (114.9 sq.m.) approx.

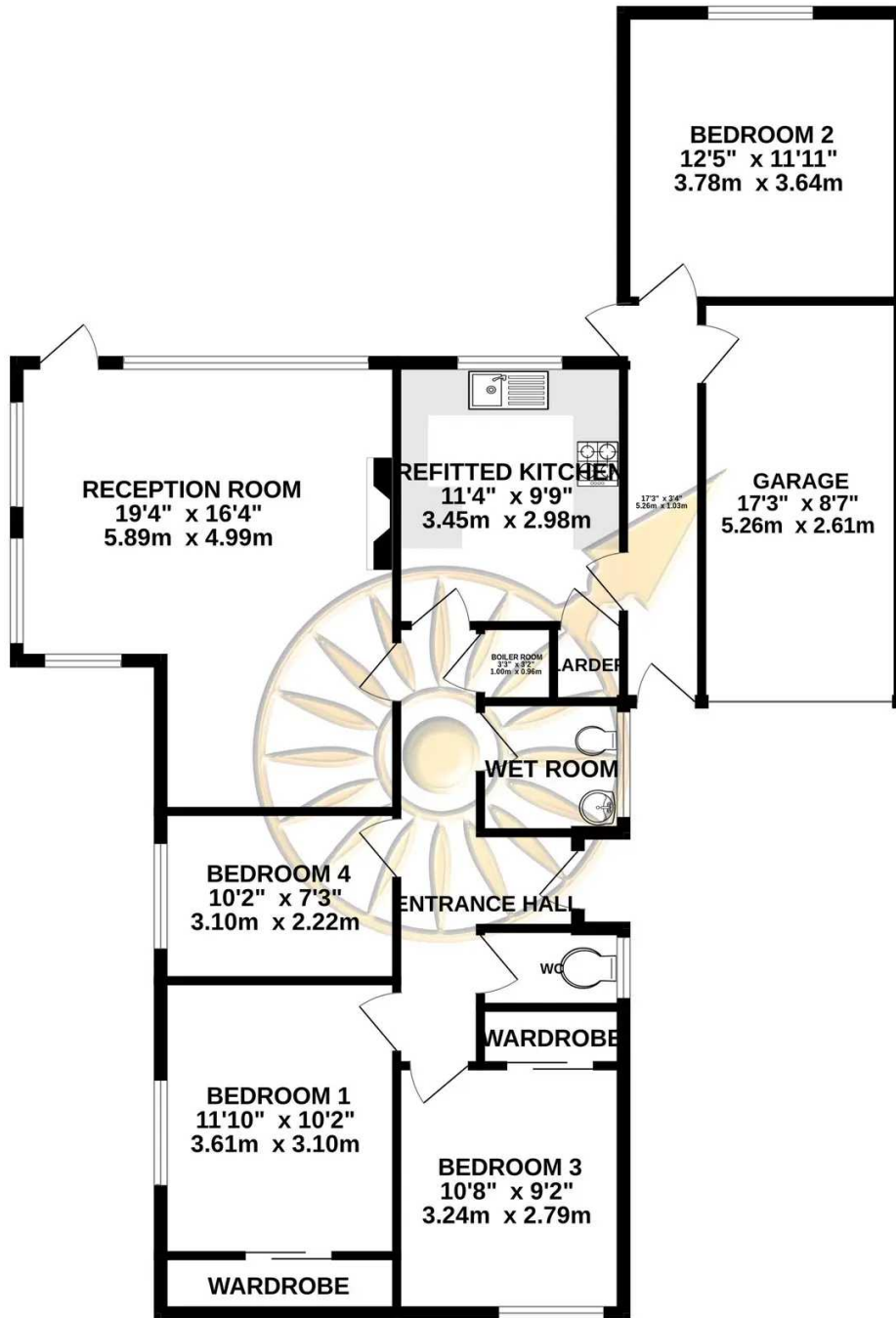

TOTAL FLOOR AREA : 1237 sq.ft. (114.9 sq.m.) approx.

Whilst every attempt has been made to ensure the accuracy of the floorplan contained here, measurements of doors, windows, rooms and any other items are approximate and no responsibility is taken for any error, omission or mis-statement. This plan is for illustrative purposes only and should be used as such by any prospective purchaser. The services, systems and appliances shown have not been tested and no guarantee as to their operability or efficiency can be given.

Made with Metropix ©2023

You can include any text here. The text can be modified upon generating your brochure.