



## 24 Waverley Drive, Ash Vale

£450,000 Freehold

LOUNGE/DINING ROOM • GARAGE/DRIVEWAY/PARKING • FITTED KITCHEN • UPVC BRICK BUILT CONSERVATORY • GAS CENTRAL HEATING/UPVC DOUBLE GLAZING • NO CHAIN COMPLICATIONS • SOUGHT AFTER ROAD • THREE GOOD SIZE BEDROOMS



Impressive 3 bed bungalow in sought-after location. Spacious lounge/dining room, fitted kitchen, UPVC conservatory. Generous bedrooms. Gas central heating, UPVC double glazing. Large driveway, well-maintained gardens. Detached garage. Secure. Perfect family home. Book a viewing now!  
Council Tax band: D

Tenure: Freehold

EPC Energy Efficiency Rating: E

EPC Environmental Impact Rating: E



- LOUNGE/DINING ROOM
- GARAGE/DRIVEWAY/PARKING
- FITTED KITCHEN
- UPVC BRICK BUILT CONSERVATORY
- GAS CENTRAL HEATING/UPVC DOUBLE GLAZING
- NO CHAIN COMPLICATIONS
- SOUGHT AFTER ROAD
- THREE GOOD SIZE BEDROOMS



GROUND FLOOR  
1141 sq.ft. (106.0 sq.m.) approx.

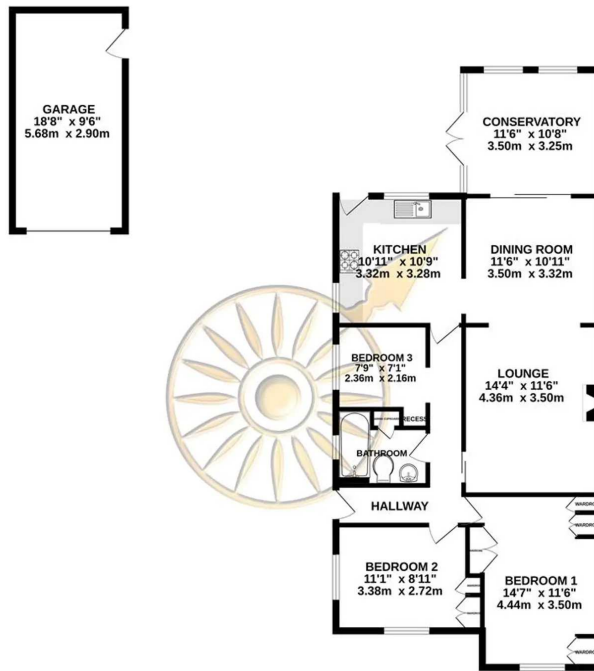

TOTAL FLOOR AREA: 1141 sq.ft. (106.0 sq.m.) approx.

Whilst every attempt has been made to ensure the accuracy of the floorplans contained here, measurements of doors, windows, rooms and any other items are approximate and no responsibility is taken for any error, omission or misstatement. This plan is for illustrative purposes only and should be used as such by any prospective purchaser. The services, systems and appliances shown have not been tested and no guarantee as to their operability or efficiency can be given.  
Made with Metropix ©2023

You can include any text here. The text can be modified upon generating your brochure.