



GATEWAY CAPITAL
PROPERTY

LONDON | PROPERTY MANAGEMENT SPECIALISTS

TO LET

£2,150 Per month



- Canary Wharf and Dock views
- One Bedroom
- High Floor
- Private Balcony
- Residents Concierge and Gym
- West Facing
- Partial River Thames Views

THE PROPERTY

A Stunning 1 Bedroom apartment with direct views towards Canary Wharfs skyline and Docks. South West Facing also has River Thames views from the reception and benefits from a Concierge and fully equipped Gym. 5 mins walk to DLR, 12mins walking Jubilee line and minutes from Canary Wharfs many Shops, Restaurants and Offices via the Wood Wharf entrance.

This spacious one bedroom apartment on high floor has some of the best views in London and comprises of an open plan kitchen living and dining space with breakfast bar and a modern kitchen. Bedroom with built in wardrobes and bathroom with shower over bath. Ample storage in the hall and a full width balcony accessible from the bedroom and lounge, boasting the apartments main feature- the views! Available from 7th May and viewings starting 1st May. See video for views

SITUATION

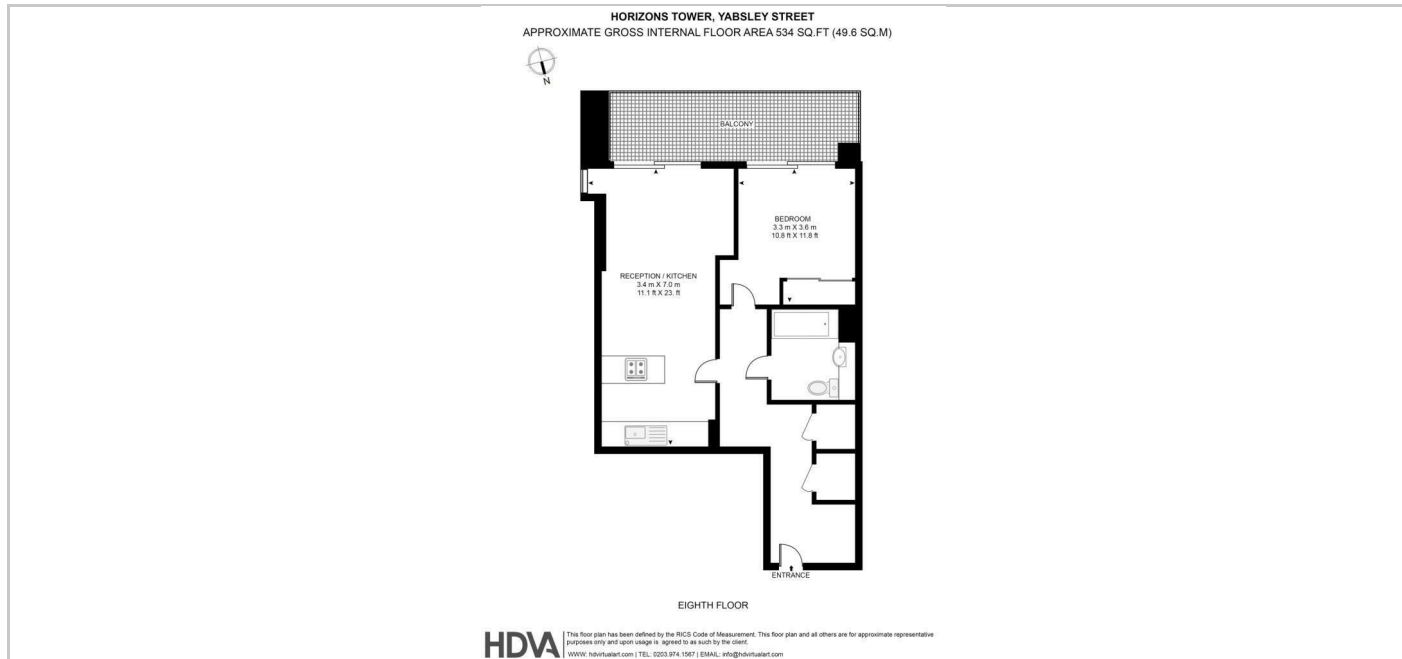

Directions

167-169 Great Portland Street, 5th Floor, London, W1W 5PF
Tel: 02080 640 181 Email: info@gatewaycapitalproperty.com