



**GATEWAY CAPITAL
PROPERTY**

LONDON'S PROPERTY MANAGEMENT SPECIALIST



TO LET



£2,550 Per month

- 2-bed 2-bath newly built apartment, with huge terrace
- An established community with shops, restaurants & convenient facilities
- 24/7 concierge
- Private spa with fitness studio, gym, swimming pool, sauna & jacuzzi
- Excellent transport links just- 5- minutes to Colindale Station
- Right to park

THE PROPERTY

Set in 25-acres with a landscaped parkland at its heart, and situated in North West London just a few stops away from Hampstead and Camden, Beaufort Park is perfect for the modern Londoner. From its historic origins as the site of the world's first airfield, to today's vibrant neighbourhood – the story of Beaufort Park is forever evolving. The excellent on-site facilities include an exclusive, residents-only spa home to a large fitness studio, fully-equipped gym, indoor swimming pool, sauna and jacuzzi. The local area's particular charm makes it well suited to every kind of resident – both locals and newcomers, those starting out and those settling down. Connections to the City and West End are easy with Colindale Station less than a mile away from Beaufort Park.

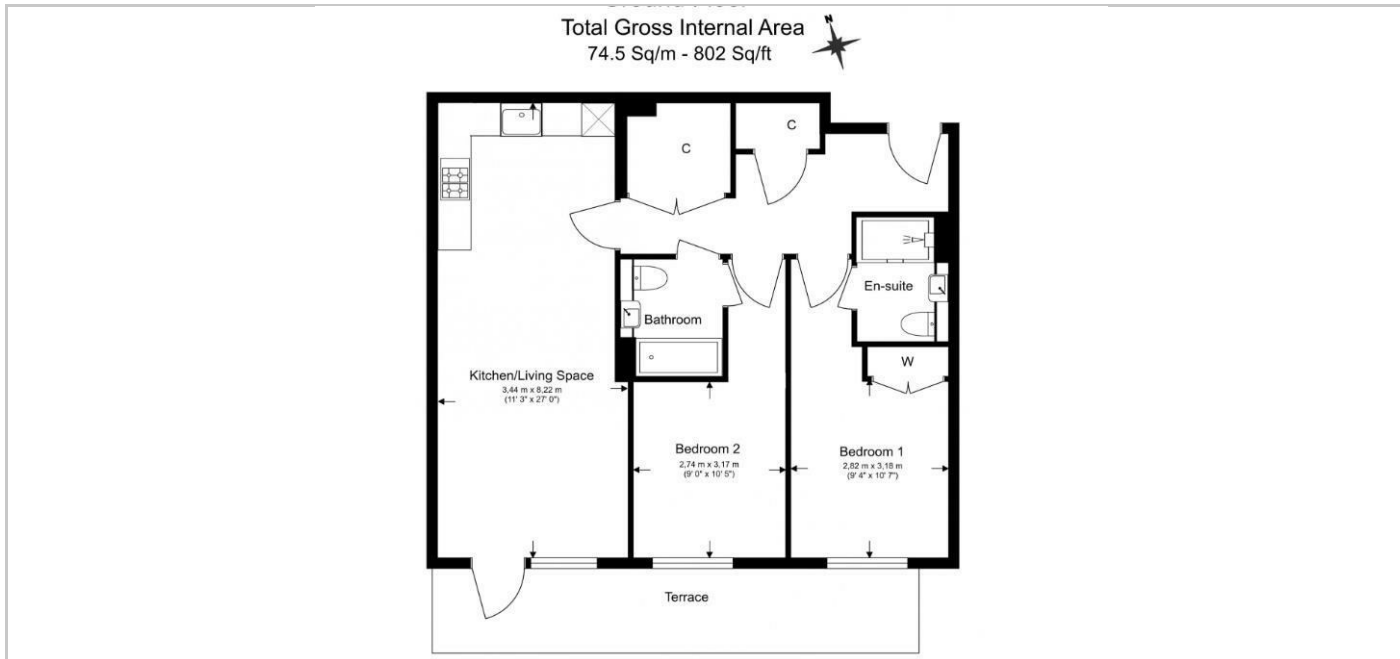

SITUATION

Directions