



**GATEWAY CAPITAL
PROPERTY**

LONDON'S PROPERTY MANAGEMENT SPECIALIST



GATEWAY CAPITAL
PROPERTY
LONDON'S PROPERTY MANAGEMENT SPECIALIST

TO LET



£3,500 Per month

- Brand new 2 Bed
- Resident's Gym
- 24/7 Concierge
- Big Balcony
- Full furnished

THE PROPERTY

A large brand new two bedroom apartment within the modern development Elephant Park.

The development is a short walk to Elephant & Castle tube/train stations making this an easy commute into The City. The property is also spoilt for choice with cafés, bars and restaurants including the popular Mercato Metropolitano.

All images used are for illustrative purposes only and do not represent actual property. Furniture and dimensions for this property type may differ.

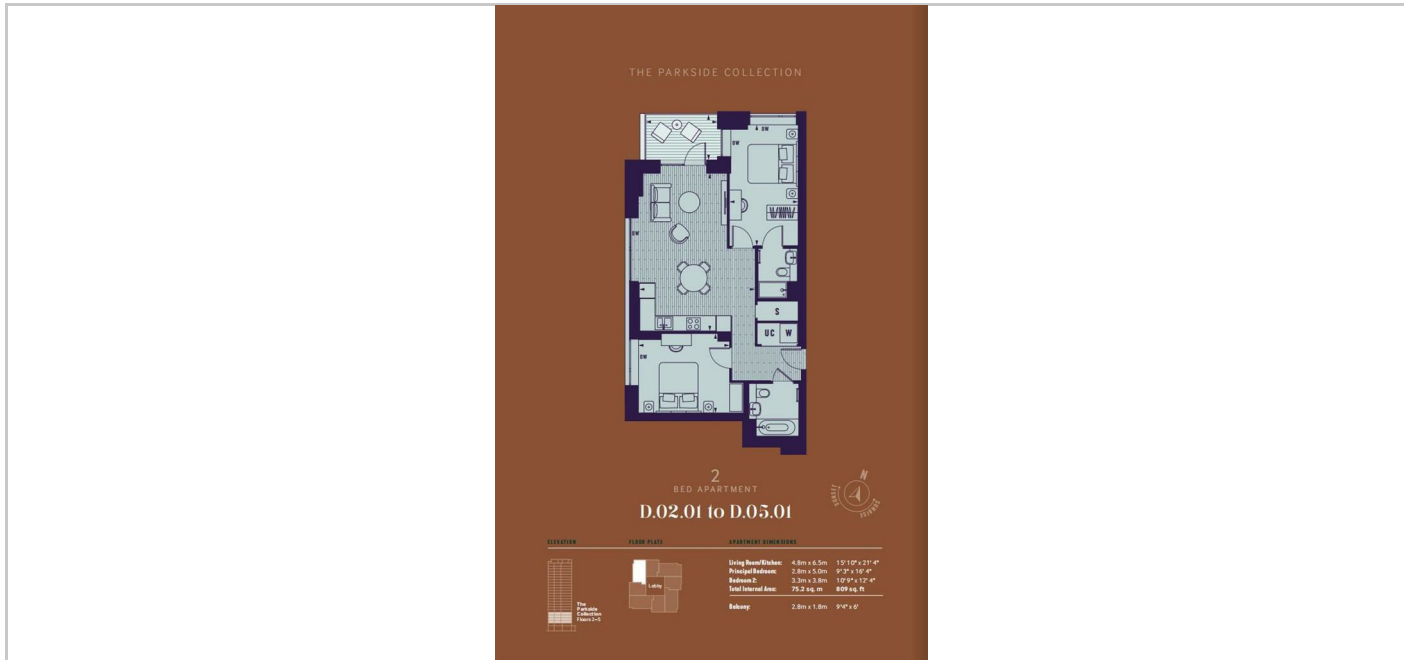

SITUATION

Directions