



**GATEWAY CAPITAL  
PROPERTY**

LONDON'S PROPERTY MANAGEMENT SPECIALISTS



**TO LET**

With a monthly rent of **£3,250 Per month** Call Andrew on **020 7461 1144**





- Big balcony
- 24 hour concierge
- Newly built in zone 2
- Residents' swimming pool & gym
- 8 minutes tube to King's Cross
- Unique waterside location and thriving community

## THE PROPERTY

North London's Woodberry Down is an innovative Regeneration Project, set in 64 acres adjacent to the spectacular natural surroundings of two existing reservoirs and Finsbury Park, all within a short distance of Central London and the City.

This bright and spacious 2-bed flat with a huge balcony, also benefits from the underfloor heating, open-plan kitchen, 2 luxury bathrooms, excellent storage and resident's only lounge, 24-hour concierge, swimming pool, gym and spa.

Located only 3 minutes from Manor House Underground Station (Piccadilly line), takes 8 minutes to King's Cross and 20 minutes to the City.

Approximate Gross Internal Area 1028 sq ft – 95 sq m  
 Second Floor Area 918 sq ft – 85 sq m  
 Balcony Area 110 sq ft – 10 sq m

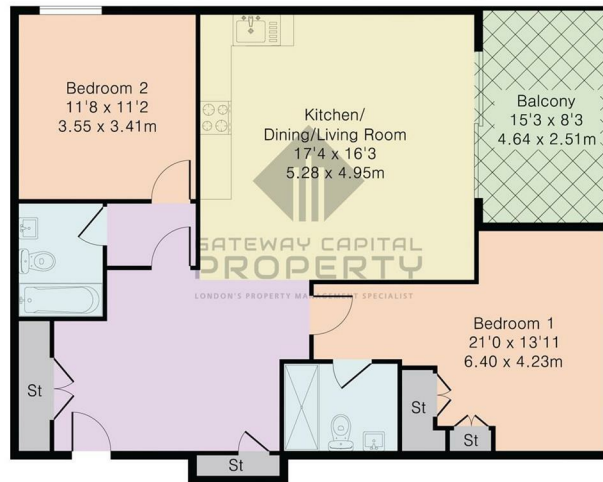

Second Floor

## SITUATION

## Directions