



Tel: 02392864555

30 Landport Terrace, Southsea PO1
2RG

hello@soanegroup.co.uk

Greetham Street, Portsmouth, PO5

£1,150 PCM





Soane are pleased to offer this two bedroom house located within close proximity to Portsmouth City Centre and the University.

Internally the property is in good order and consists of entrance hallway, separate kitchen with appliances, large living area with double patio doors leading out to the rear garden, upstairs there are two double bedrooms and a bathroom with a white suite and shower.

No Pets.

Close to Portsmouth & Southsea train station and City Centre.

Offered Unfurnished.



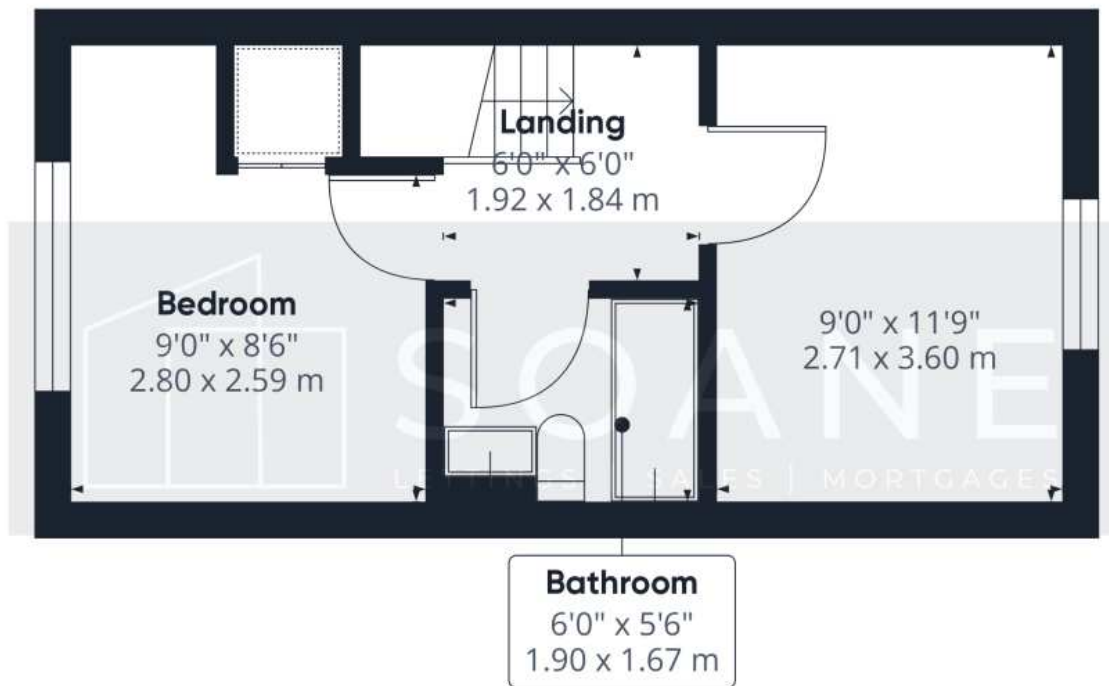
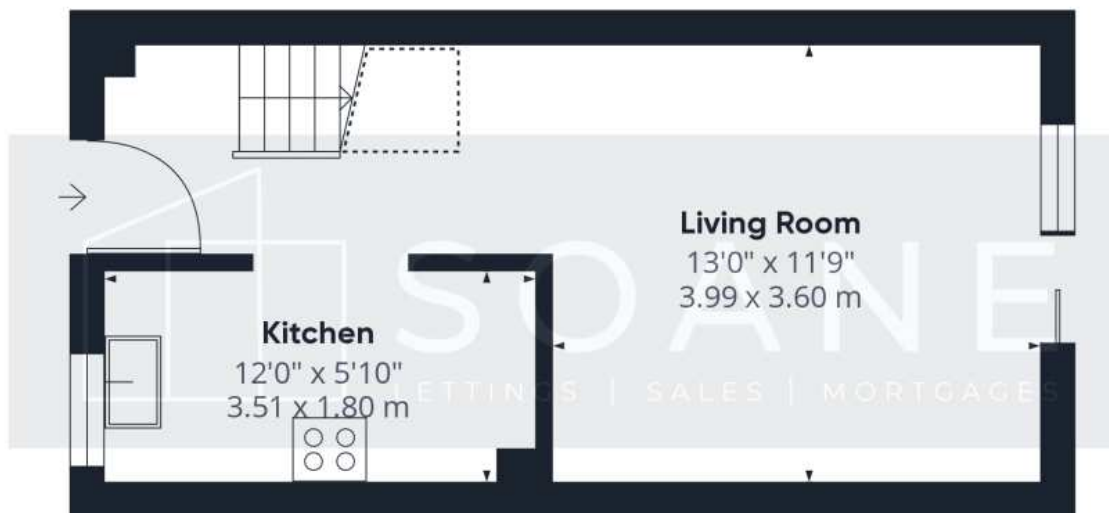

Approximate total area⁽¹⁾

553.48 ft²

51.42 m²

Reduced headroom

13.78 ft²

1.28 m²

(1) Excluding balconies and terraces

 Reduced headroom
(below 1.5m/4.92ft)

While every attempt has been made to ensure accuracy, all measurements are approximate, not to scale. This floor plan is for illustrative purposes only.

GIRAFFE360



SOANE

LETTINGS | SALES | MORTGAGES