



Tel: 02392864555

30 Landport Terrace, Southsea PO1  
2RG

[hello@soanegroup.co.uk](mailto:hello@soanegroup.co.uk)

**Hamburg House, Cross Street**

**GUIDE PRICE £240,000**





Soane are delighted to offer this contemporary fifth floor apartment in the desired location of Admiralty Quarter on Queen Street, Portsmouth and within walking distance to and shops of Gunwharf Quays.

The property consists of a lounge/diner with views over the gardens and historic dockyard and doors onto the balcony.

Contemporary kitchen with integrated appliances including dishwasher, family bathroom with mixer shower, two double bedrooms, one with built in wardrobes and an en-suite to the master bedroom. The apartment also comes with one allocated parking space and a large additional storage area.



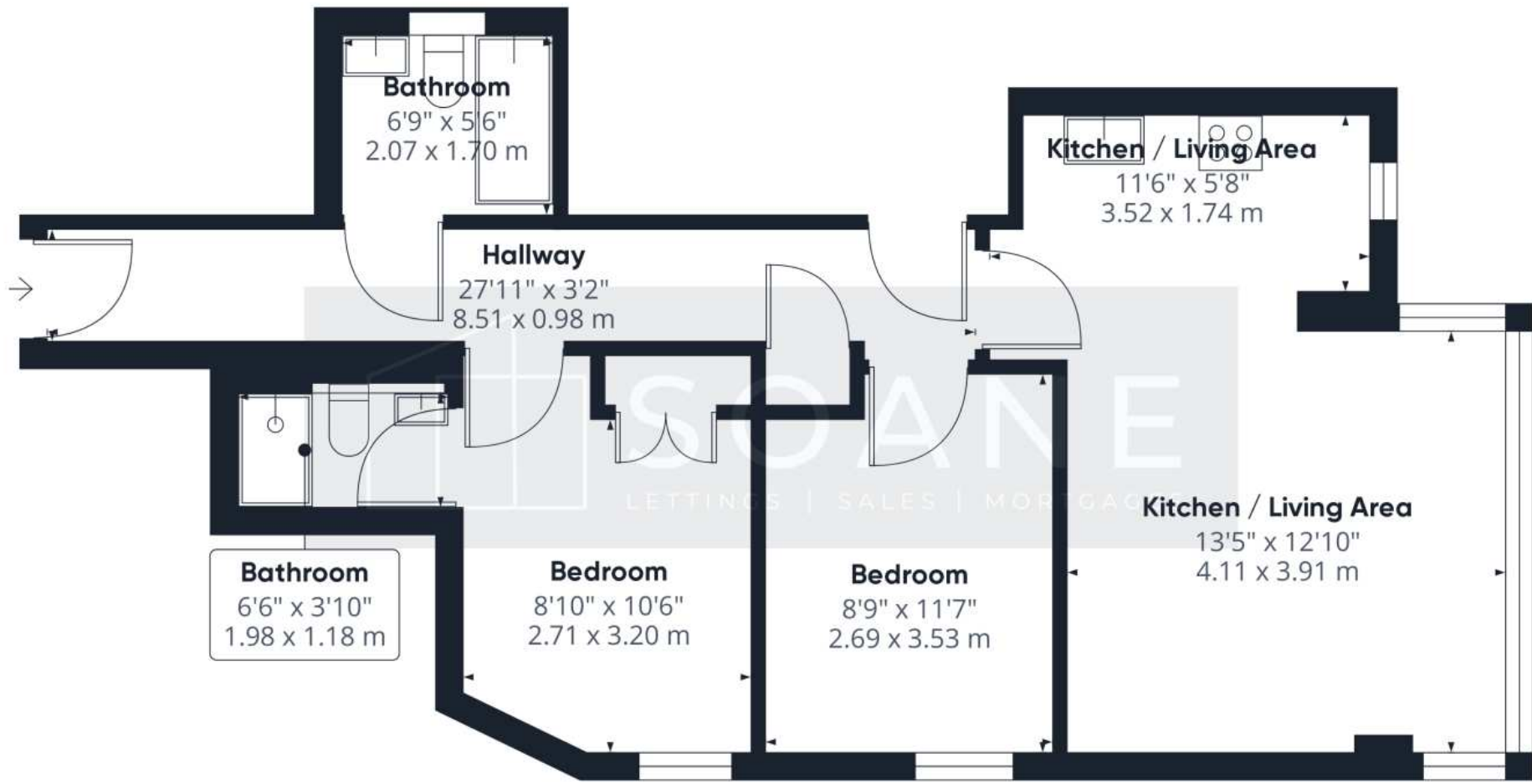

**Approximate total area<sup>(1)</sup>**  
609.99 ft<sup>2</sup>  
56.67 m<sup>2</sup>

(1) Excluding balconies and terraces

While every attempt has been made to ensure accuracy, all measurements are approximate, not to scale. This floor plan is for illustrative purposes only.

Calculations are based on RICS IPMS 3C standard.



SOANE

LETTINGS | SALES | MORTGAGES