



Tel: 02392864555

30 Landport Terrace, Southsea PO1
2RG

hello@soanegroup.co.uk

Hamburg House, Cross Street

ASKING PRICE £200,000



Soane Group are delighted to offer this luxury one bedroom apartment in Hamburg House which is located within the Admiralty Quarter Complex.

This is a modern apartment boasting spacious living throughout with one double bedroom, an open plan lounge and kitchen with appliances including a washer/dryer and a bathroom including white suite and shower.



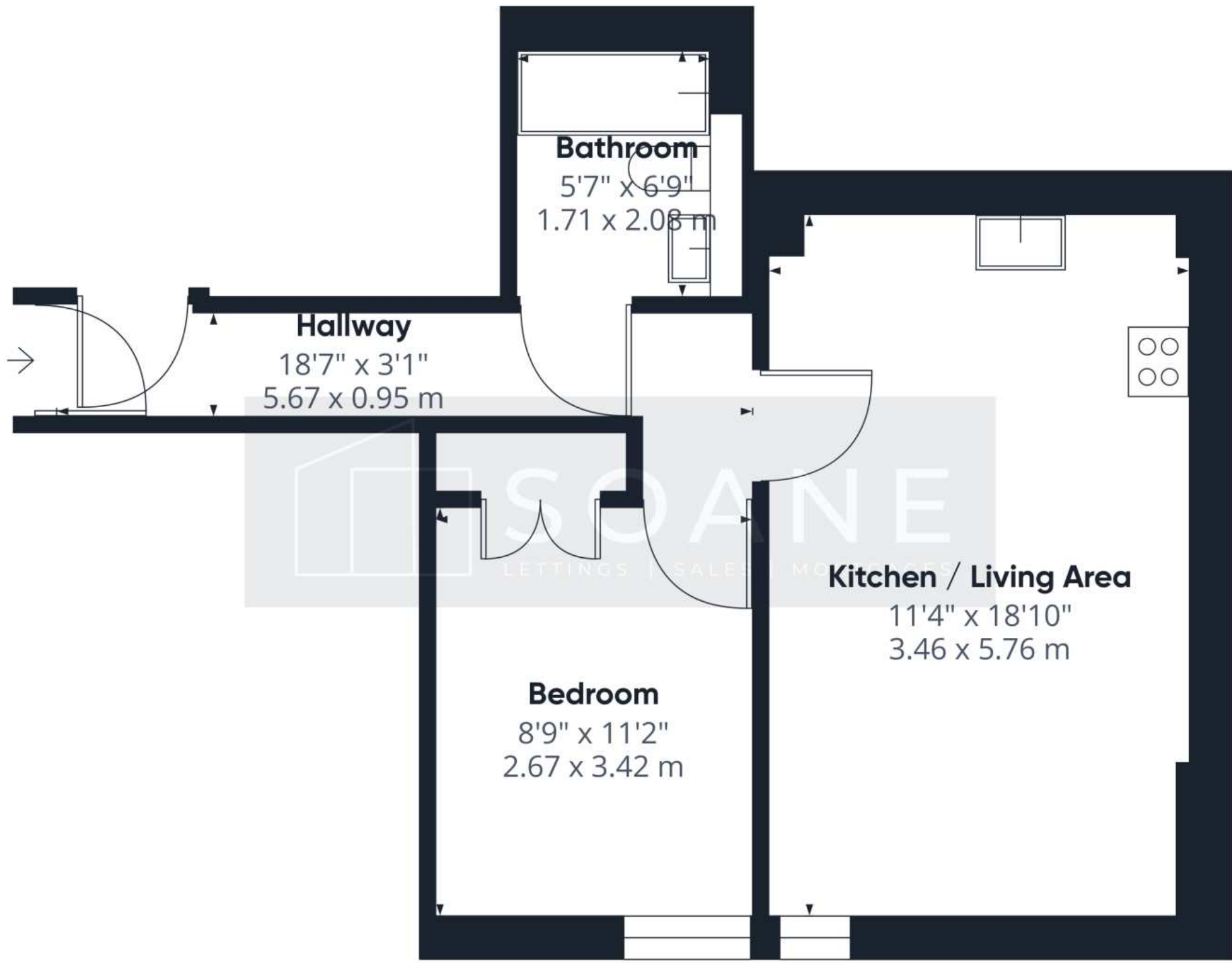

Approximate total area⁽¹⁾
426.04 ft²
39.58 m²

(1) Excluding balconies and terraces

While every attempt has been made to ensure accuracy, all measurements are approximate, not to scale. This floor plan is for illustrative purposes only.

Calculations are based on RICS IPMS 3C standard.



SOANE

LETTINGS | SALES | MORTGAGES