



Tel: 02392864555
30 Landport Terrace, Southsea PO1
2RG

hello@soanegroup.co.uk

Hamburg House, Cross Street

£250,000





We are delighted to present this two bedroom apartment in the very popular Admiralty Quarter.

Boasting two double bedrooms, with en-suite to the master bedroom, modern style kitchen and family bathroom. The lounge also benefits from double doors over looking the well presented courtyards.

Ideally situated within the Historic Portsmouth area and with easy access to the major transport routes. Other benefits include lift to all floors, secure door entry, 24hr concierge, electric heating and secure allocated car parking space included.



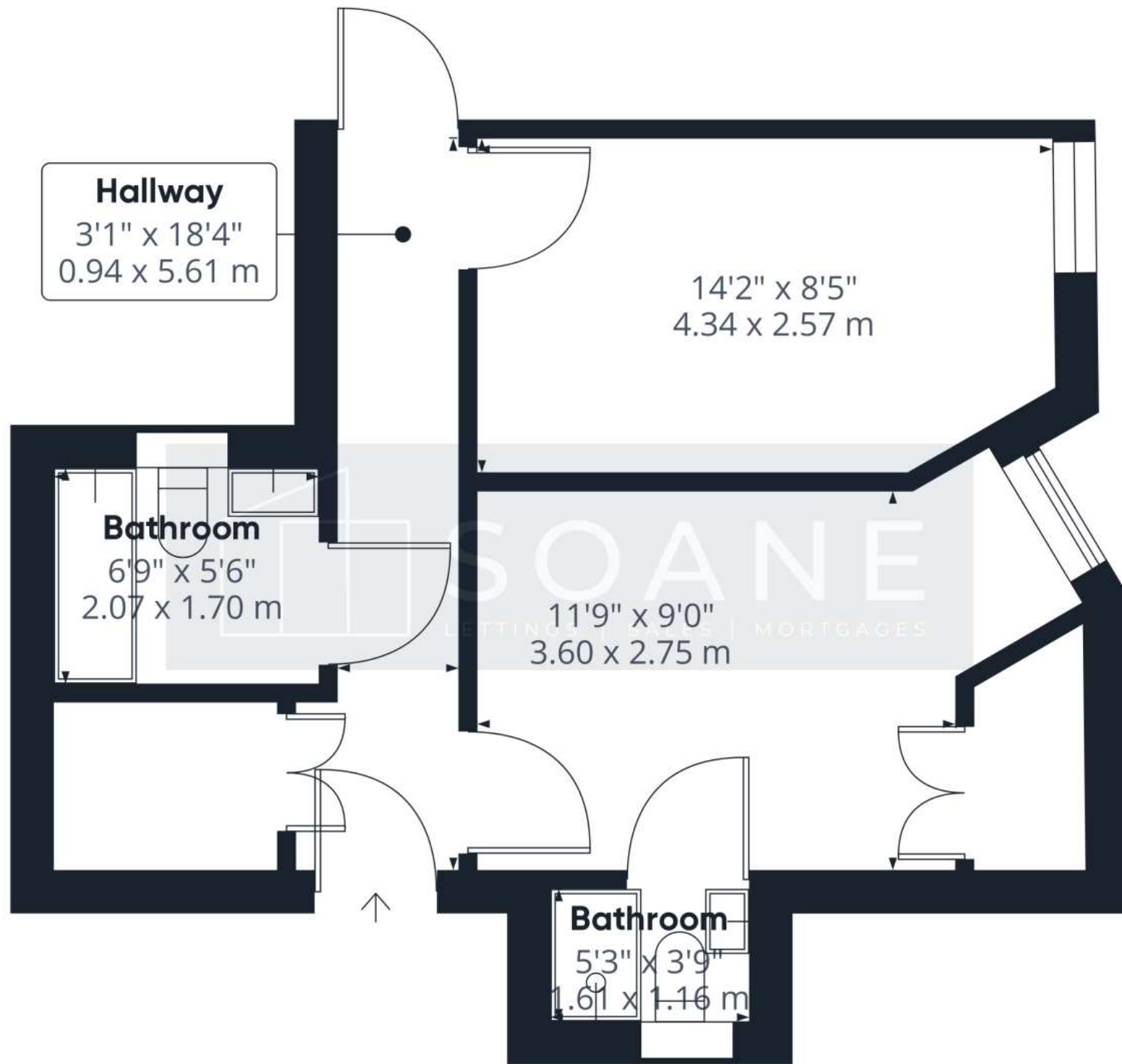

Approximate total area⁽¹⁾
398.37 ft²
37.01 m²

(1) Excluding balconies and terraces

While every attempt has been made to ensure accuracy, all measurements are approximate, not to scale. This floor plan is for illustrative purposes only.

Calculations are based on RICS IPMS 3C standard.



SOANE

LETTINGS | SALES | MORTGAGES