



Tel: 02392864555

30 Landport Terrace, Southsea PO1  
2RG

[hello@soanegroup.co.uk](mailto:hello@soanegroup.co.uk)

**Brunswick House, Queen Street**

**£1,100 PCM**







**Soane are delighted to bring you Brunswick House.**

**Located just around the corner from Gunwharf this purpose built block of apartments are ideal for working professionals being so close to the train station and routes in and out of the city.**

**£1,100 PCM**

**LIFT ACCESS**

**BIKE STORE**

**DOUBLE BEDROOM**

**JULIETTE BALCONY**

**GUNWHARF LOCATION**



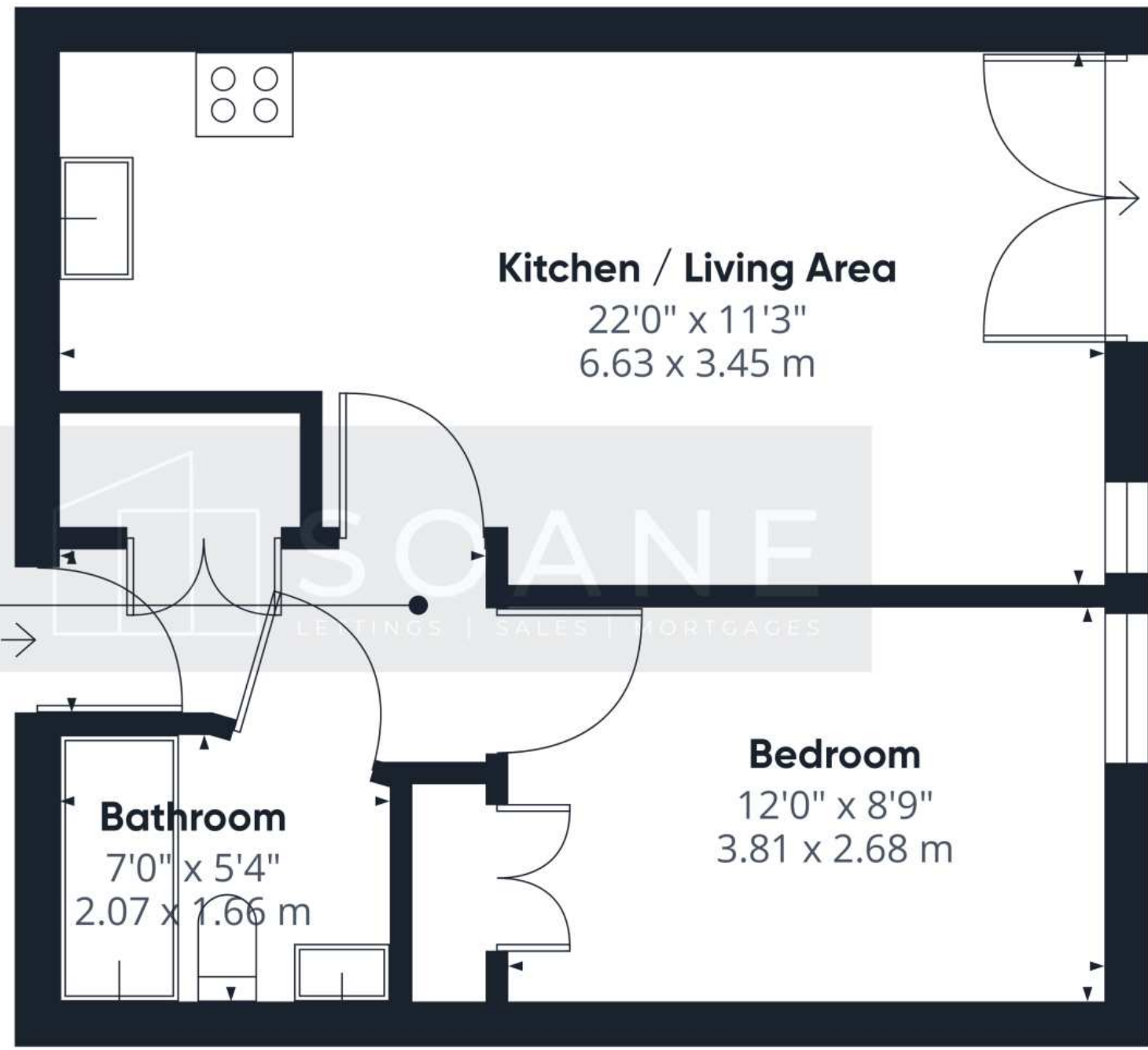

**Hallway**  
9'0" x 3'4"  
2.75 x 1.04 m

**Kitchen / Living Area**  
22'0" x 11'3"  
6.63 x 3.45 m

**Bathroom**  
7'0" x 5'4"  
2.07 x 1.66 m

**Bedroom**  
12'0" x 8'9"  
3.81 x 2.68 m

**Approximate total area<sup>(1)</sup>**  
428.08 ft<sup>2</sup>  
39.77 m<sup>2</sup>

(1) Excluding balconies and terraces

While every attempt has been made to ensure accuracy, all measurements are approximate, not to scale. This floor plan is for illustrative purposes only.



# SOANE

LETTINGS | SALES | MORTGAGES

