



Tel: 02392864555

30 Landport Terrace, Southsea PO1
2RG

hello@soanegroup.co.uk

Cheltenham Court, Winn Road, Southampton

PRICE £230,000





****GARAGE****

Welcome to Cheltenham Court. A spacious two bedroom apartment in a fantastic part of Southampton with a good size lounge and a separate garage.



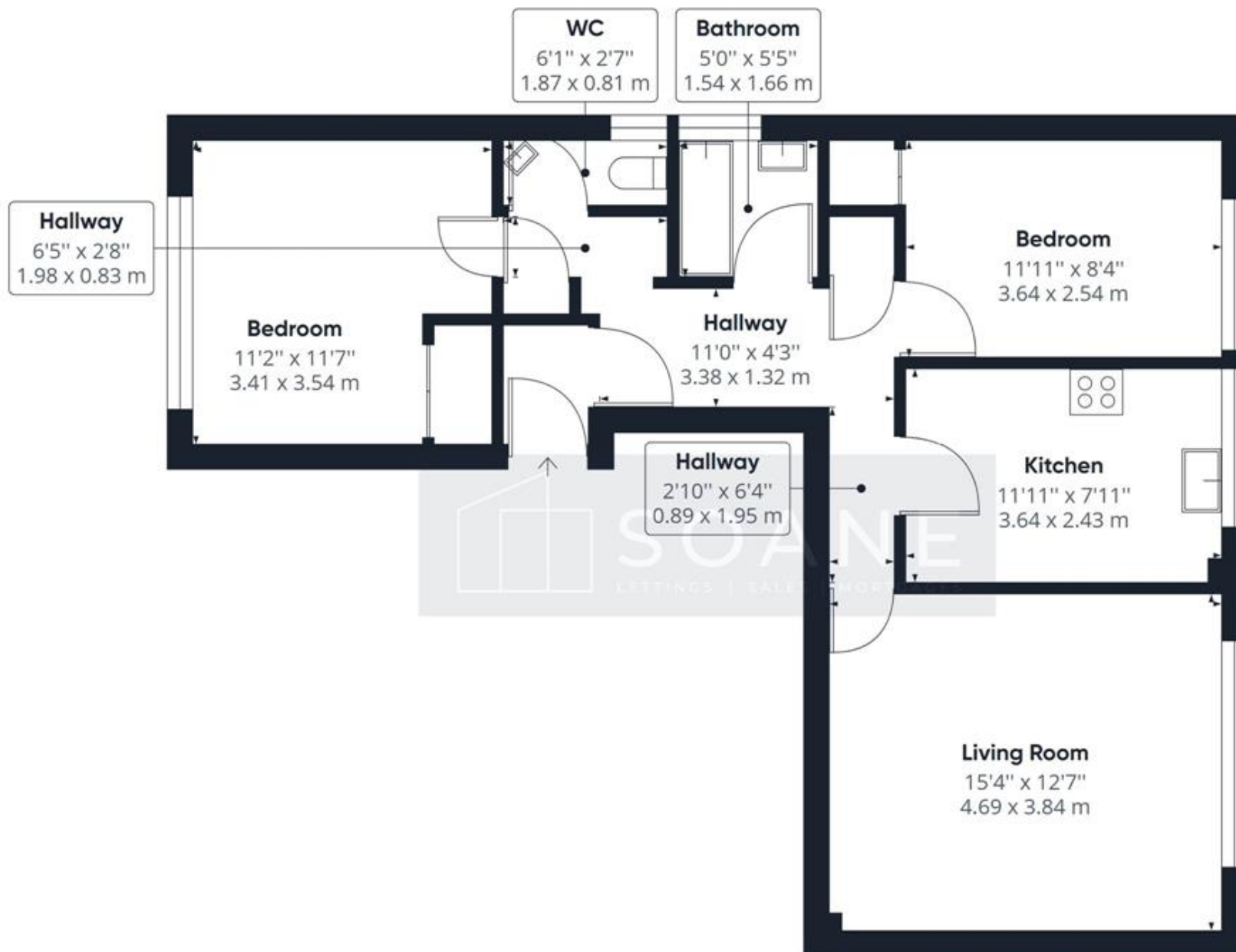

Approximate total area⁽¹⁾

698.19 ft²

64.86 m²

(1) Excluding balconies and terraces

While every attempt has been made to ensure accuracy, all measurements are approximate, not to scale. This floor plan is for illustrative purposes only.

GIRAFFE 360



SOANE

LETTINGS | SALES | MORTGAGES