



SOANE
LETTINGS | SALES | MORTGAGES

 02392864555  hello@soanegroup.co.uk  soanegroup.co.uk



**Harbour Ridge, Queen Street
Offers in excess of £170,000**

Do you need to sell? Book a free valuation today.



SOANE

LETTINGS | SALES | MORTGAGES



02392864555



hello@soanegroup.co.uk



soanegroup.co.uk



Sell your property with Soane, book a free valuation today



SOANE

LETTINGS | SALES | MORTGAGES



02392864555



hello@soanegroup.co.uk



soanegroup.co.uk



Sell your property with Soane, book a free valuation today



SOANE

LETTINGS | SALES | MORTGAGES

 02392864555  hello@soanegroup.co.uk  soanegroup.co.uk



2 Bedrooms



1 Bathroom



1 Reception



Property Type: Flat



Tenure: Leasehold

Council Tax Banding : C

Service Charge: 164.70 pcm

This purpose-built 2-bedroom first floor apartment is close to Gunwharf Quays, the Dockyard, Portsmouth University and City Centre making it a fantastic investment or first time buy. The spacious accommodation comprises hallway, two generous double bedrooms (one with ensuite shower room), another bathroom with bath & shower, fitted kitchen with doors to large lounge with patio doors onto the Juliet balcony enjoying views over the adjacent park. The building is well maintained and has an elevator to all floors as well as the staircase. There is a bike rack in the basement car park and security entry to the block. Water rates are included within the service charge. The flat has neutral decor, fitted throughout with Kardean luxury vinyl flooring and benefits from gas central heating and upvc double glazing. The building also has an EWS1 certificate, being compliant with all current fire regulations.

Sell your property with Soane, book a free valuation today



SOANE

LETTINGS | SALES | MORTGAGES

02392864555 hello@soanegroup.co.uk soanegroup.co.uk

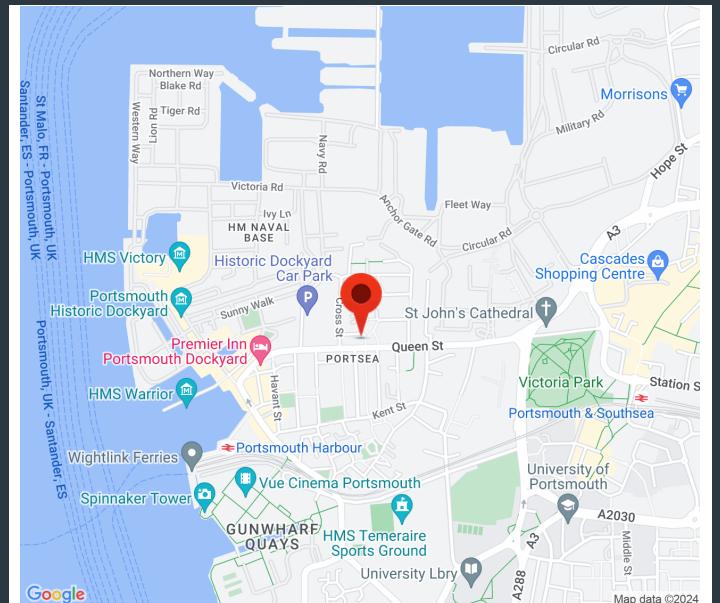
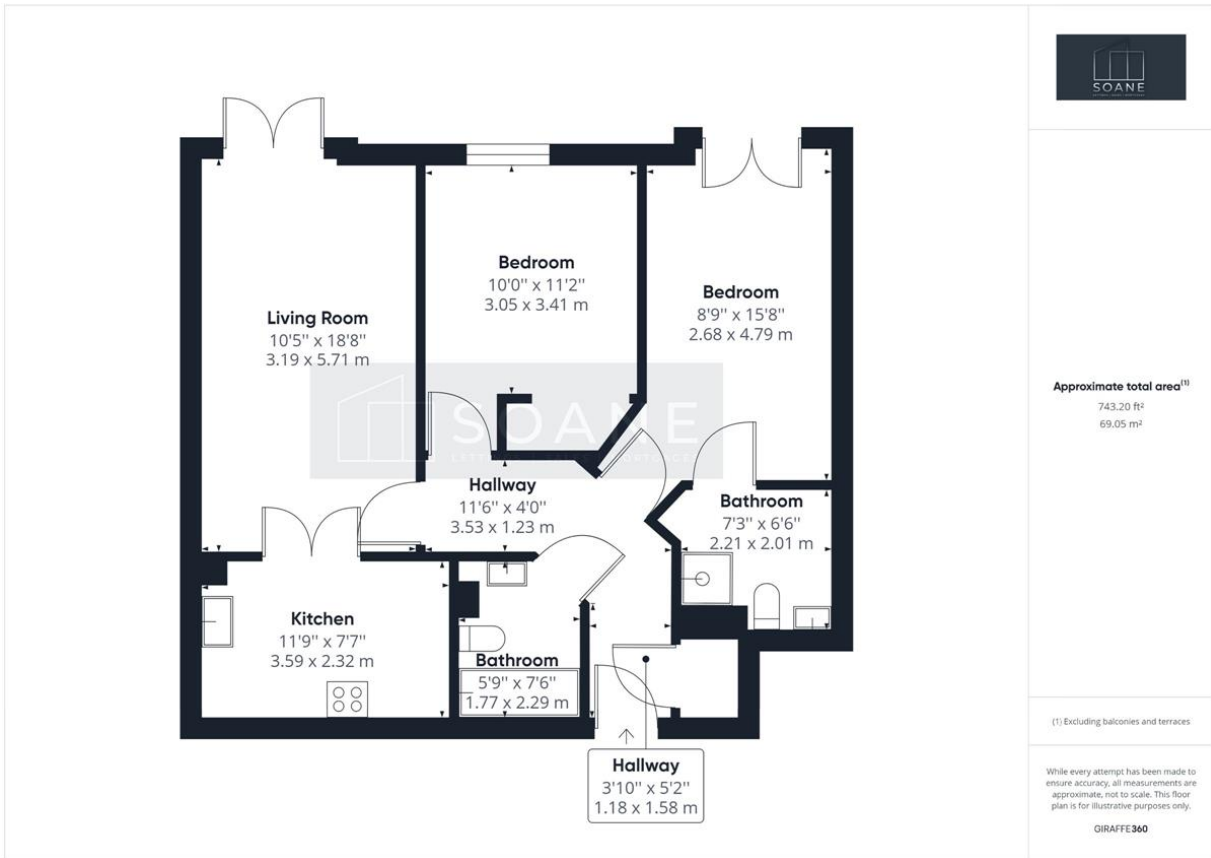

Sell your property with Soane, book a free valuation today



SOANE
LETTINGS | SALES | MORTGAGES

 02392864555  hello@soanegroup.co.uk  soanegroup.co.uk

PROPERTY SALES

Give your home the attention it deserves and sell with Soane. Our team of property professionals will get you the best price for your property and support you all the way to completion.

PROPERTY MANAGEMENT

Every landlord wants good tenants, reliable rent, and a well-maintained property. Our property managers are experts in property and tenancy management.

MORTGAGE ADVICE

Soane Property Group is the proud owner of the Mortgage Advice Bureau in Fareham. We'll connect you with an expert Mortgage Adviser to talk through your options.