



## Newark Road

North Hykeham, Lincoln, LN6 8NY

£84,950



Nestled in the charming area of North Hykeham, Lincoln, this delightful park home on Newark Road offers a serene and comfortable living experience, particularly suited for those aged over 55.

The property features two inviting reception rooms, two well-proportioned bedrooms and a well-appointed bathroom, ensuring convenience and comfort for daily living. Additionally, there is parking available for one vehicle, making it easy for residents to come and go as they please.

Set within a friendly residential site, this property not only offers a lovely home but also a sense of community, ideal for those looking to enjoy their golden years in a tranquil environment. With its appealing layout and prime location, this park home is a wonderful opportunity for anyone seeking a low-maintenance lifestyle in a welcoming neighbourhood.



## Description

A delightful two bed park home situated in a popular location consisting of a lounge, diner, kitchen, two bedrooms and a bathroom.

### Kitchen 10'0" x 8'4" (3.06m x 2.56m)

The kitchen includes a range of wall and base units, front facing double glazed window, electric oven with gas hob, cupboard housing the boiler, sink with side drainer and mixer tap. There is also space for a washing machine, dishwasher and fridge freezer.

### Dining Room 11'6" x 10'7" (3.53m x 3.23m)

The dining room consists of laminate flooring, radiator and a side facing double glazed window.

### Lounge 17'6" x 10'11" (5.35m x 3.34m )

The lounge includes a electric fire with a feature fireplace, carpet, two radiators, a side facing double glazed bay window, a rear facing double glazed window and a door leading onto the decking at the rear.

### Bedroom One 10'7" x 9'7" (3.23m x 2.93m)

Bedroom one is a double room with a carpet, fitted dressing table, fitted wardrobes and drawers, radiator and a front facing double glazed window.

### Bedroom Two 9'6" x 8'1" (2.92m x 2.48m )

Bedroom two is a double room with a carpet, radiator, fitted wardrobes and a rear facing double glazed window.

## Bathroom

The bathroom is a three piece suite comprising of a hand wash basin, panelled bath with shower, WC, tiled walls, radiator and a rear facing double glazed window.

## Outside

To the front of the property is stairs leading to the door into the kitchen.

To the rear of the property there is a decked seating area with a gravelled garden and outbuilding. There is also off street parking available.

## Disclaimer

1. MONEY LAUNDERING REGULATIONS: Intending purchasers will be asked to produce identification documentation at a later stage and we would ask for your co-operation in order that there will be no delay in agreeing the sale.

2. General: While we endeavour to make our sales particulars fair, accurate and reliable, they are only a general guide to the property and, accordingly, if there is any point which is of particular importance to you, please contact the office and we will be pleased to check the position for you, especially if you are contemplating travelling some distance to view the property.

3. Measurements: These approximate room sizes are only intended as general guidance. You must verify the dimensions carefully before ordering carpets or any built-in furniture.

4. Services: Please note we have not tested the services or any of the equipment or appliances in this property, accordingly we strongly advise prospective buyers to commission their own survey or service reports before finalising their offer to purchase.

5. THESE PARTICULARS ARE ISSUED IN GOOD FAITH BUT DO NOT CONSTITUTE REPRESENTATIONS OF FACT OR FORM PART OF ANY OFFER OR CONTRACT. THE MATTERS REFERRED TO IN THESE PARTICULARS SHOULD BE INDEPENDENTLY VERIFIED BY PROSPECTIVE BUYERS OR TENANTS. NEITHER Clark Estates OR ANY OF ITS EMPLOYEES OR AGENTS HAS ANY AUTHORITY TO MAKE OR GIVE ANY REPRESENTATION OR WARRANTY WHATEVER IN RELATION TO THIS PROPERTY.

## Area Map

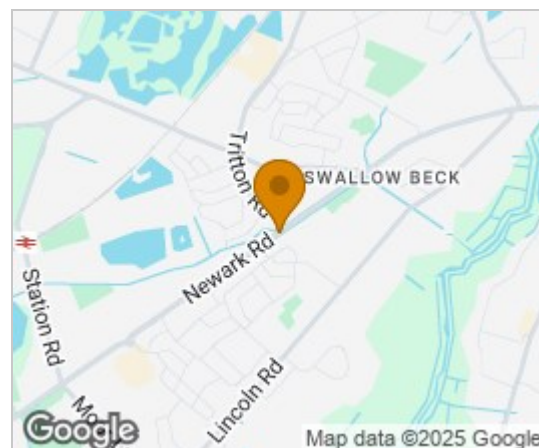

## Floor Plans

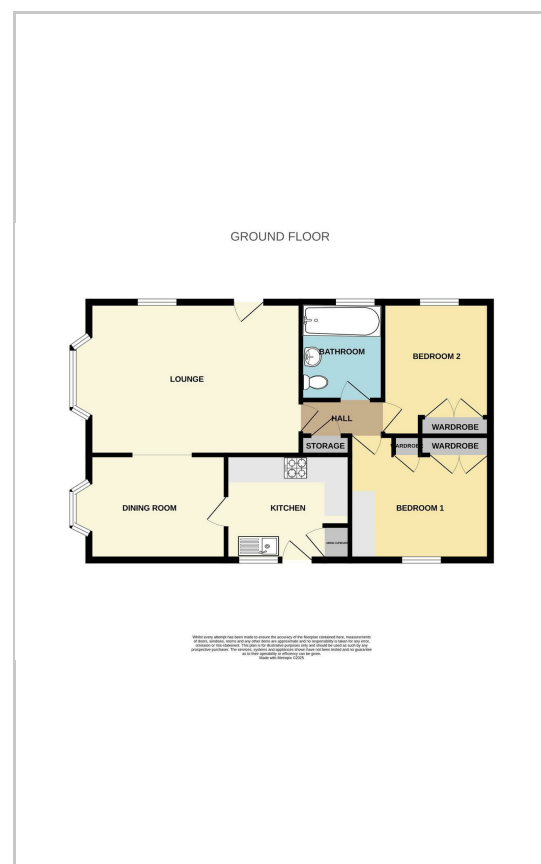

## Energy Efficiency Graph

These particulars, whilst believed to be accurate are set out as a general outline only for guidance and do not constitute any part of an offer or contract. Intending purchasers should not rely on them as statements of representation of fact, but must satisfy themselves by inspection or otherwise as to their accuracy. No person in this firms employment has the authority to make or give any representation or warranty in respect of the property.

14-16 Eldon Street, Tuxford, NG22 0LH

Tel: 01777 801 901 Email: dawn@clark-estates.co.uk www.clark-estates.co.uk