

Holdere

A Modern Estate Agent



6 Dulverton Close

, Loughborough, LE11 3SN

£299,950

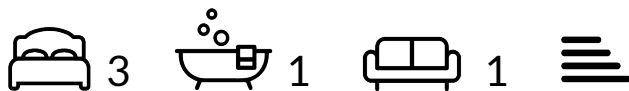

6 Dulverton Close

, Loughborough, LE11 3SN

£299,950



We are delighted to offer for sale this three bedroom detached home, offered for sale with no onward chain and occupying a pleasant cul-de-sac location within the school catchment of Holywell primary school.

The property itself benefits from gas central heating, double glazing and has accommodation which briefly comprises a porch, reception hallway, lounge diner and kitchen. To the first floor there are three well proportioned bedrooms and a recently refurbished bathroom.

Outside there are gardens to the front and rear with a driveway providing ample off road parking and access to the garage.

An Internal viewing is essential to appreciate the accommodation on offer.



Road Map



Hybrid Map



Terrain Map

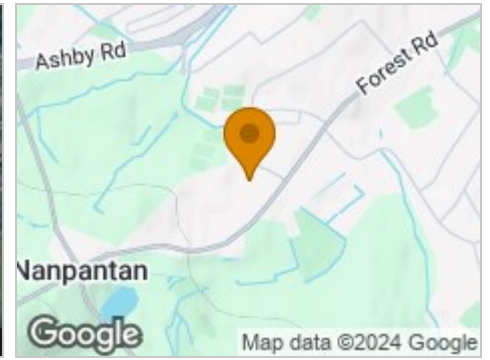

Floor Plan

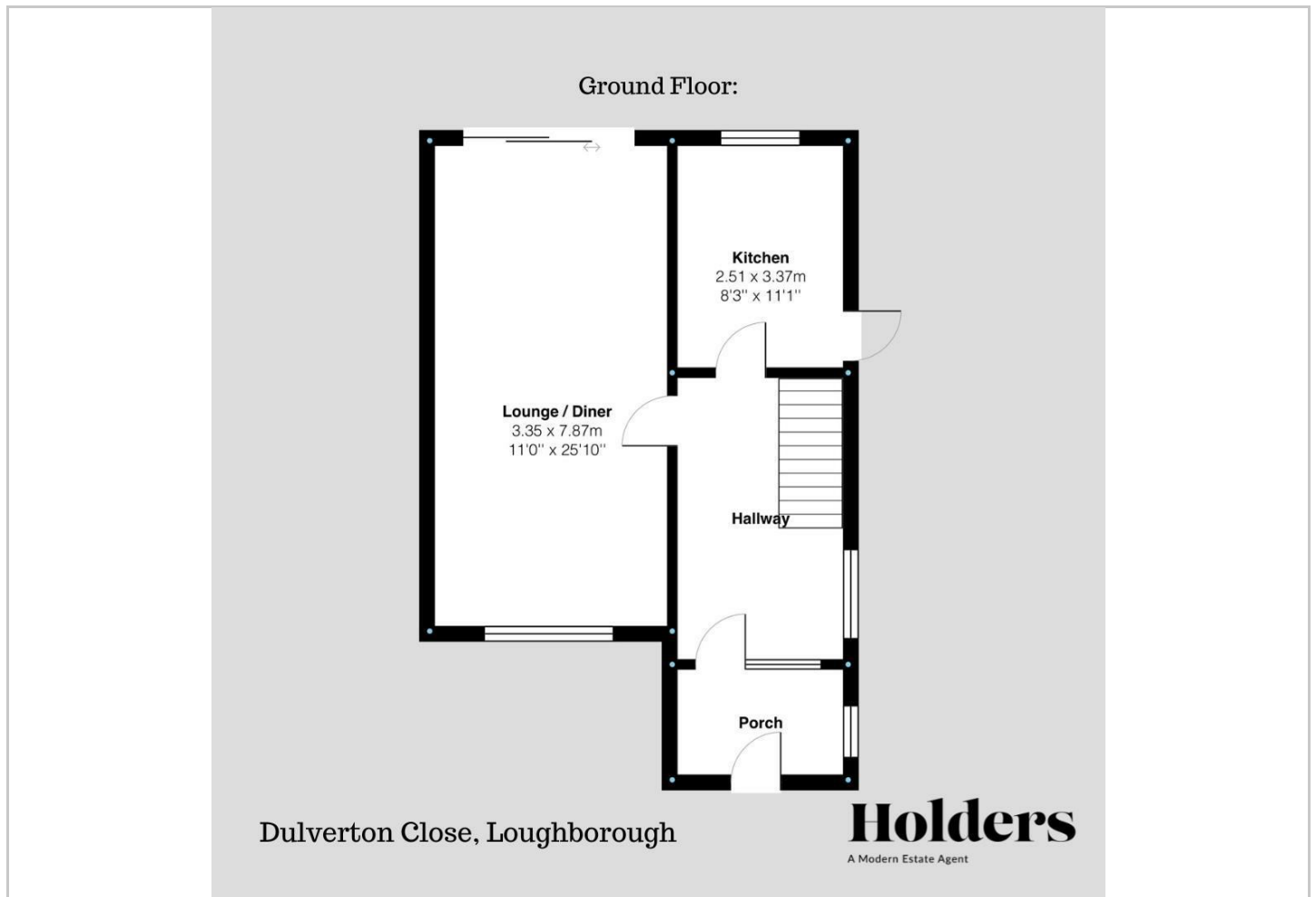

Viewing

Please contact our Holdings - Loughborough Office on 01509 451100 if you wish to arrange a viewing appointment for this property or require further information.

Energy Efficiency Graph

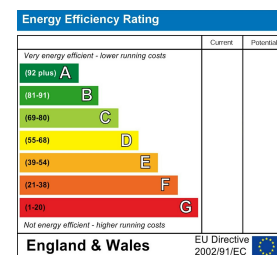

These particulars, whilst believed to be accurate are set out as a general outline only for guidance and do not constitute any part of an offer or contract. Intending purchasers should not rely on them as statements of representation of fact, but must satisfy themselves by inspection or otherwise as to their accuracy. No person in this firm's employment has the authority to make or give any representation or warranty in respect of the property.