

Holdings

A Modern Estate Agent



Plot 44 Ternouth Close

Loughborough, Loughborough, LE12 5DU

£444,995

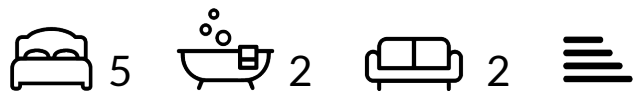

Plot 44 Ternouth Close

Loughborough, Loughborough, LE12 5DU

£444,995



The Warwick is an elegant and spacious five-bedroom detached family home that boasts a stunning design with a convenient integral garage. The ground floor of this magnificent property features a generous kitchen/dining room, complete with French doors that lead out to the beautiful garden, allowing for seamless indoor-outdoor living. Additionally, there is a convenient downstairs WC, and a charming living room that overlooks the front of the house.

As you make your way up the central landing, you'll discover the five well-appointed bedrooms, including one that offers the luxury of an en-suite bathroom. The central landing serves as the heart of the home, providing easy access to all of the bedrooms and the family bathroom, making it the perfect hub for family life. The Warwick truly offers a perfect blend of style, functionality, and comfort for modern family living.



Road Map



Hybrid Map



Terrain Map



Floor Plan

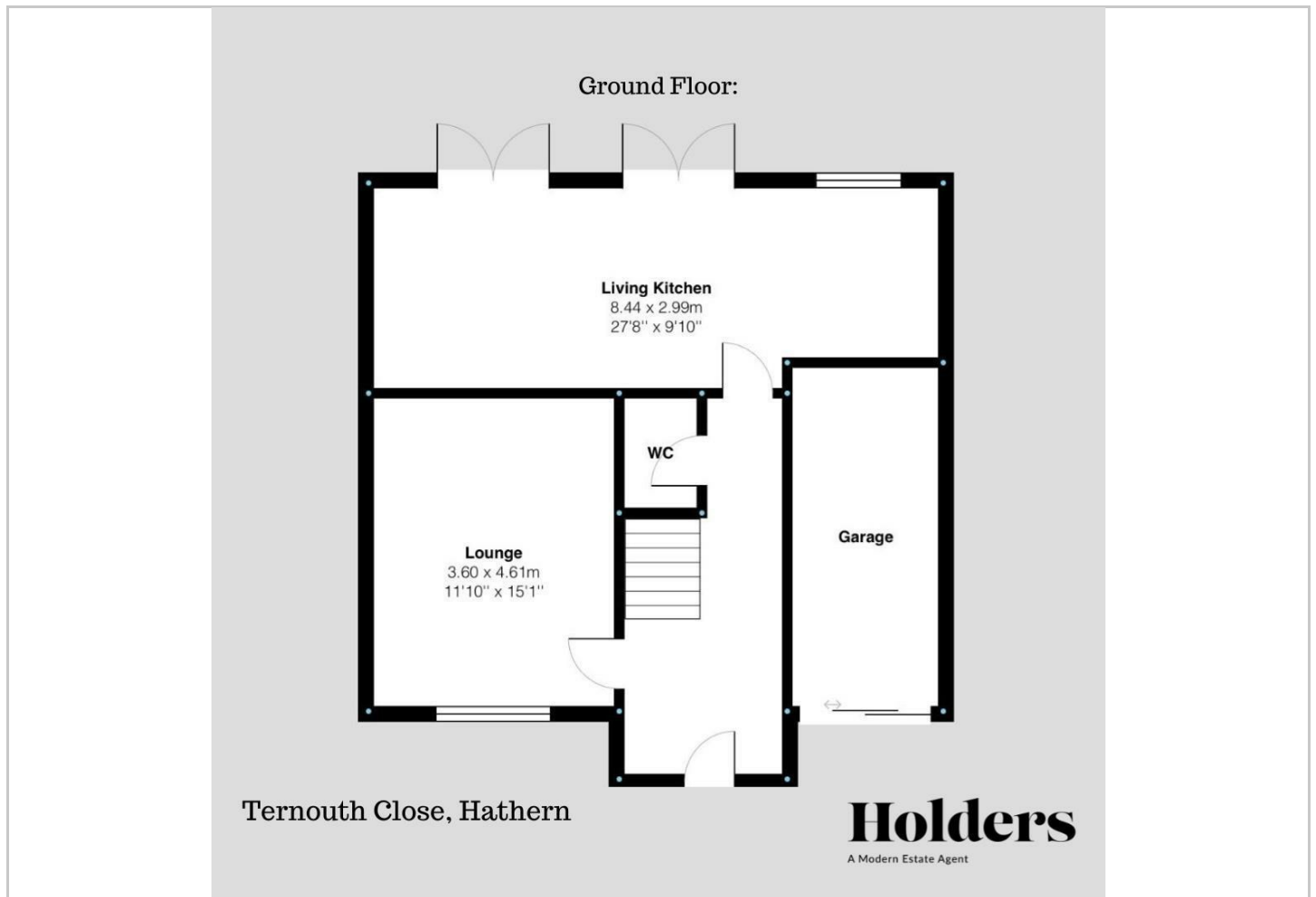

Viewing

Please contact our Holdings - Loughborough Office on 01509 451100 if you wish to arrange a viewing appointment for this property or require further information.

Energy Efficiency Graph

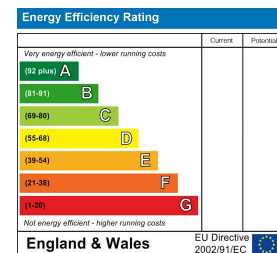

These particulars, whilst believed to be accurate are set out as a general outline only for guidance and do not constitute any part of an offer or contract. Intending purchasers should not rely on them as statements of representation of fact, but must satisfy themselves by inspection or otherwise as to their accuracy. No person in this firm's employment has the authority to make or give any representation or warranty in respect of the property.