

Holdings

A Modern Estate Agent



29 John Boden Way

, Loughborough, LE11 2BB

£460,000

A great opportunity to acquire this four double bedroom detached family home set in a tucked away cul-de-sac position. Complete with an abundance of living space arranged over two floors, aspects of open plan living, south facing rear garden, and NHBC warranty remaining - what's not to love!

Viewing

Please contact our Holdings - Loughborough Office on 01509 451100 if you wish to arrange a viewing appointment for this property or require further information.

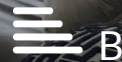

Floor Plan

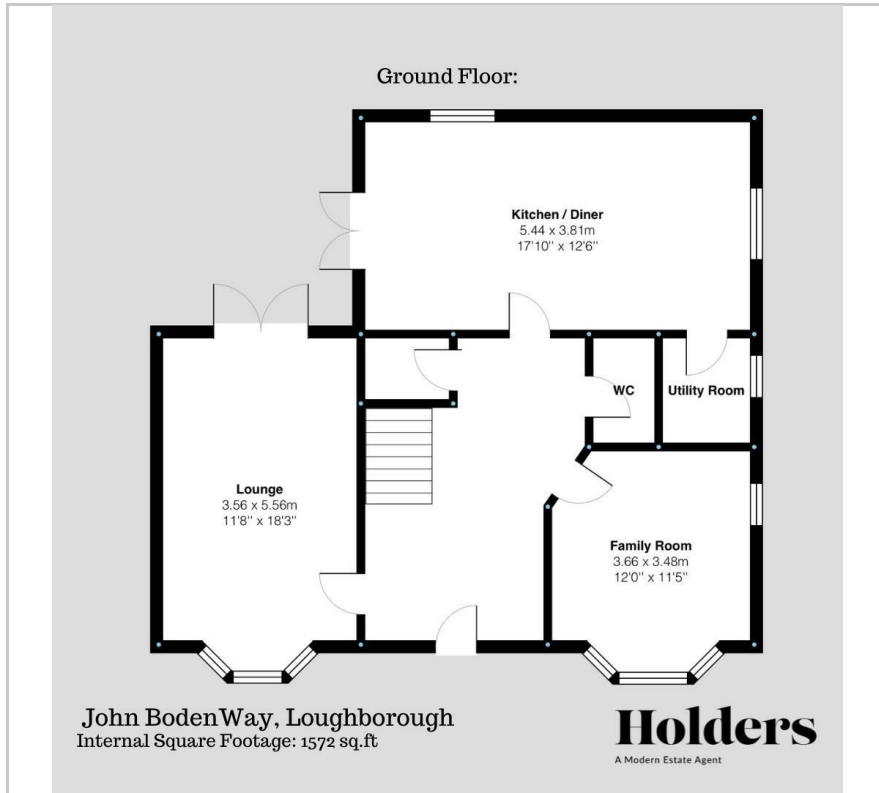

Area Map



Energy Efficiency Graph

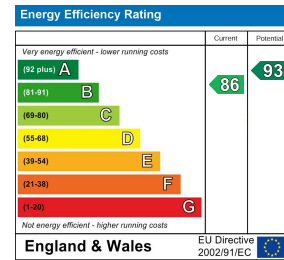

These particulars, whilst believed to be accurate are set out as a general outline only for guidance and do not constitute any part of an offer or contract. Intending purchasers should not rely on them as statements of representation of fact, but must satisfy themselves by inspection or otherwise as to their accuracy. No person in this firm's employment has the authority to make or give any representation or warranty in respect of the property.