





Winchester, SO22

Guide Price £300,000

🛏 2 🪑 1 🛋 1



## **AN IMMACULATE AND SOPHISTICATED CITY RETREAT - WITH PARKING AND WONDERFUL SKYLINE VIEWS OF HISTORIC WINCHESTER**

Ideally positioned just moments from central amenities and the train station, this beautifully refurbished and enviable Grade II listed two-bedroom top-floor apartment offers the perfect pied-à-terre or urban retreat in the heart of Winchester.

Set within an elegant, Landmark period building, the apartment has been thoughtfully updated to blend contemporary style with classic charm. The interiors boast neutral tones and stylish décor throughout, creating a calm and sophisticated living space.

The spacious dual-aspect lounge is a standout feature, flooded with natural light and anchored by a stunning open fireplace with an ornate wooden surround, perfect for relaxing or entertaining.

A newly refitted kitchen combines form and function with sleek grey worktops and ample modern white cabinetry offering plenty of storage.

The modern and smart bathroom is finished to a high standard, providing a clean and calming space.

There are two well-proportioned bedrooms, including a generously sized principal bedroom that benefits from fitted wardrobes, integrated shelving, and a convenient sink unit.

Every window offers fabulous elevated views across the city, framing Winchester's skyline from every angle.

Additional features include allocated parking, a rare and highly sought-after commodity in this central location.

**This immaculate apartment offers a unique opportunity to enjoy refined city living with character, style, and comfort.**





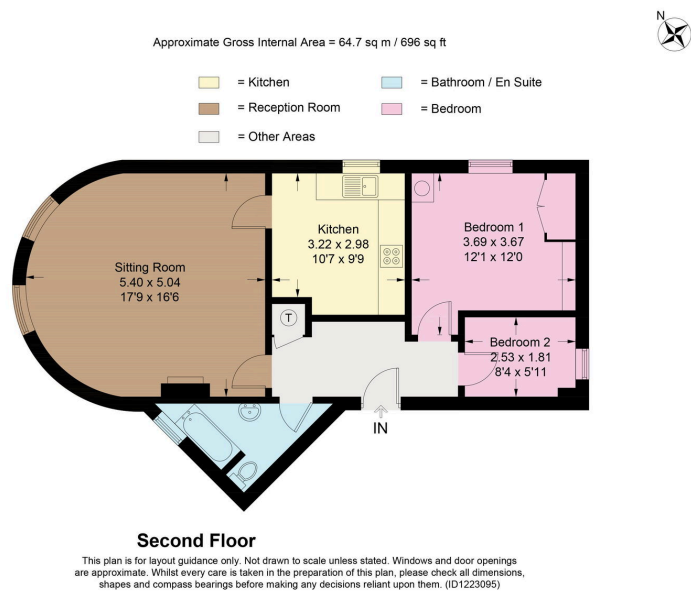

- A Smart And Sophisticated City Apartment
- Top Floor Position With Wonderful Skyline City Views Of Winchester
- Newly Refitted Kitchen
- Spacious Dual Aspect Lounge with Handsome Fireplace
- Immaculately Refurbished To a High Standard With Stylish , Neutral Décor Throughout
- Two Elegant Bedrooms
- Smart Modern Bathroom
- No Onward Chain
- Allocated Parking
- Prime Central Location

