



Wright Marshall
Estate Agents

Ash Court King Edward Road Knutsford WA16 0BE



£157,000

1 Princess Street, Knutsford, Cheshire, WA16 6BY
T. 01565 621624
Knutsford@wrightmarshall.co.uk /
Cheshirelettings@wrightmarshall.co.uk



Situated in the heart of Knutsford town centre, this ground floor retirement apartments offers its own private entrance and off road parking, also offering internal access to all the shared facilities of Ash Court. Offered with No Chain we strongly recommend an early internal inspection.

Opposite Booth's supermarket and within walking distance of the high street shops, post office, doctors and cottage hospital

Ground floor over 60's retirement apartment

Private entrance door also an internal doors allows access to all the amenities Ash Court offers including communal lounge and laundry

Courtyard to the front offering off-road parking

Spacious open plan lounge incorporating fitted kitchen

Shower room with walk-in shower, toilet and wash hand basin

Bedroom with fitted wardrobes

Small garden area to the front

No onward chain





453 sq.ft. (42.1 sq.m.) approx.

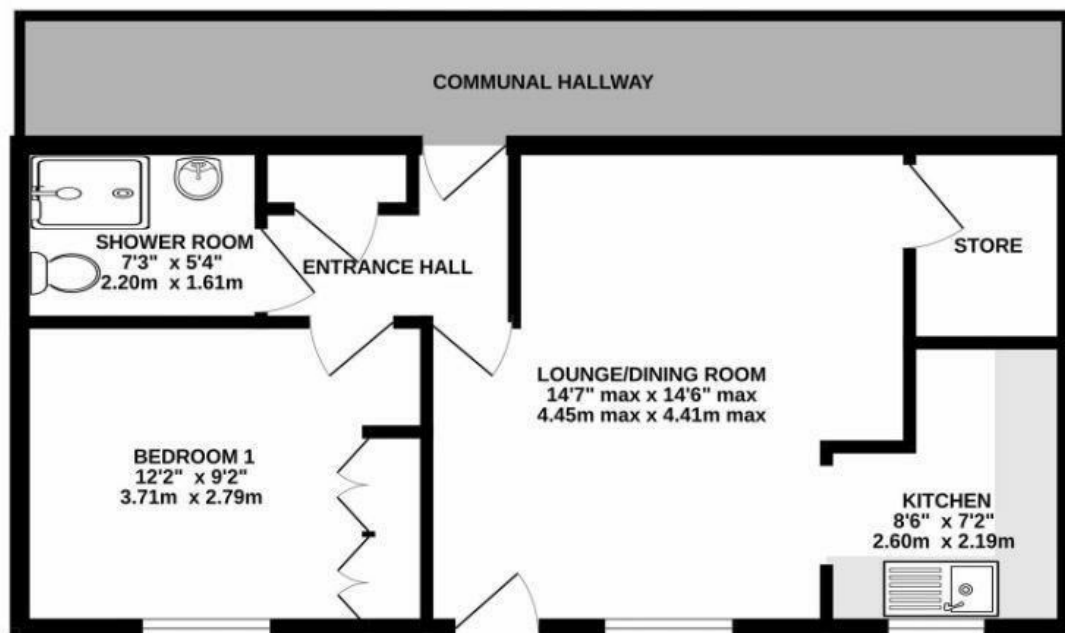

TOTAL FLOOR AREA: 453 sq.ft. (42.1 sq.m.) approx.

Whilst every attempt has been made to ensure the accuracy of the floorplan contained here, measurements of doors, windows, rooms and any other items are approximate and no responsibility is taken for any error, omission or mis-statement. This plan is for illustrative purposes only and should be used as such by any prospective purchaser. The services, systems and appliances shown have not been tested and no guarantee as to their operability or efficiency can be given.
Made with Metroxx ©2024

These particulars, whilst believed to be accurate are set out as a general outline only for guidance and do not constitute any part of an offer or contract. Intending purchasers should not rely on them as statements of representation of fact, but must satisfy themselves by inspection or otherwise as to their accuracy. No person in this firm's employment has the authority to make or give any representation or warranty in respect of the property.