

Belview



Victoria Riverside, Park View, TC-05-003 Dantzig Street
Manchester, M4 2AD

Asking price £260,000



Victoria Riverside, Park View, TC-05-003 Dantzic Street

Manchester, M4 2AD

Stylish City Living at Victoria Riverside

Discover Park View, a striking 26-storey tower with stunning views of City River Park and Manchester's iconic skyline. Part of a £1 billion regeneration project, this development offers modern urban living in a vibrant, up-and-coming area.

Property Details:

Completion: Q1 2025

Tenure: 250 years

Ground Rent: £150 per annum
(reviewed every 25 years)

Service Charge: £1,616.16 per annum
Rental Yield: Strong 7.62% potential

Contemporary Interiors: These bright, open-plan apartments are designed for modern living, with sleek kitchens, dining areas, and lounges that feature large windows offering expansive city and park views. Stylish vinyl plank flooring and a neutral design palette create a sophisticated and welcoming atmosphere.

Peaceful Bedrooms: The bedrooms feature floor-to-ceiling windows that fill the space with light, offering a calm and serene setting.

Panoramic Views: Enjoy dual views of both the city and the park from unique picture-frame windows in each apartment.

Outstanding Amenities:

Landscaped communal gardens





Stylish lobby lounge
Residents' gym
Private lounge and dining area
Why Choose Victoria Riverside? With Manchester's property prices forecast to grow 19.7% by 2027 and rental values to increase 21.6%, this is an exciting investment opportunity.

Excellent Location:

Manchester Victoria: 8-minute walk
Manchester Piccadilly: 8-minute walk
Manchester Airport: 26 minutes by car
London Euston: 2 hours 46 minutes by train

Local Attractions:

Dining: 63 Degrees, Dishoom, The Marble Arch
Shopping: Arndale Centre, Manchester Fort
Supermarkets: Tesco Metro, Aldi

Located just minutes from the city centre, Victoria Riverside offers the perfect balance of urban living with the tranquillity of park-side surroundings.

Contact Us Today to Secure This Amazing Apartment!



Floor Plan

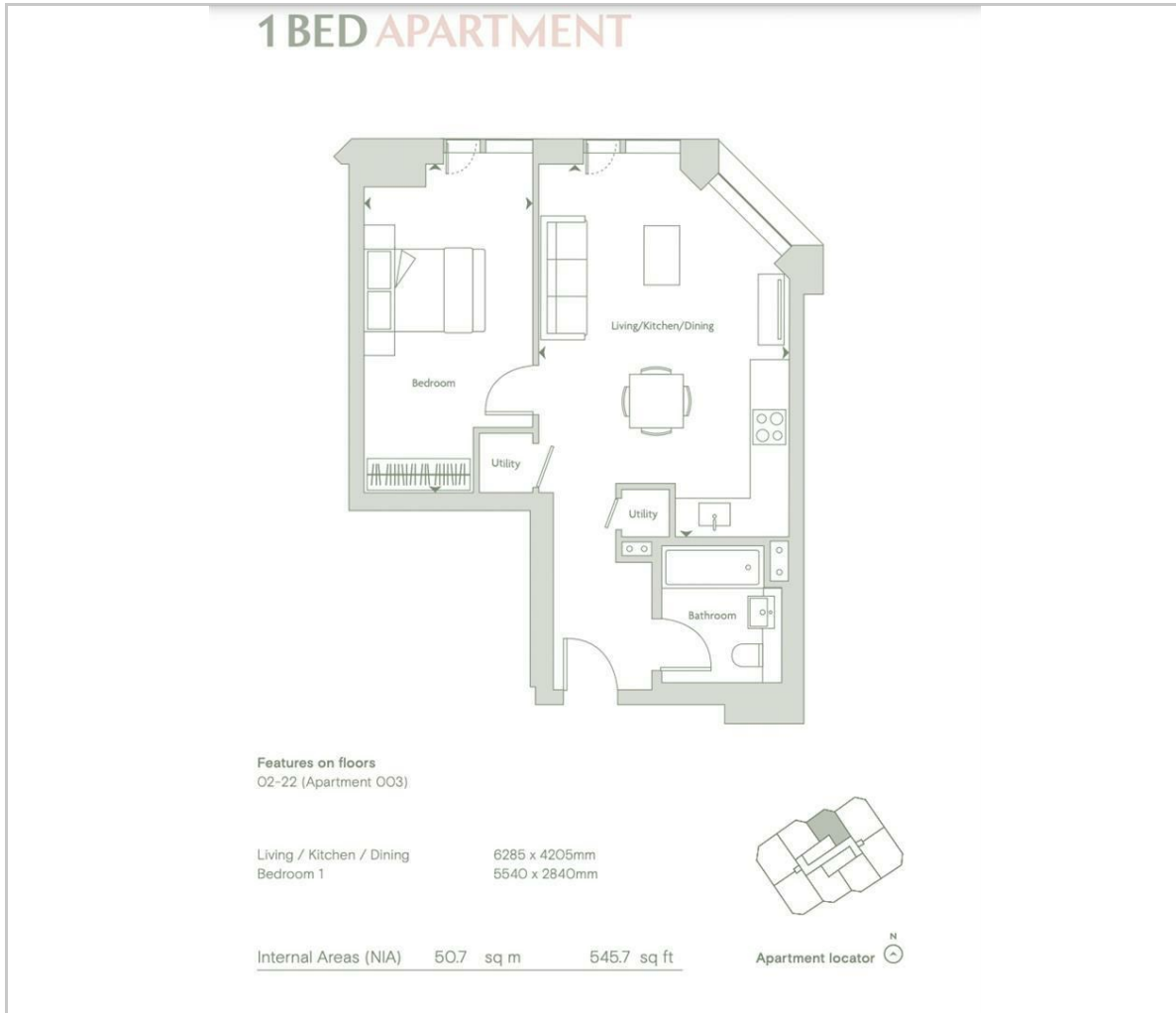

Viewing

Please contact our Manchester Office on 0161 296 8655 if you wish to arrange a viewing appointment for this property or require further information.

These particulars, whilst believed to be accurate are set out as a general outline only for guidance and do not constitute any part of an offer or contract. Intending purchasers should not rely on them as statements of representation of fact, but must satisfy themselves by inspection or otherwise as to their accuracy. No person in this firm's employment has the authority to make or give any representation or warranty in respect of the property.

39 Broughton Street Cheetham Hill, Manchester, Lancashire, M8 8LZ
Tel: 0161 296 8655 Email: manchester@belview.com www.belview.com

Area Map

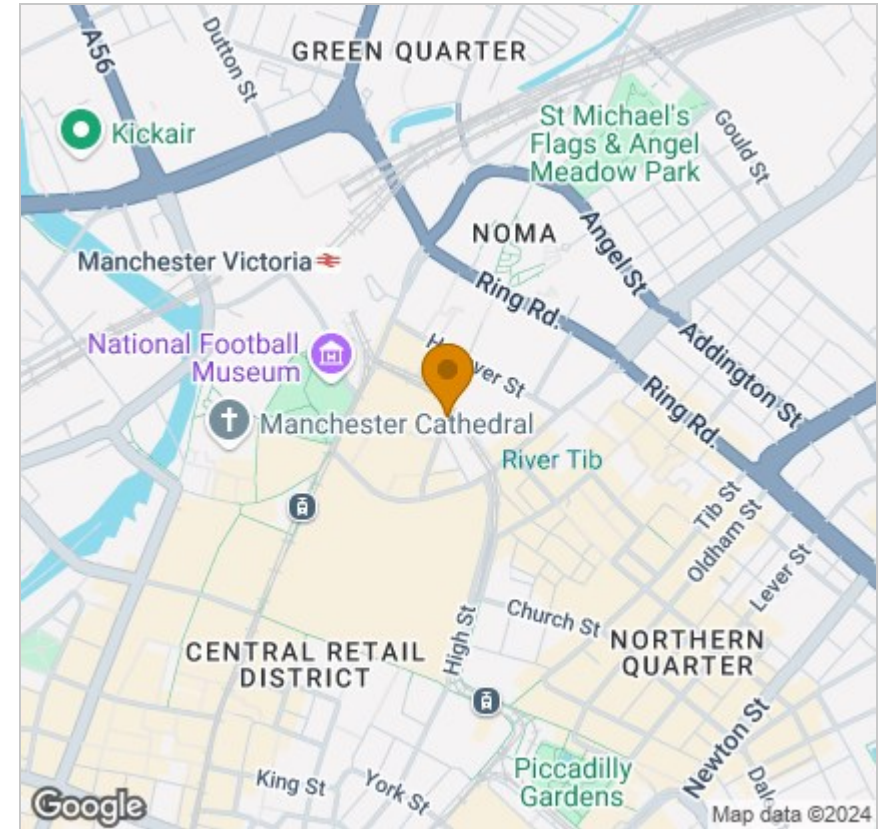

Energy Efficiency Graph

