

# Belview



Victoria Riverside, Park View, TC-08-003 Dantzic Street  
Manchester, M4 2AD

Asking price £267,000



# Victoria Riverside, Park View, TC-08-003 Dantzic Street

Manchester, M4 2AD

Elevated City Living at Victoria Riverside

Park View, a 26-storey development, offers breathtaking views of City River Park and Manchester's skyline. Part of a £1 billion regeneration project, it promises to reshape the area.

## Property Details:

Completion: Q1 2025

Tenure: 250 years

Ground Rent: £150 per annum

(reviewed every 25 years)

Service Charge: £1,616.16 per annum

Rental Yield: 7.56% potential

**Modern Apartments:** These light-filled, open-plan apartments feature kitchens, dining areas, and lounges with large windows that frame stunning views. Finished with vinyl plank flooring and a neutral palette, they offer a sleek, contemporary feel.

**Relaxing Bedrooms:** Floor-to-ceiling windows flood the bedrooms with natural light, creating a serene retreat.

**Exceptional Views:** Unique picture-frame windows provide panoramic views of both the city and park.

## Amenities:

Communal gardens

Lobby lounge

Residents' gym

Lounge and dining area

Why Invest? With Manchester property prices forecast to rise 19.7% by 2027





and rents to increase 21.6%, Victoria Riverside is a prime investment.

**Convenient Location:**

Manchester Victoria: 8-minute walk  
Manchester Piccadilly: 8-minute walk  
Manchester Airport: 26 minutes by car  
London Euston: 2 hours 46 minutes by train

**Nearby Attractions:**

Dining: 63 Degrees, Dishoom, Foundation Coffee House  
Shopping: Manchester Fort, Arndale Centre  
Supermarkets: Tesco Metro, Aldi

With the city centre just a short walk away, Victoria Riverside offers urban convenience with park-side tranquillity.

Contact Us Today to Secure This Amazing Apartment!



## Floor Plan

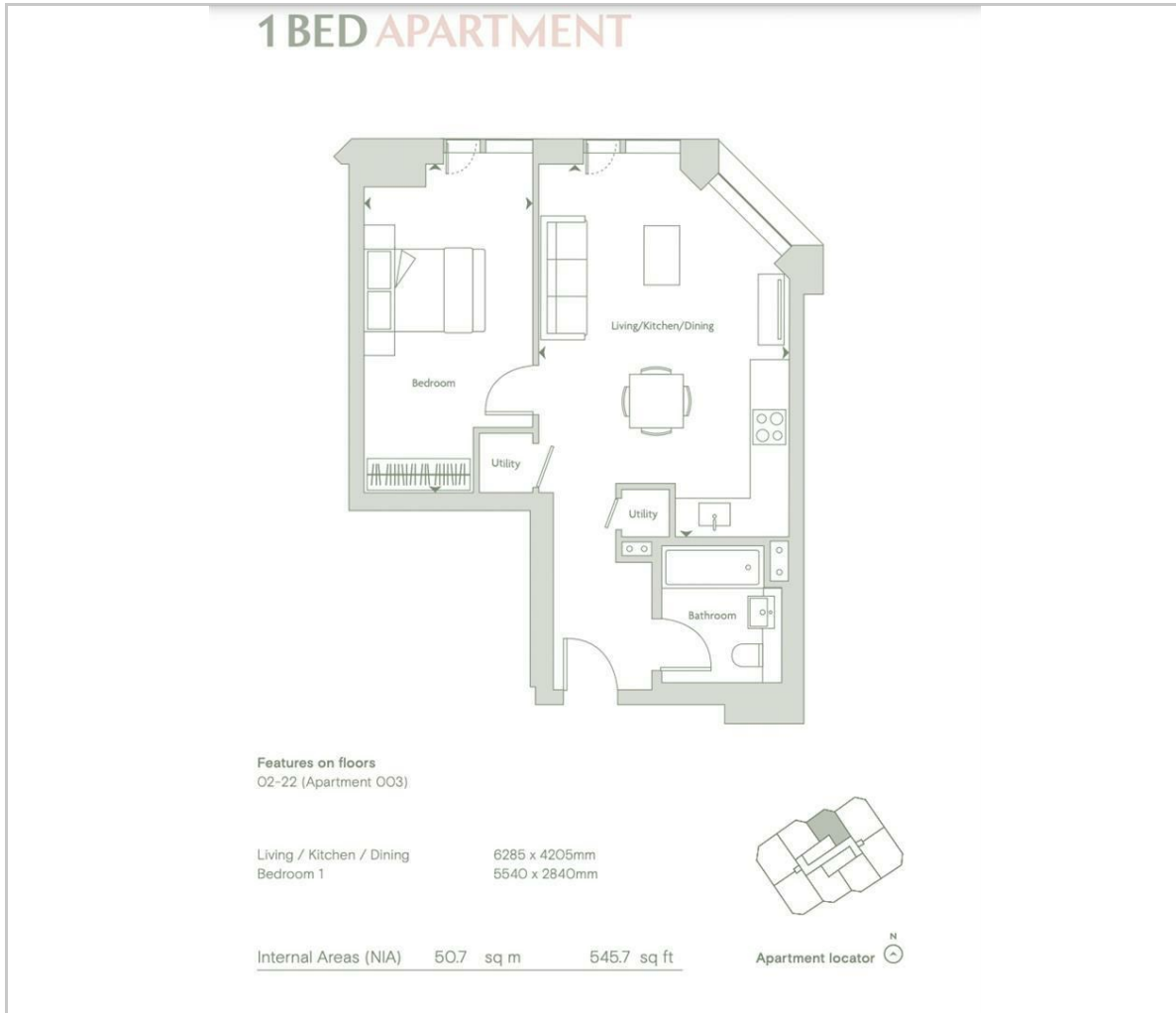

## Viewing

Please contact our Manchester Office on 0161 296 8655 if you wish to arrange a viewing appointment for this property or require further information.

These particulars, whilst believed to be accurate are set out as a general outline only for guidance and do not constitute any part of an offer or contract. Intending purchasers should not rely on them as statements of representation of fact, but must satisfy themselves by inspection or otherwise as to their accuracy. No person in this firm's employment has the authority to make or give any representation or warranty in respect of the property.

39 Broughton Street Cheetham Hill, Manchester, Lancashire, M8 8LZ  
Tel: 0161 296 8655 Email: manchester@belview.com www.belview.com

## Area Map

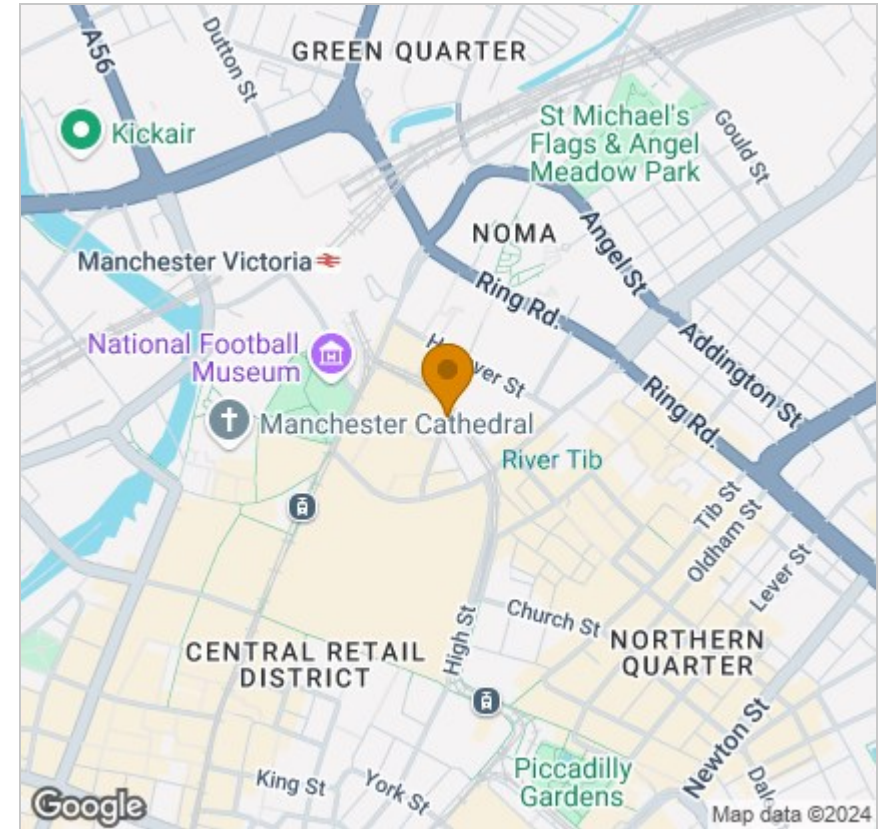

## Energy Efficiency Graph

