



29 Pear Tree Gardens, Market Harborough

Guide Price £215,000



29 Pear Tree Gardens

Market Harborough, Market Harborough

Council Tax band: A

Tenure: Leasehold

EPC Energy Efficiency Rating: D

EPC Environmental Impact Rating:

- Two bedroom Terraced Property Ideal for A First Time Buyer/Investor
- Entrance Hallway
- Kitchen
- Living Dining Room Overlooking The Rear Garden
- Two First Floor Bedrooms
- Family Bathroom
- Car Standing, Established Rear Garden





29 Pear Tree Gardens

Market Harborough, Market Harborough

This well-presented two bedroom terraced house offers an excellent opportunity for first-time buyers or investors seeking a comfortable and conveniently located home. Upon entering, you are welcomed by a spacious entrance hallway that leads through to the kitchen, which is thoughtfully designed to provide ample storage and workspace for all your culinary needs. The generous living dining room is positioned at the rear of the property, creating a bright and inviting space perfect for relaxing or entertaining guests. Upstairs, you will find two well-proportioned bedrooms, both offering plenty of natural light and flexibility for use as sleeping quarters, a home office, or guest accommodation. The family bathroom is appointed and includes modern fixtures and fittings for every-day convenience. Additional benefits of this property include car standing, providing off-road parking for residents or visitors, and an established rear garden (ideal for those who enjoy outdoor living or gardening). The layout of this home has been designed to maximise both space and functionality, making it an attractive option for a variety of lifestyles. Located in a popular residential area, this property is close to local amenities, schools, and transport links, ensuring easy access to everything you need for day-to-day living. With its appealing blend of practical features and comfortable living spaces, this two bedroom terraced house represents a fantastic opportunity for those looking to take their first step onto the property ladder or add to their investment portfolio. Early viewing is highly recommended to appreciate all that this delightful home has to offer.





Ground Floor

Approx. 27.1 sq. metres (291.5 sq. feet)

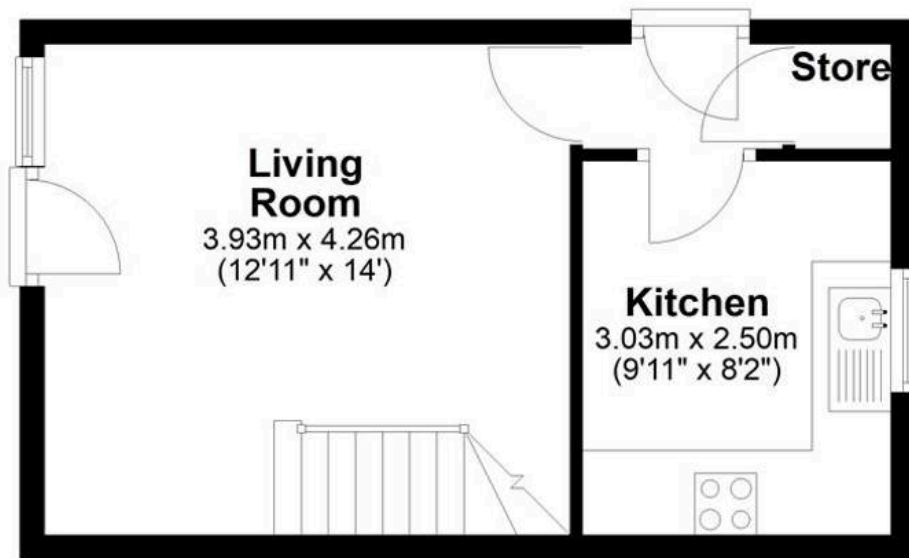

First Floor

Approx. 27.5 sq. metres (295.7 sq. feet)

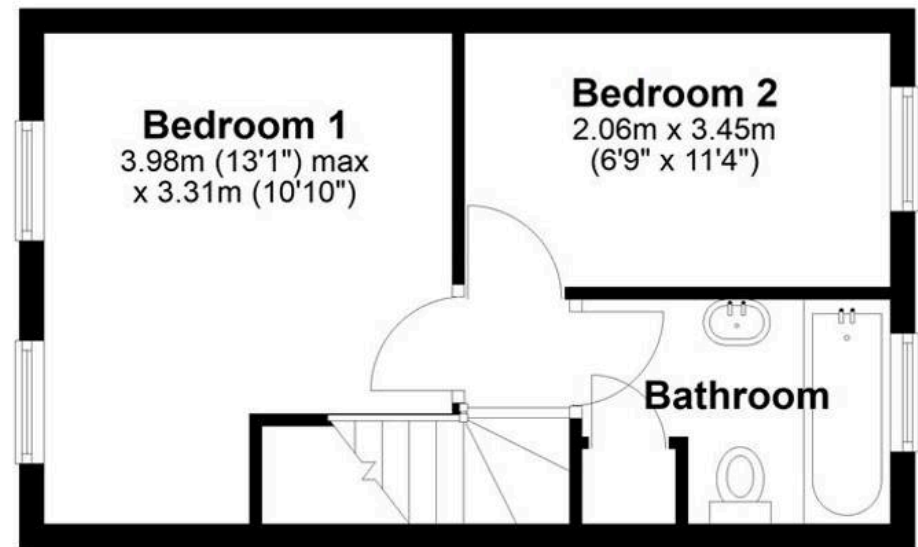

Total area: approx. 54.6 sq. metres (587.2 sq. feet)

All efforts have been made to ensure that the measurements on this floorplan are accurate however these are for guidance purposes only.

Plan produced using PlanUp.



Andrew Granger & Co (Part of Sheldon Bosley Knight)

Andrew Granger & Co, 52 High Street - LE16 7AF

01858431315 • mkt.harboroughsales@sheldonbosleyknight.co.uk • www.sheldonbosleyknight.co.uk/

