



Uppingham Road, Keythorpe, Leicestershire, LE7 9XJ

ANDREW  
GRANGER & CO

Part of  
SHELDON  
BOSLEY  
KNIGHT

LAND AND  
PROPERTY  
PROFESSIONALS



# Property Description

A two bedroomed mid terraced single storey cottage in need of modernisation and improvement enjoying rural views to both the front and rear located on the edge of the highly sought after East Leicestershire village of East Norton.







## Key Features

- Single storey terraced cottage
- Requires modernisation
- Living room with feature fireplace
- Dining kitchen
- 2 bedrooms
- Bathroom/wc
- Electric heating and double glazing
- Front and rear gardens
- Stunning views over fields
- No chain!

**Price Guide**  
**£175,000**

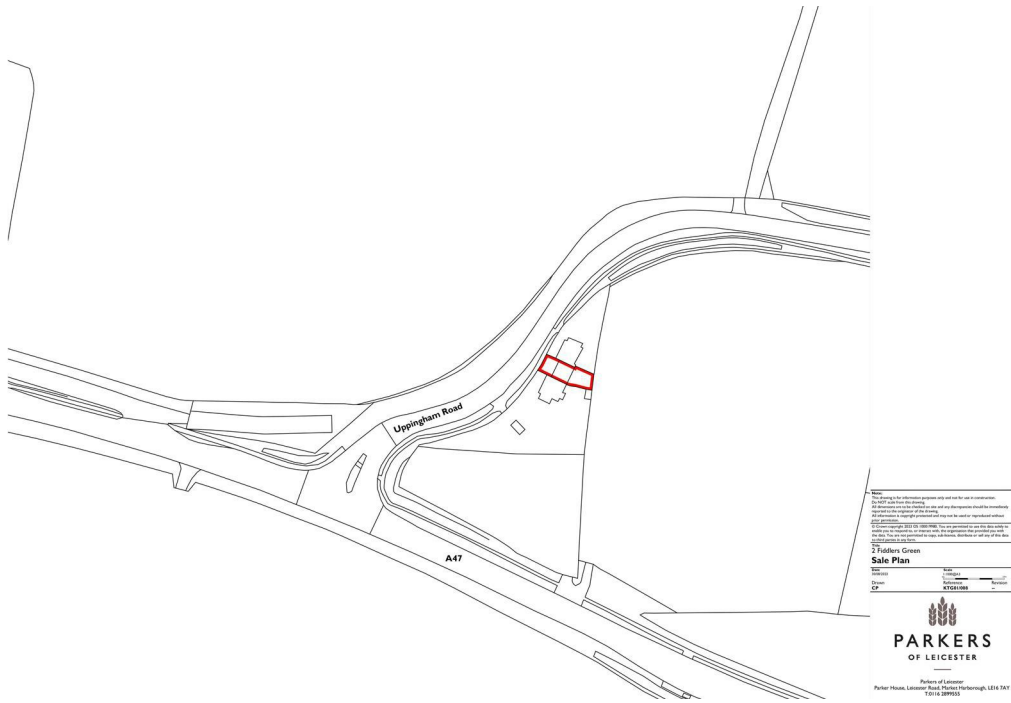



**Approximate Gross Internal Area  
52.4 sq. m. (564 sq. ft.)**

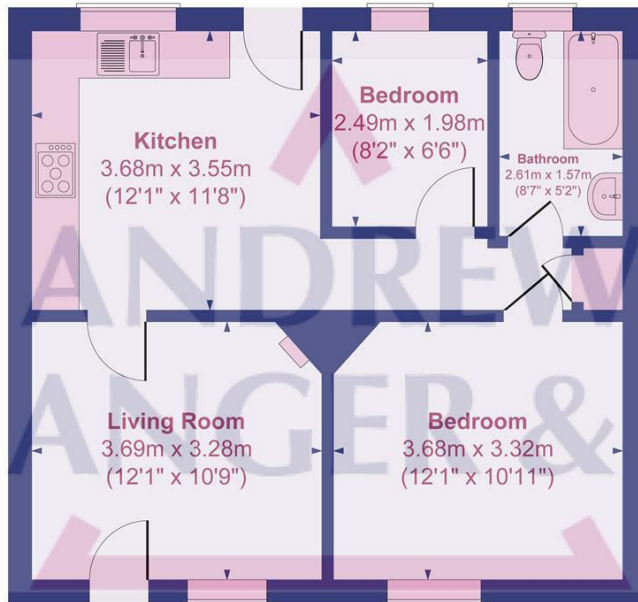

Floor area 52.4 sq.m. (564 sq.ft.) approx

Not to scale for layout reference only. All Measurements are Approximate Produced by As built Energy Surveys for Andrew Granger & Co [orders@asbuillenergysurveys.co.uk](mailto:orders@asbuillenergysurveys.co.uk)



EPC Rating - E

Tenure - Freehold

Council Tax Band - B

Local Authority  
Harborough

We routinely refer clients to both our recommended Legal Firm and a panel of Financial Services Providers. It is your decision whether you choose to deal with these companies. In making that decision, you should know that we receive a referral fee





To view this property please contact our Market Harborough (Sales) office on 01858 431315

Part of  
**ANDREW  
RANGER & CO**

**SHELDON  
BOSLEY  
KNIGHT**

LAND AND  
PROPERTY  
PROFESSIONALS