



Northampton Road, Market Harborough, LE16 9HZ



Part of
**SHELDON
BOSLEY
KNIGHT**
LAND AND
PROPERTY
PROFESSIONALS

Property Description

A ground floor, one bedroom apartment within a superb purpose built retirement complex conveniently located on the edge of the Market Harborough town centre. The accommodation benefits from UPVC double glazing, night storage heating and includes; Entrance hall, lounge/diner, kitchen, bedroom and bathroom, communal gardens and parking. There are communal lounge and kitchen, laundry facilities and a house manager.

Market Harborough has an excellent range of local shops and supermarkets, bars, restaurants, a theatre and leisure centre. The town is well catered for there are mainline rail services to London St Pancras in about an hour, with links to the Eurostar service, and the nearby motorways include the M1 accessible at Junction 20, with the A14 lying to the south.





Key Features

- Retirement Apartment
- Close to Town Centre
- Lounge/Dining Room
- Kitchen With Built In Oven & Hob
- Re Fitted Shower Room
- Communal Lounge
- Gardens
- Car Standing/Visitor Spaces
- No Upward Chain

**Offers Over
£95,000**

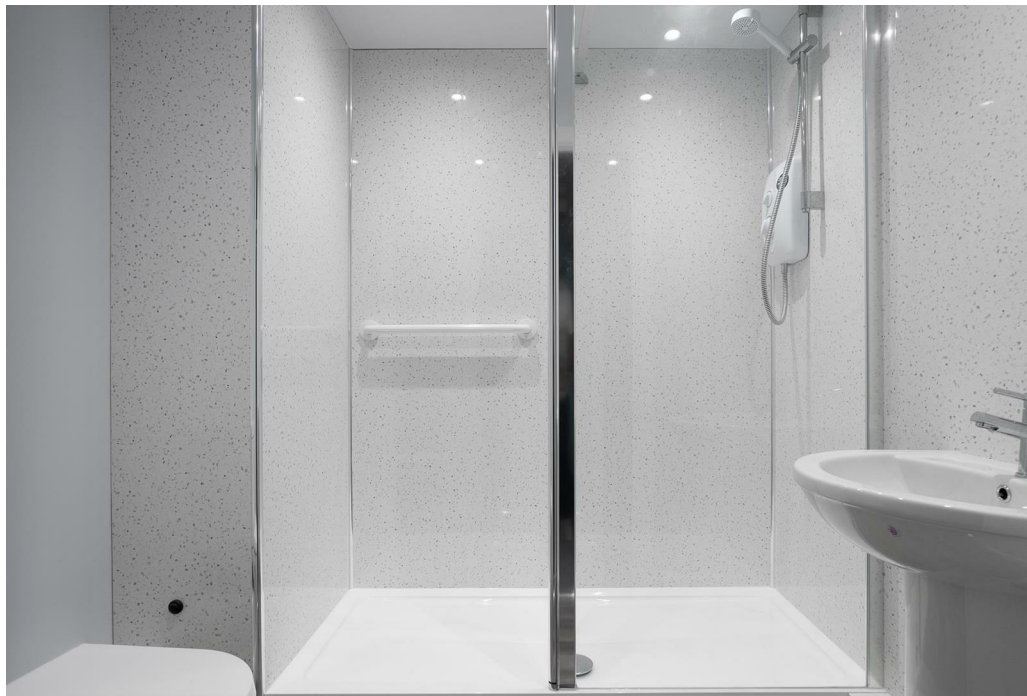

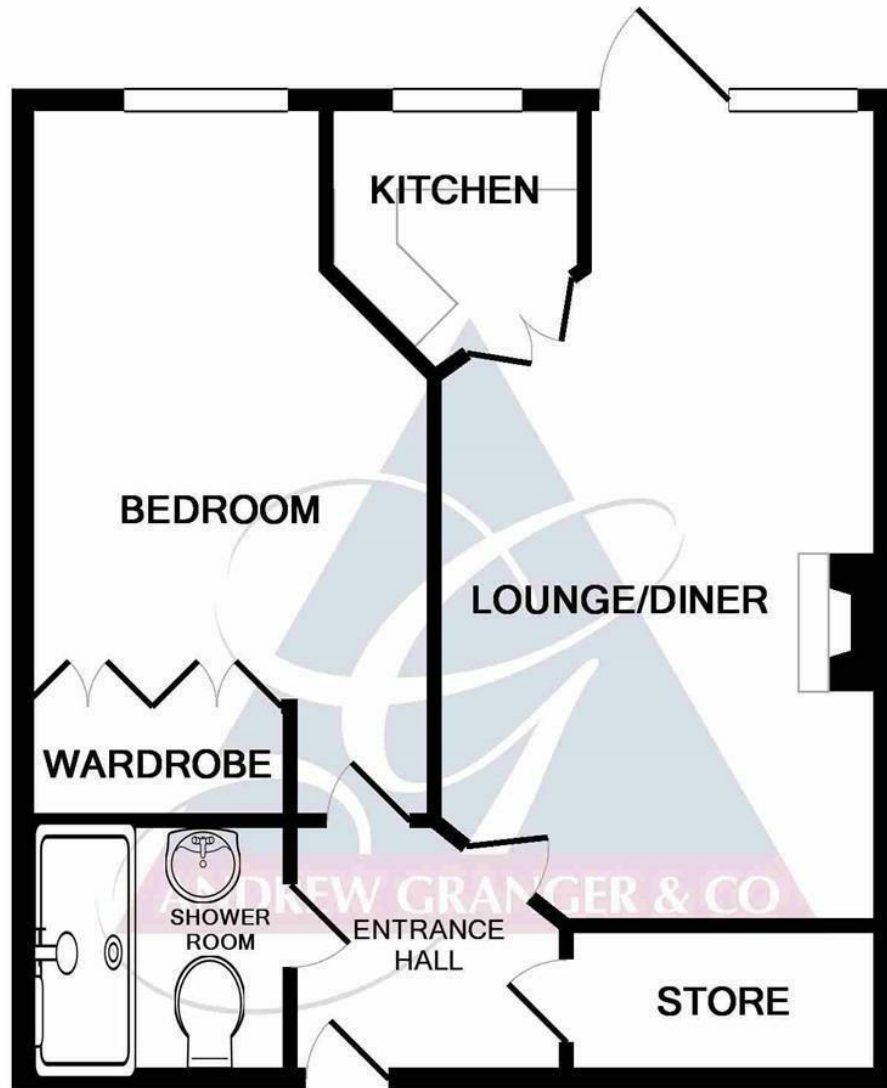

EPC Rating - C

Tenure - Leasehold

Council Tax Band - B

Local Authority
Harborough District Council

TOTAL APPROX. FLOOR AREA 516 SQ.FT. (47.9 SQ.M.)

We routinely refer clients to both our recommended legal companies and a panel of Financial Services Providers. It is your decision whether you choose to deal with these companies. In making that decision, you should know that we receive a referral fee



To view this property please contact our Market Harborough office on 01858 431315



Part of
**SHELDON
BOSLEY
KNIGHT**
LAND AND
PROPERTY
PROFESSIONALS