



Mount Pleasant, Shearsby, LE17 6PH



Part of
**SHELDON
BOSLEY
KNIGHT**
LAND AND
PROPERTY
PROFESSIONALS

Property Description

Occupying an elevated position, this individual three/four bed roomed detached property occupies around 0.16 acres and is believed to date back to circa 1810 with later additions. The property has been extended in recent years and offers flexible living accommodation across two floors and benefits from UPVC double glazing and night storage heating.

The accommodation comprises an entrance hallway with traditional Parquet wood flooring, cloakroom off, lounge with wood burning stove, there is a separate dining area which boasts views over the garden, this in turn gives access to an inner hallway with the study and the sitting room/further bedroom which enjoys direct access to the terrace. From the entrance hallway the well appointed kitchen has a range of base and wall units with built in double oven and hob, with a separate utility room which completes the ground floor offering. To the first floor central landing with three bedrooms and a family bathroom fitted with a three piece white suite. Externally, there is a detached double garage to the front, the extensive garden is set across two levels being well stocked with mature shrubs and trees.





Key Features

- Conservation Village
- Entrance Hallway, Ground Floor Cloakroom
- Lounge/Dining Room
- Kitchen, Utility Room
- Three/Four Bedrooms
- Detached Double Garage
- Extensive Gardens

Price Guide
£615,000



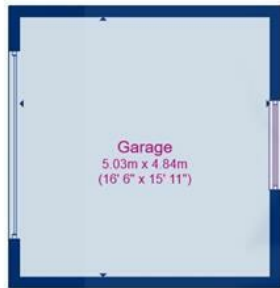
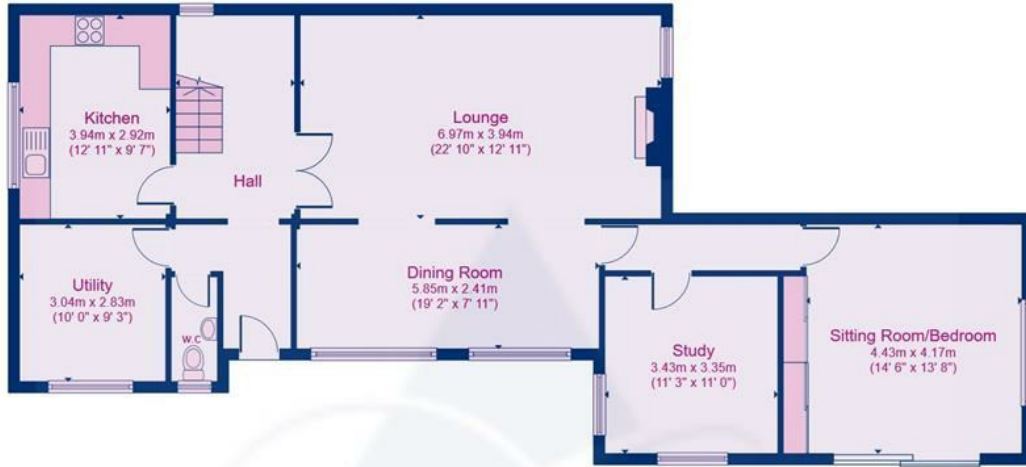

Ground Floor

Floor area 115.4 sq.m. (1,242 sq.ft.) approx (Excluding Garage)



First Floor

Floor area 50.5 sq.m. (544 sq.ft.) approx



EPC Rating - E

Tenure - Freehold

Council Tax Band - E

Local Authority
Harborough District Council

We routinely refer clients to both our recommended Legal Firm and a panel of Financial Services Providers. It is your decision whether you choose to deal with these companies. In making that decision, you should know that we receive a referral fee

Floor plans are for identification purposes only. All measurements are approximate.
Created using Vision Publisher™



To view this property please contact our Market Harborough office on 01858 431315



Part of
**SHELDON
BOSLEY
KNIGHT**
LAND AND
PROPERTY
PROFESSIONALS