



Nutcote, Naseby, NN6 6DG



Part of
**SHELDON
BOSLEY
KNIGHT**
LAND AND
PROPERTY
PROFESSIONALS

Property Description

A well appointed four bedroomed detached family home constructed approximately 16 years ago, situated in this idyllic and much sought after Northamptonshire village. The accommodation briefly comprises of a spacious entrance hallway with cloakroom off, sitting room leading through to a study area, family room and well appointed dining kitchen with built in appliances and a utility room off. To the first floor, the principal bedroom boasts an en-suite shower room, three further bedrooms and a family bathroom. Externally, a five bar gate leads to a car standing area for up to four vehicles, and the rear garden is enclosed and offers a good degree of privacy.

Naseby lies some 14 miles north of Northampton. It is easily accessed from junction 2 of the A14, and lies just 7 miles from Market Harborough which has direct rail access to London St Pancras. Naseby has a village pub, The Royal Oak, a reputable primary school and popular village shop.





Key Features

- Modern Family Home
- Four Bedrooms, Two Bathrooms
- Lounge with Additional Study/ Seating Area
- Family Room
- Well appointed Dining Kitchen with built in appliances
- Cloakroom, Utility Room
- Principle Bedroom with En-Suite
- Family Bathroom
- Village Location

£500,000





Ground Floor

Floor area 81.5 sq.m. (877 sq.ft.) approx

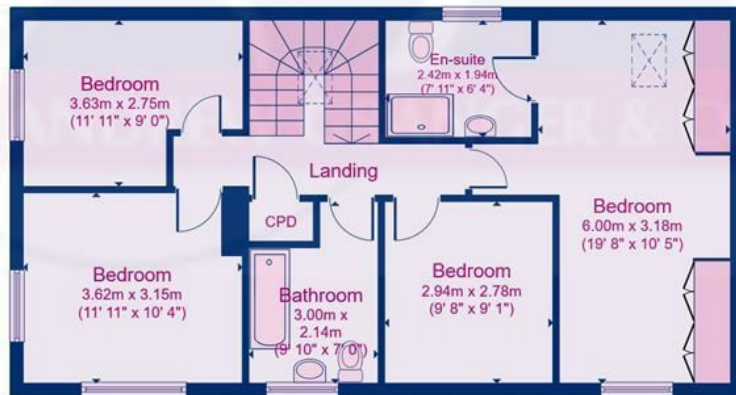

First Floor

Floor area 70.0 sq.m. (753 sq.ft.) approx

Floor plans are for identification purposes only. All measurements are approximate.
Created using Vision Publisher™



EPC Rating - D

Tenure - Freehold

Council Tax Band - F

Local Authority
Daventry



To view this property please contact our Market Harborough office on 01858 431315



Part of
**SHELDON
BOSLEY
KNIGHT**
LAND AND
PROPERTY
PROFESSIONALS