



Fount Court, Market Harborough, LE16 9GF



Part of
**SHELDON
BOSLEY
KNIGHT**
LAND AND
PROPERTY
PROFESSIONALS

Property Description

A modern ground floor two bedroom apartment located on the southern side of Market Harborough town centre. The property comprises: entrance hallway, living kitchen area, two bedrooms and two bathrooms. NO UPWARD CHAIN.





Key Features

- Ground Floor Apartment
- Open Plan Lounge/ Kitchen
- 2 Double Bedrooms
- En Suite & Bathroom
- Allocated Parking
- 150 year lease - 133 years remaining
- Annual Ground Rent £235
- Annual Service Charge £1250

£130,000



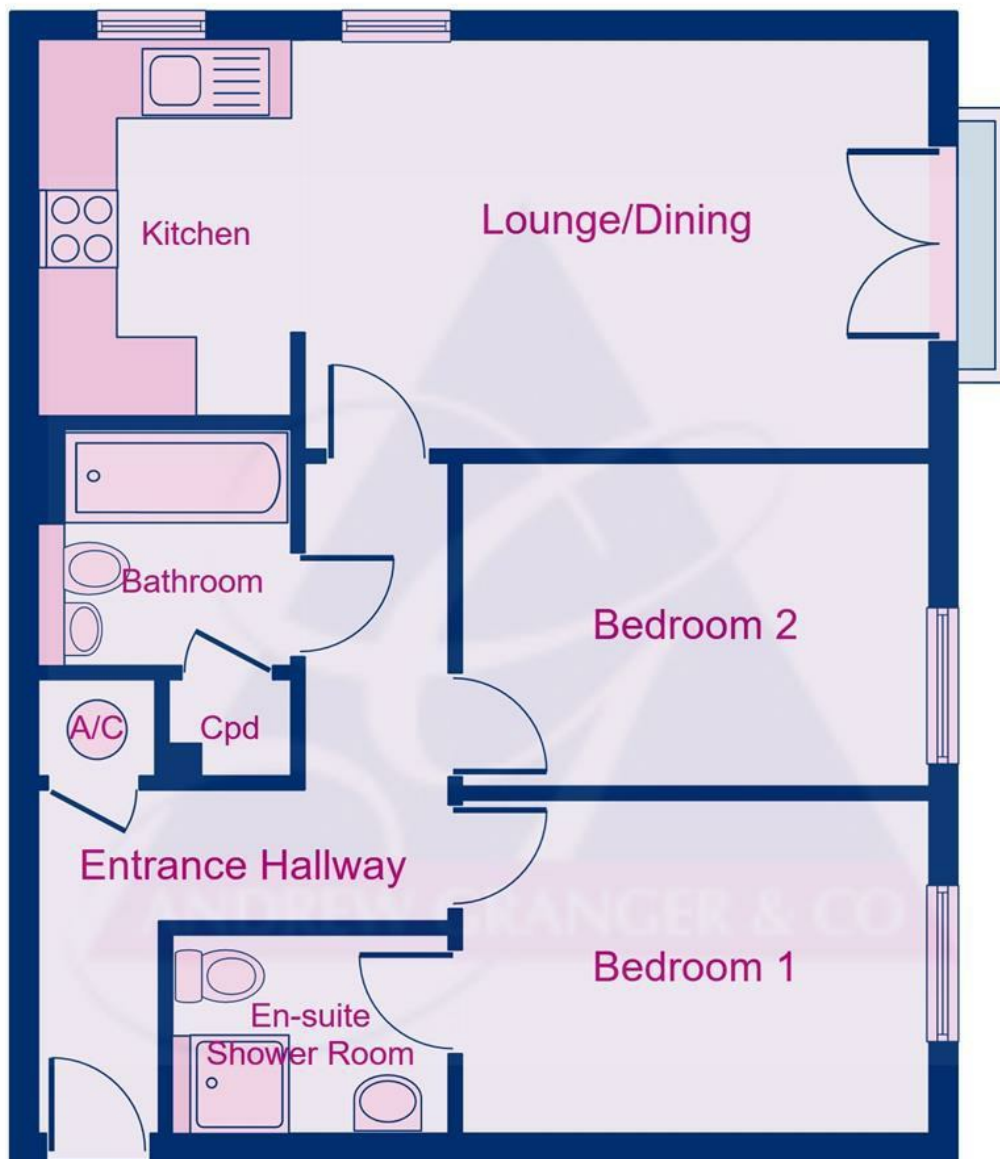

Floor Plan

Floor Area (Gross Internal) 56.0 sq.m. (603 sq.ft.) approx

We routinely refer clients to both our recommended Legal Firm and a panel of Financial Services Providers. It is your decision whether you choose to deal with these companies. In making that decision, you should know that we receive a referral fee

Created using Vision Publisher™



EPC Rating - D

Tenure - Leasehold

Council Tax Band - B

Local Authority
Harborough District Council

To view this property please contact our Market Harborough office on 01858 431315

